

"CONDOMINIUM PLAT AND PLANS"  
OF  
PHASE THIRTY NINE, PARCEL 'D'  
AND  
PHASE FORTY, PARCEL 'C'  
MAINSTAY AT  
"COMMONWEALTH GREEN CONDOMINIUM"  
SECTION ONE - PARCELS 'C' & 'D'

BETHEL MAGISTERIAL DISTRICT  
COUNTY OF YORK, VIRGINIA  
SCALE: 1"=40' DATE: OCTOBER 14, 2022  
SHEET 4 OF 9

DAVIS & ASSOCIATES, P.C.  
LAND SURVEYORS AND PLANNERS  
3630 GEORGE WASHINGTON MEMORIAL HIGHWAY  
YORKTOWN, VIRGINIA 23693  
(757)867-8583

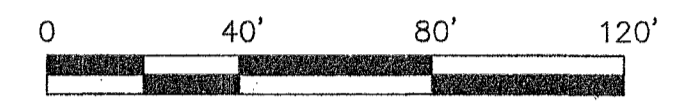

- S Y M B O L S -
- DENOTES IRON PIPE FOUND
  - DENOTES IRON ROD FOUND
  - DENOTES IRON ROD TO BE SET AT ALL PROPERTY LINE JUNCTURES
  - DENOTES CONCRETE MONUMENT FOUND
  - DENOTES CONCRETE MONUMENT TO BE SET
  - DENOTES JURISDICTIONAL WETLANDS MARKED BY WOLFE ENVIRONMENTAL & ENGINEERING CONSULTANTS AND FIELD LOCATED BY DAVIS AND ASSOCIATES, P.C. ON DECEMBER 30, 2005 USCOE PROJECT # 05-R2629 USCOE PROJECT # 95-5485
  - DENOTES ADDITIONAL AND WITHDRAWABLE LAND "A"

BASIS: D.B.361 PG.769

NOW OR FORMERLY  
JEANETTE J. KEENER, TRUSTEE  
GPIN: S02a-2108-4966  
TAX MAP # 36-00-00-022  
INST. # 050008026  
ZONE: EO / PD

'COMMON AREA 'C'  
INST. # 200004253  
ZONE: EO / PD  
GPIN: S02a-2450-4789  
TAX MAP # 36C-00-02-000C

'PARCEL E'  
SUBDIVISION PLAT OF  
MAINSTAY AT COMMONWEALTH GREEN  
SECTION TWO  
INST. # 200004253  
ZONE: PDMU WITH PROFFERS  
GPIN: S02a-2195-3879  
TAX MAP # 36-01-00-000A

NOW OR FORMERLY  
HARMON J. COXTON & WYNEMA S. COXTON  
GPIN: S02b-3095-4278  
TAX MAP # 37-27-00-003  
INST. # 050008332  
ZONE: EO

'PARCEL F'  
SUBDIVISION PLAT OF  
MAINSTAY AT COMMONWEALTH GREEN  
SECTION TWO  
INST. # 200004253  
ZONE: PD/EO  
GPIN: S02a-2314-4523  
TAX MAP # 36-01-00-000A4

'COMMON AREA B'  
SUBDIVISION PLAT OF  
NEW PARCEL ONE  
INST. # 170019369  
ZONE: PDMU WITH PROFFERS  
GPIN: S02a-2177-4294  
TAX MAP # 36-01-00-001B

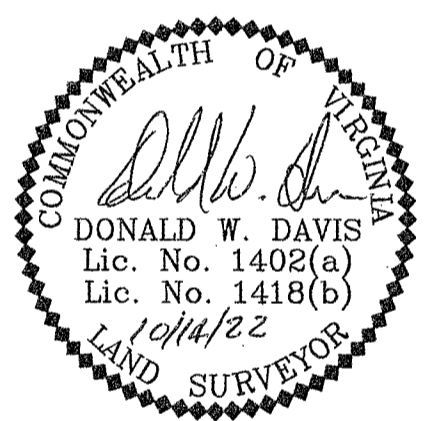

APPROVED  
YORK COUNTY BOARD OF SUPERVISORS  
BY: Erin Kassel  
PLAT APPROVING AGENT  
DATE: FEBRUARY 22, 2023

STATE OF VIRGINIA  
COUNTY OF YORK  
IN THE CLERK'S OFFICE OF THE YORK -  
POQUOSON CIRCUIT COURT THIS 23rd  
DAY OF February 2023 THIS MAP WAS  
PRESENTED AND ADMITTED TO RECORD AS  
THE LAW DIRECTS AS INSTRUMENT # 230002641

TESTE: KRISTEN N. NELSON, CLERK  
CLERK  
BY: Maikene Helbert, DC