

PHASE FORTY ONE -- BUILDING THIRTY EIGHT DETAIL (UNITS 81 & 82)

DIMENSIONS REFLECT INTERIOR FRAME LINE

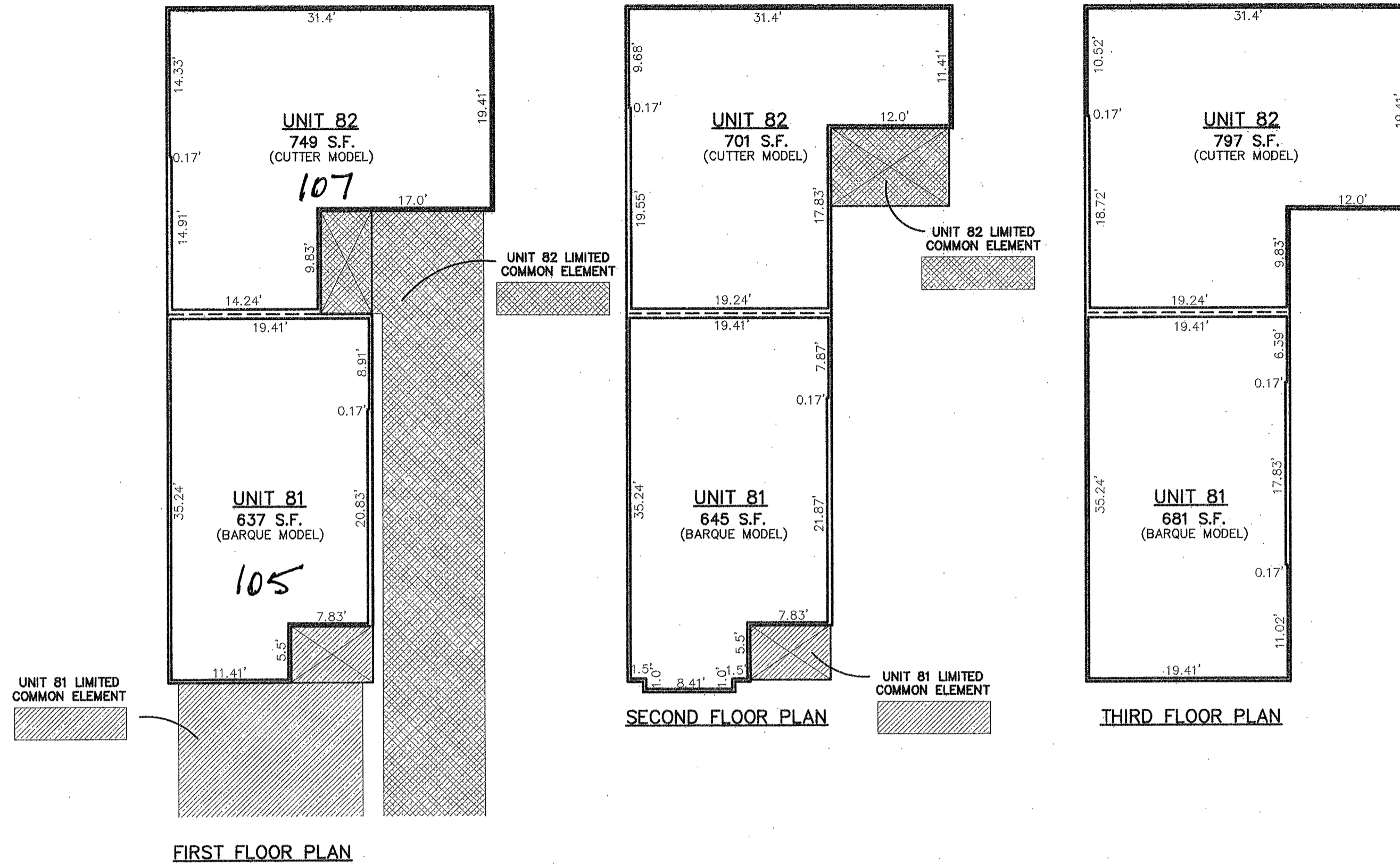

"CONDOMINIUM PLAT AND PLANS"
OF
PHASE FORTY ONE, PARCEL 'C'
MAINSTAY AT
"COMMONWEALTH GREEN CONDOMINIUM"
SECTION ONE - PARCEL 'C'

BETHEL MAGISTERIAL DISTRICT
COUNTY OF YORK, VIRGINIA
SCALE: 1"=10' DATE: MARCH 03, 2023
SHEET 6 OF 7

DAVIS & ASSOCIATES, P.C.
LAND SURVEYORS AND PLANNERS
3630 GEORGE WASHINGTON MEMORIAL HIGHWAY
YORKTOWN, VIRGINIA 23693
(757)867-8583

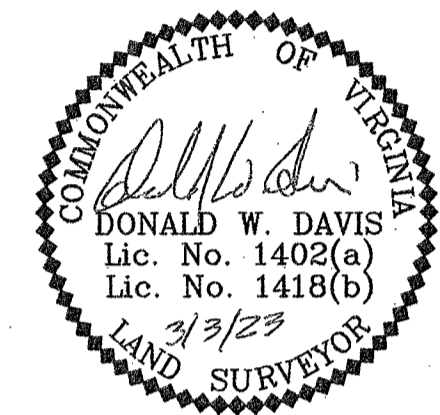

- SYMBOLS -

- DENOTES LIMITED COMMON ELEMENT - UNIT 81
- DENOTES LIMITED COMMON ELEMENT - UNIT 82

NOTE: LIMITED COMMON ELEMENT AREAS
DEPICTED HEREON DO NOT BELONG TO TWO
UNITS JOINTLY.

A P P R O V E D
YORK COUNTY BOARD OF SUPERVISORS

BY: *Susan Kassel* FOR SUSAN KASSEL
PLAT APPROVING AGENT

DATE: 4/7/23

STATE OF VIRGINIA
COUNTY OF YORK
IN THE CLERK'S OFFICE OF THE YORK -
POQUOSON CIRCUIT COURT THIS 7th
DAY OF April 2023 THIS MAP WAS
PRESENTED AND ADMITTED TO RECORD AS
THE LAW DIRECTS AS INSTRUMENT # 230004727

TESTE: KRISTEN N. NELSON, CLERK
CLERK

BY: *Waelone Little*