

BASIS: D.B.361 PG.759

'PARCEL D'
SUBDIVISION PLAT OF
MAINSTAY AT COMMONWEALTH GREEN
SECTION ONE
INST.# 170020100
ZONE: PDMU WITH PROFFERS
GPIN: S03c-1292-0050
TAX MAP #: 36C-01-00-0000

NOW OR FORMERLY
JEANETTE J. KEENER, TRUSTEE
GPIN: S02a-2108-4966
TAX MAP # 36-00-00-022
INST. # 050008026
ZONE: EO / PD

"CONDOMINIUM PLAT AND PLANS"
OF
**PHASE FORTY THREE
AND
PHASE FORTY FOUR**
MAINSTAY AT
"COMMONWEALTH GREEN CONDOMINIUM"
SECTION ONE - PARCEL 'C'
BETHEL MAGISTERIAL DISTRICT
COUNTY OF YORK, VIRGINIA
SCALE: 1" = 40' DATE: MAY 26, 2023
SHEET 2 OF 7

DAVIS & ASSOCIATES, P.C.
LAND SURVEYORS AND PLANNERS
3630 GEORGE WASHINGTON MEMORIAL HIGHWAY
YORKTOWN, VIRGINIA 23693
(757) 867-8583

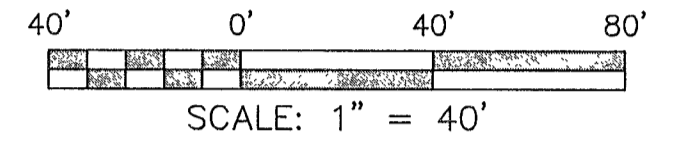

- S Y M B O L S —
- DENOTES IRON PIPE FOUND
 - DENOTES IRON ROD FOUND
 - DENOTES IRON ROD TO BE SET AT ALL PROPERTY LINE JUNCTURES
 - DENOTES CONCRETE MONUMENT FOUND
 - DENOTES CONCRETE MONUMENT TO BE SET

- DENOTES JURISDICTIONAL WETLANDS MARKED BY WOLFE ENVIRONMENTAL & ENGINEERING CONSULTANTS AND FIELD LOCATED BY DAVIS AND ASSOCIATES, P.C. ON DECEMBER 30, 2005 USCOE PROJECT # 05-R2629 USCOE PROJECT # 95-5485
- DENOTES ADDITIONAL AND WITHDRAWABLE LAND "A"

'PARCEL C'
SUBDIVISION PLAT OF
MAINSTAY AT COMMONWEALTH GREEN
SECTION ONE
INST.# 170020100
ZONE: PDMU WITH PROFFERS
GPIN: S02a-1220-4864
TAX MAP #: 36C-01-00-000C

'PARCEL ONE-B'
SUBDIVISION PLAT OF
NEW PARCEL ONE
INST.# 170019369
ZONE: PDMU WITH PROFFERS
GPIN: S02a-1120-4700
TAX MAP #: 36-01-00-000A2

COMMON AREA 'C'
SUBDIVISION PLAT OF
VILLAGE ON THE GREEN
SECTION 1
INST.# 220008996
ZONE: PDMU WITH PROFFERS
GPIN: S02a-1453-4469
TAX MAP #: LOT CAC

PARCEL ONE-C1
SUBDIVISION PLAT OF
VILLAGE ON THE GREEN
SECTION 1
INST.# 220008996
ZONE: PDMU WITH PROFFERS
GPIN: S02a-1527-4452
TAX MAP #: 36-01-00-000A3

COMMON AREA 'B'
SUBDIVISION PLAT OF
NEW PARCEL ONE
INST.# 170019369
ZONE: PDMU WITH PROFFERS
GPIN: S02a-2177-4294
TAX MAP #: 36-01-00-001B

'PARCEL A-1'
PROPERTY LINE VACATION PLAT OF
MAINSTAY AT COMMONWEALTH GREEN
SECTION ONE
INST.# 190004472
ZONE: PDMU WITH PROFFERS
GPIN: S02a-1568-4684
TAX MAP #: 36C-01-00-000A

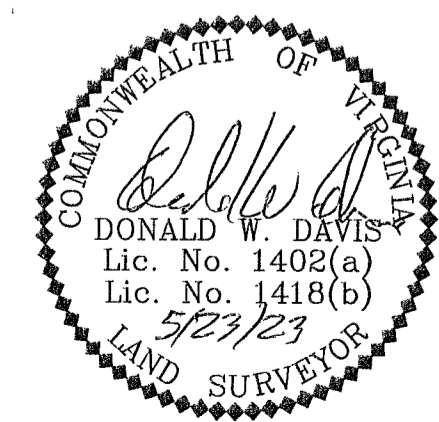
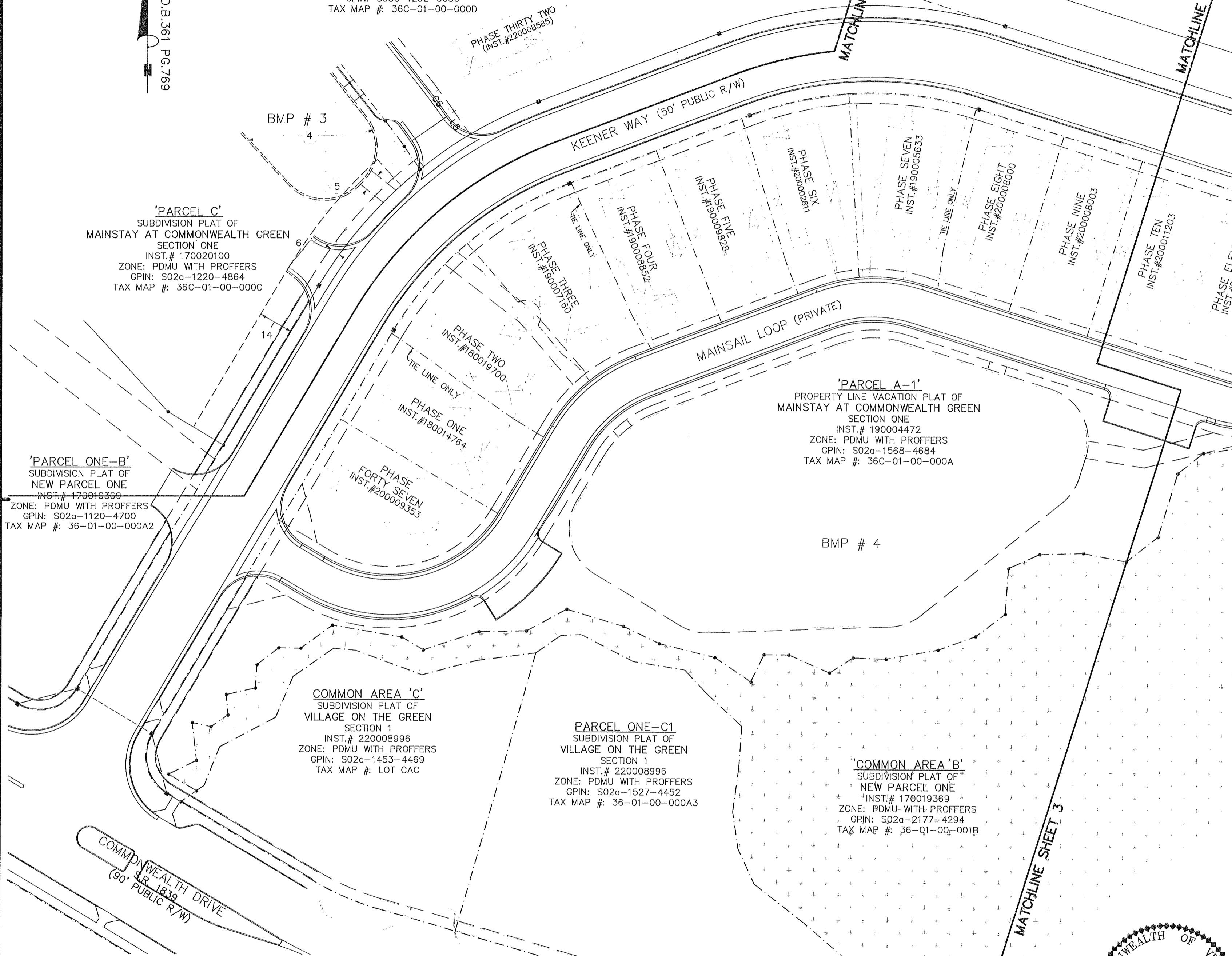

APPROVED
YORK COUNTY BOARD OF SUPERVISORS

BY: Susan Kassel
PLAT APPROVING AGENT

DATE: JULY 12, 2023

STATE OF VIRGINIA
COUNTY OF YORK
IN THE CLERK'S OFFICE OF THE YORK,
POQUOSON CIRCUIT COURT THIS 12th
DAY OF JULY, 2023, THIS MAP WAS
PRESENTED AND ADMITTED TO RECORD AS
THE LAW DIRECTS AS INSTRUMENT # 230010043

TESTE: KRISTEN N. NELSON, CLERK
BY: Lauren M. Hart, ac