

++ + + + DENOTES BMP CONSERVATION AREA  
 "BMP CONSERVATION AREAS" SHALL REMAIN IN A NATURAL VEGETATED STATE ("BMP CONSERVATION AREAS" CAN BE BUSH HOGGED NO MORE THAN FOUR (4) TIMES PER YEAR)

NOW OR FORMERLY STEVEN E. MOORE, ET UX  
 MAP #30-00-00-232  
 GPIN U05d-4547-1037  
 D.B. 570, PG. 278  
 ZONE: RR

NOW OR FORMERLY JOHN J. & JANICE E. RYAN  
 MAP #30E-09-00-012  
 GPIN U05d-4683-0738  
 INSTR.# 170007329  
 ZONE: RR

NOW OR FORMERLY SARA DEANE FERGUSON MILLS  
 MAP #30-00-00-227A  
 GPIN V05c-0141-1148  
 INSTR.# 020002268  
 ZONE: RR

NOW OR FORMERLY HENRY L. HILL ETUX  
 MAP #30E-09-00-011  
 GPIN U05d-4776-0508  
 INSTR.# 0900030312  
 ZONE: RR

NOW OR FORMERLY WILLIAM LEE BARBER, JR. ET UX  
 MAP #31-00-00-021  
 GPIN V05c-0180-0857  
 INSTR.# 050003587  
 ZONE: RR

NOW OR FORMERLY MALLORY FALLON FEEBLES ET ALS  
 MAP #31-00-00-022A  
 GPIN V05c-0320-0824  
 INSTR.# 190000317  
 ZONE: RR

APPROVED  
 YORK COUNTY BOARD OF SUPERVISORS  
 BY: *Eileen Kassel*  
 PLAT APPROVING AGENT  
 DATE: JULY 11, 2023

STATE OF VIRGINIA  
 COUNTY OF YORK  
 IN THE CLERK'S OFFICE OF THE CIRCUIT COURT FOR THE COUNTY OF YORK-POQUOSON, ON THIS 12<sup>th</sup> DAY OF July, 2023  
 THIS MAP WAS PRESENTED AND ADMITTED TO RECORD AS THE LAW DIRECTS, AS INSTRUMENT NUMBER 230010045

TESTE: KRISTEN N. NELSON, CLERK  
 CLERK  
 BY: *Dalene M. Holt, ce*

CURVE DATA

CURVE #	RADIUS	LENGTH	DELTA	TANGENT	CHORD
C1	300.00'	268.73'	51°19'28"	144.14'	S83°55'37"E 259.84'
C5	250.00'	223.95'	51°19'28"	120.11'	N83°55'37"W 216.53'

- LEGEND**
- IRON PIN FOUND (UNLESS OTHERWISE NOTED)
  - #5 IRON REBAR SET (UNLESS OTHERWISE NOTED)
  - #5 IRON REBAR SET IN CONCRETE

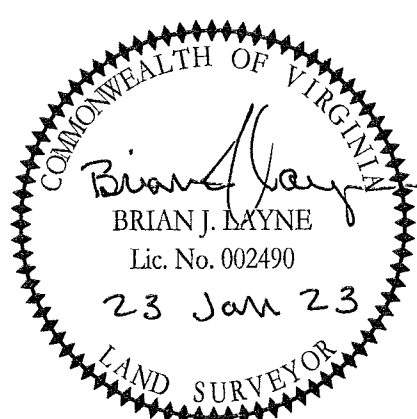
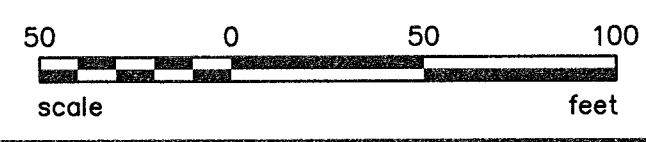

PLAT OF CORRECTION  
 INSTRUMENT NO. 190019505  
 SUBDIVISION PLAT OF  
**BUNTING POINT PHASE 2**  
 BETHEL DISTRICT, YORK COUNTY, VIRGINIA

DRAWN: DHW DATE: 1/23/23 REVISION:  
 COMP: BJL SCALE: 1"=50'  
 CHECKED: BJL

**PARRISH LAYNE**  
 DESIGN GROUP  
 Engineers • Surveyors • Planners  
 P.O. Box 9164, Chesapeake, VA 23321  
 Phone: 757.686.3345 Fax: 757.686.3348

REF: INST# 170014092 SHEET NO. **4**  
 SHEET: 4 of 6