

"CONDOMINIUM PLAT AND PLANS"
OF
PHASE FORTY FIVE
AND
PHASE FORTY SIX

MAINSTAY AT
"COMMONWEALTH GREEN CONDOMINIUM"
SECTION ONE - PARCEL 'C'
BETHEL MAGISTERIAL DISTRICT
COUNTY OF YORK, VIRGINIA
SCALE: 1" = 10' DATE: JULY 25, 2023
SHEET 8 OF 9

DAVIS & ASSOCIATES, P.C.
LAND SURVEYORS AND PLANNERS
3630 GEORGE WASHINGTON MEMORIAL HIGHWAY
YORKTOWN, VIRGINIA 23693
(757) 867-8583

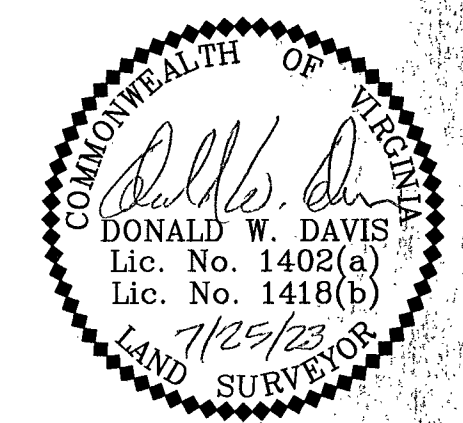
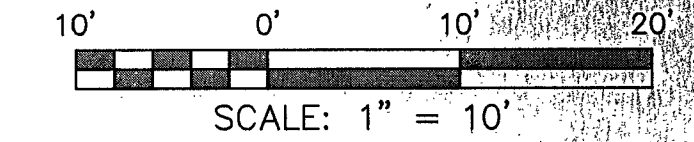

PHASE FORTY SIX - BUILDING THIRTY THREE DETAIL (UNITS 91 & 92)

DIMENSIONS REFLECT INTERIOR FRAME LINE

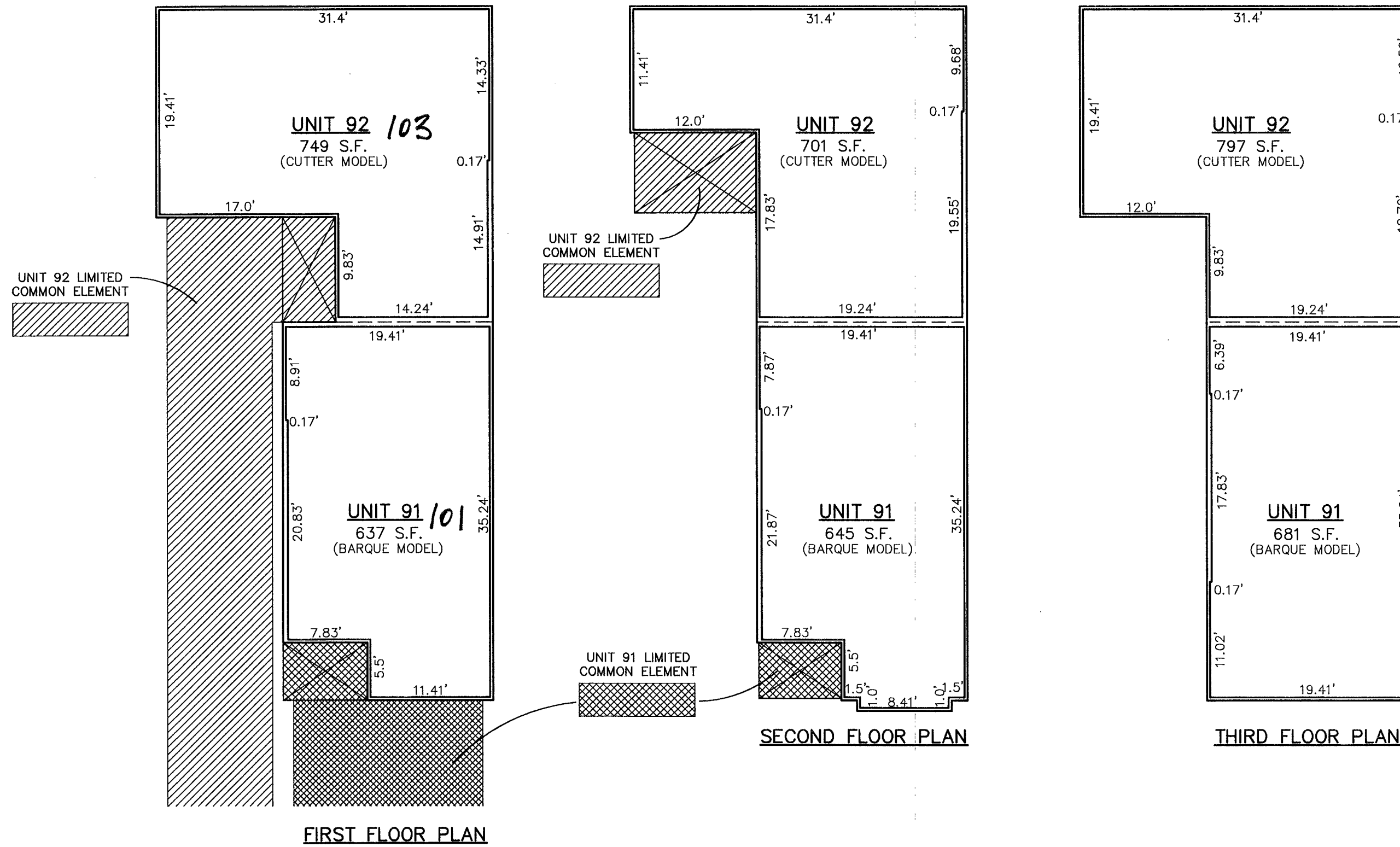

- S Y M B O L S -
- DENOTES LIMITED COMMON ELEMENT - UNIT 91
 - DENOTES LIMITED COMMON ELEMENT - UNIT 92

NOTE: LIMITED COMMON ELEMENT AREAS DEPICTED HEREON DO NOT BELONG TO TWO UNITS JOINTLY.

A P P R O V E D
YORK COUNTY BOARD OF SUPERVISORS

BY: *[Signature]* For SUSAN KASSEL
PLAT APPROVING AGENT

DATE: 9/11/23

STATE OF VIRGINIA
COUNTY OF YORK
IN THE CLERK'S OFFICE OF THE YORK -
POQUOSON CIRCUIT COURT THIS 11th
DAY OF Sept 2023, THIS MAP WAS
PRESENTED AND ADMITTED TO RECORD AS
THE LAW DIRECTS AS INSTRUMENT # 230014102

TESTE: KRISTEN N. NELSON, CLERK
CLERK

BY: *[Signature]*