

PROJECT MANAGER Kenay Wynne, PE (757) 494-5479 (Hampton Roads District)  
 SURVEYED BY DATE R. Dean Minix, LS (757) 925-2660 (Hampton Roads District)  
 DESIGN BY Clark Nasson, Virginia Beach, VA (757) 455-5800  
 SUBSURFACE UTILITY BY DATE Howard A. Spence, LS (Hampton Roads District)

| REVISED    | STATE | ROUTE | PROJECT              | SHEET NO. |
|------------|-------|-------|----------------------|-----------|
| 04/14/2017 | VA.   | 172   | 0172-147-V05, RW-201 | 16        |
| 05/10/2017 |       |       | C-501                |           |
| 06/06/2017 |       |       |                      |           |
| 06/14/2017 |       |       |                      |           |
| 06/29/2017 |       |       |                      |           |
| 07/19/2017 |       |       |                      |           |

THESE PLANS ARE UNFINISHED  
 AND ARE NOT TO BE USED FOR  
 ANY TYPE OF CONSTRUCTION.

DESIGN FEATURES RELATING TO CONSTRUCTION  
 OR TO REGULATION AND CONTROL OF TRAFFIC  
 MAY BE SUBJECT TO CHANGE AS DEEMED  
 NECESSARY BY THE DEPARTMENT

**LEGEND**

- Denotes Saw Cut
- △ 1 S'd.CG-6 Req'd.
- △ 2 S'd.Rad.CG-6 Req'd.
- △ 3 S'd.CG-2 Req'd.
- △ 4 S'd.Rad.CG-2 Req'd.
- △ 5 S'd.CG-9D Req'd.
- △ 6 S'd.CG-II Req'd.
- △ 7 4" Conc.Sidewalk Req'd.
- △ 8 S'd.CG-12 Req'd.(Type A)
- △ 9 S'd.CG-12 Req'd.(Type B)
- ⊠ Denotes Demolition of Pavement
- ⊡ Denotes New Pavement
- ▨ Denotes Proposed 1.5' & Variable Depth Overlay
- C --- Denotes Construction Limits In Cuts
- F --- Denotes Construction Limits In Fills

PLAT INSTRUMENT # 170015636

MATCH LINE STATION 90+50 SEE SHEET 15

MATCH LINE STATION 97+50 SEE SHEET 17

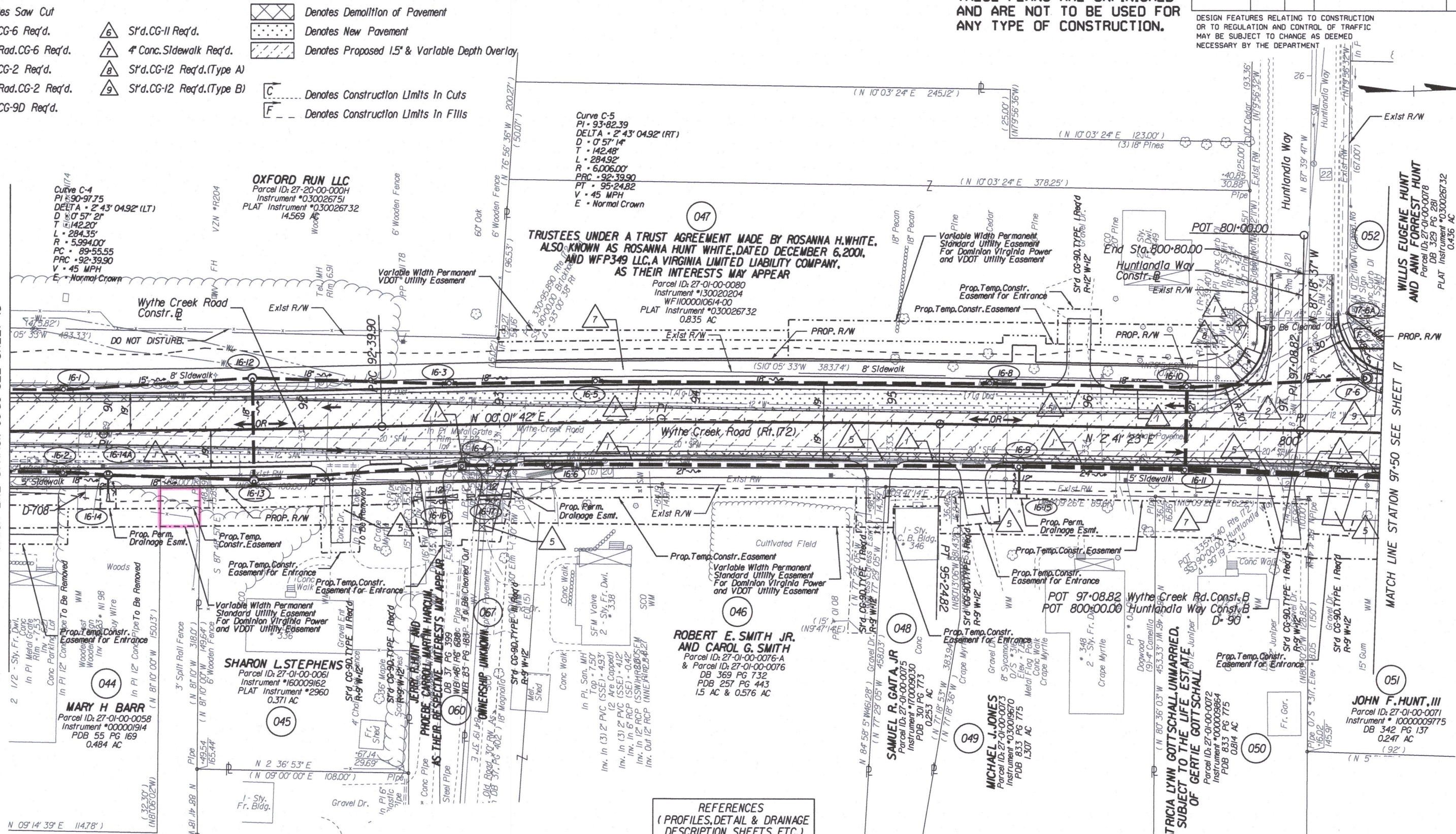

**REFERENCES**  
 (PROFILES, DETAIL & DRAINAGE  
 DESCRIPTION SHEETS, ETC.)

|                         |                |
|-------------------------|----------------|
| Wythe Creek Rd. Profile | 16A            |
| Drainage Descr.         | 7B             |
| Typical Section         | 2C             |
| Huntlandia Way Profile  | 16A(1)         |
| Entrance Profiles       | 18(4)          |
| Maint. of Traffic       | 1J(16, 31, 46) |

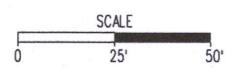

|         |              |           |    |
|---------|--------------|-----------|----|
| PROJECT | 0172-147-V05 | SHEET NO. | 16 |
|---------|--------------|-----------|----|