

PROJECT MANAGER *Kenny Wynne, PE (757) 494-5479 (Hampton Roads District)*  
 SURVEYED BY, DATE *R. Dean Minniz, LS (757) 925-2660 (Hampton Roads District)*  
 DESIGN BY *Clark Nexsen, Virginia Beach VA (757) 455-5800*  
 SUBSURFACE UTILITY BY, DATE *Howard A. Spence, LS (Hampton Roads District)*

REVISED	STATE	ROUTE	PROJECT	SHEET NO.
03/29/2017 04/28/2017 07/19/2017	VA.	172	0172-147-V05, RW-201 C-501	13

THESE PLANS ARE UNFINISHED  
 AND ARE NOT TO BE USED FOR  
 ANY TYPE OF CONSTRUCTION.

DESIGN FEATURES RELATING TO CONSTRUCTION  
 OR TO REGULATION AND CONTROL OF TRAFFIC  
 MAY BE SUBJECT TO CHANGE AS DEEMED  
 NECESSARY BY THE DEPARTMENT

PLAT INSTRUMENT # 170015639

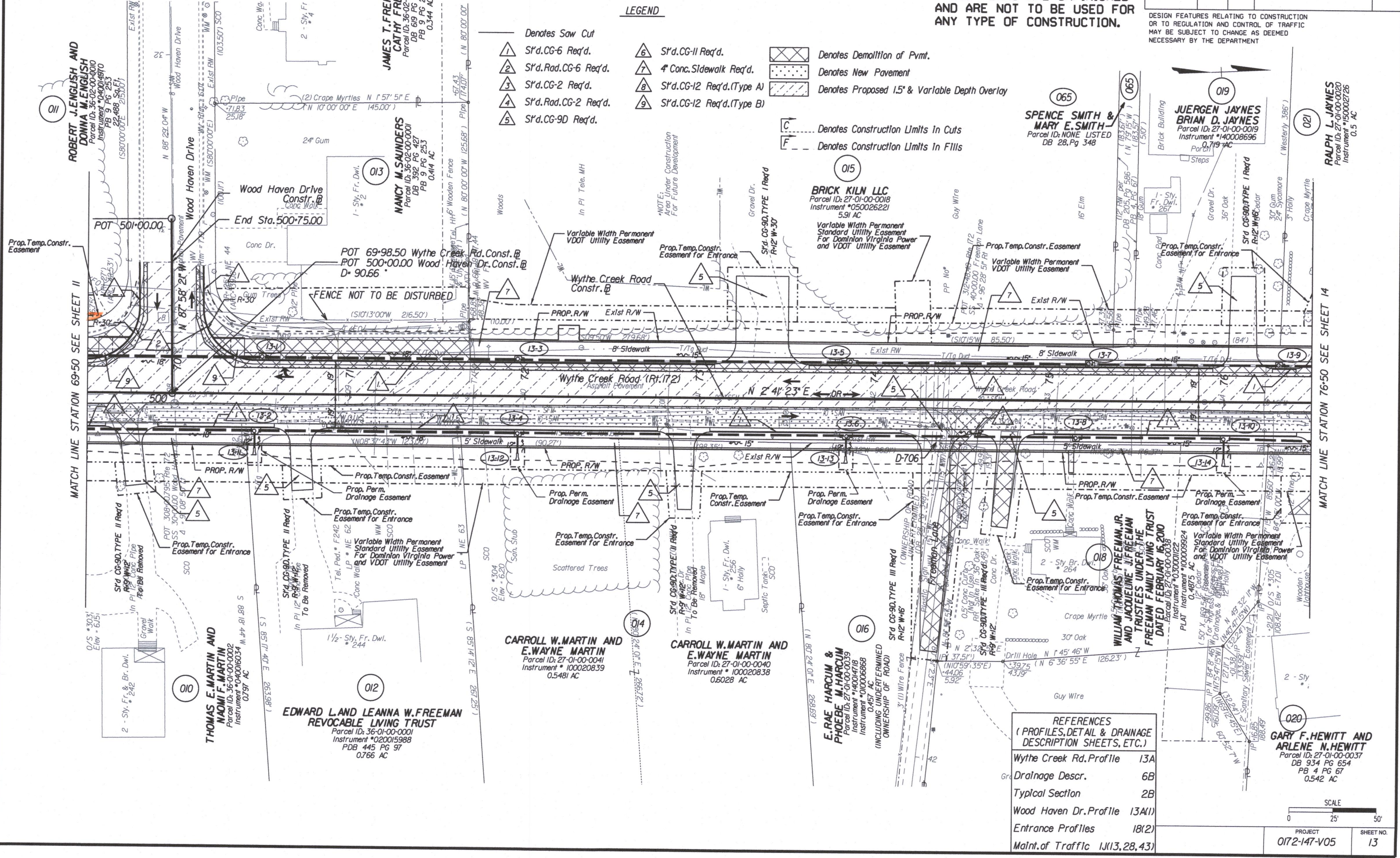

- LEGEND**
- △ 1 S'd.CG-6 Req'd.
  - △ 2 S'd.Rad.CG-6 Req'd.
  - △ 3 S'd.CG-2 Req'd.
  - △ 4 S'd.Rad.CG-2 Req'd.
  - △ 5 S'd.CG-9D Req'd.
  - △ 6 S'd.CG-11 Req'd.
  - △ 7 4" Conc.Sidewalk Req'd.
  - △ 8 S'd.CG-12 Req'd.(Type A)
  - △ 9 S'd.CG-12 Req'd.(Type B)
- [Hatched Box] Denotes Demolition of Pmnt.
  - [Dotted Box] Denotes New Pavement
  - [Cross-hatched Box] Denotes Proposed 1.5' & Variable Depth Overlay
- C --- Denotes Construction Limits In Cuts
  - F --- Denotes Construction Limits In Fills

**REFERENCES**  
 (PROFILES, DETAIL & DRAINAGE DESCRIPTION SHEETS, ETC.)

Wythe Creek Rd.Profile	13A
Drainage Descr.	6B
Typical Section	2B
Wood Haven Dr.Profile	13A(1)
Entrance Profiles	18(2)
Maint.of Traffic	1J(13, 28, 43)

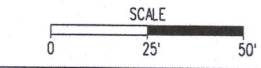

PROJECT	0172-147-V05
SHEET NO.	13