

PROJECT MANAGER: KENNY WYTHE, P.E., (757) 494-5479 (Hampton Roads District)  
SURVEYED BY: DATE: R. DEAN MURPHY, L.S. (757) 925-2660 (Hampton Roads District)  
DESIGN BY: CLARK MAXSON, VIRGINIA BEACH, VA. (757) 455-5800  
SUBSURFACE UTILITY BY: DATE: HOWARD A. SPENCE, L.S. (Hampton Roads District)

REVISED	STATE	ROUTE	STATE	PROJECT	SHEET NO.
03/29/2017	VA.	172	VA.	0172-147-V05, RW-201	11
04/28/2017					
05/10/2017					
06/06/2017					
06/14/2017					
06/29/2017					

THESE PLANS ARE UNFINISHED AND ARE NOT TO BE USED FOR ANY TYPE OF CONSTRUCTION.

DESIGN FEATURES RELATING TO CONSTRUCTION OR TO REGULATION AND CONTROL OF TRAFFIC MAY BE SUBJECT TO CHANGE AS DEEMED NECESSARY BY THE DEPARTMENT

PLAT INSTRUMENT # 170015439

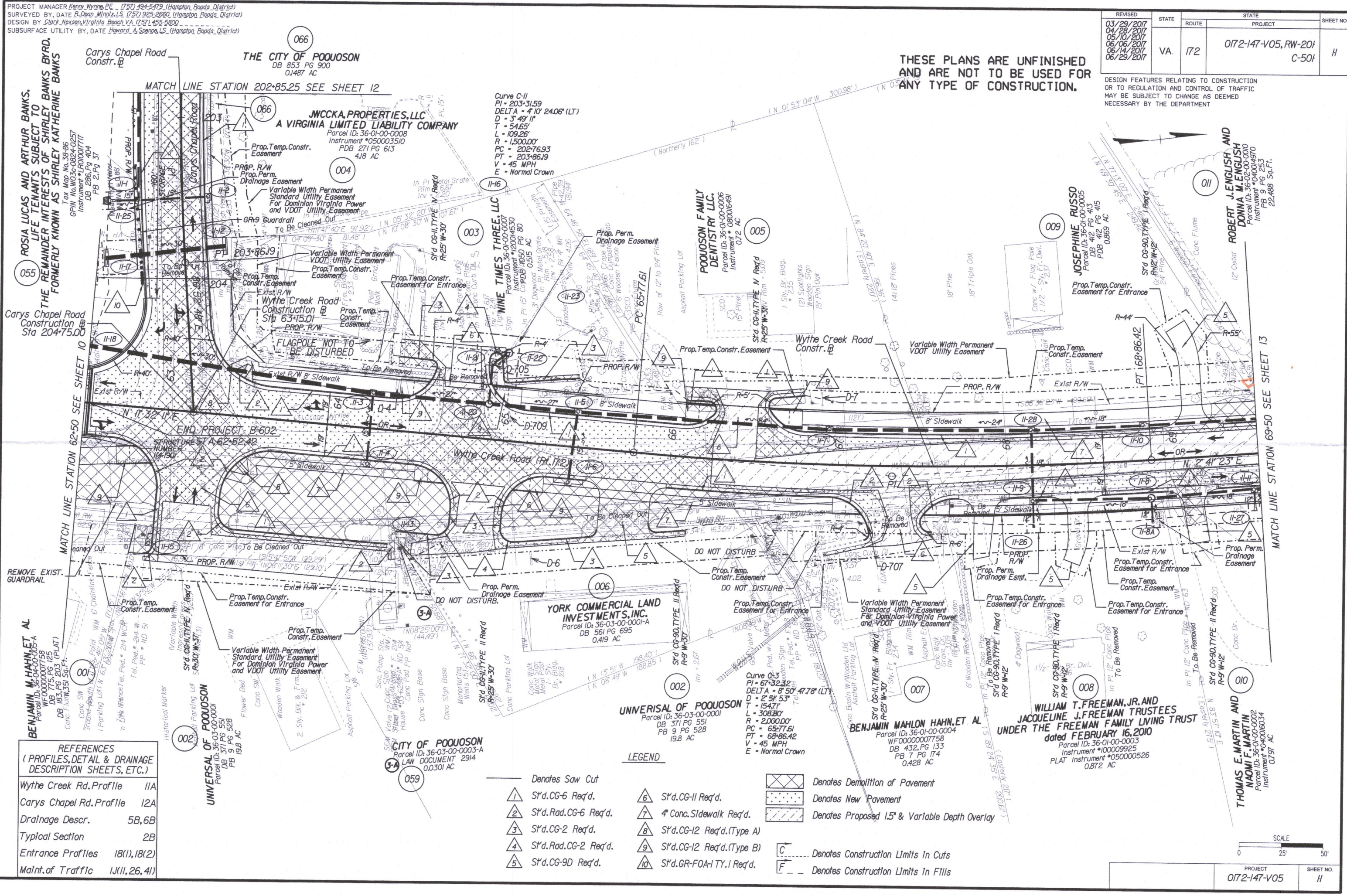

REFERENCES  
(PROFILES, DETAIL & DRAINAGE DESCRIPTION SHEETS, ETC.)

Wythe Creek Rd. Profile	11A
Carys Chapel Rd. Profile	12A
Drainage Descr.	5B, 6B
Typical Section	2B
Entrance Profiles	18(1), 18(2)
Maint. of Traffic	1J(1), 26, 41

LEGEND

- Denotes Saw Cut
- ① S'd. CG-6 Req'd.
- ② S'd. Rad. CG-6 Req'd.
- ③ S'd. CG-2 Req'd.
- ④ S'd. Rad. CG-2 Req'd.
- ⑤ S'd. CG-9D Req'd.
- ⑥ S'd. CG-11 Req'd.
- ⑦ 4' Conc. Sidewalk Req'd.
- ⑧ S'd. CG-12 Req'd. (Type A)
- ⑨ S'd. CG-12 Req'd. (Type B)
- ⑩ S'd. GR-FOA-1TY.1 Req'd.
- [X] Denotes Demolition of Pavement
- [.] Denotes New Pavement
- [//] Denotes Proposed 1.5' & Variable Depth Overlay
- [C] Denotes Construction Limits In Cuts
- [F] Denotes Construction Limits In Fills

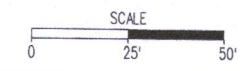

PROJECT	0172-147-V05
SHEET NO.	11