

REVISED	STATE	ROUTE	PROJECT	SHEET NO.
03/29/2017 04/28/2017 07/19/2017	VA.	172	0172-147-V05, RW-201 C-501	13

THESE PLANS ARE UNFINISHED
AND ARE NOT TO BE USED FOR
ANY TYPE OF CONSTRUCTION.

DESIGN FEATURES RELATING TO CONSTRUCTION
OR TO REGULATION AND CONTROL OF TRAFFIC
MAY BE SUBJECT TO CHANGE AS DEEMED
NECESSARY BY THE DEPARTMENT

PLAT INSTRUMENT # 170015645

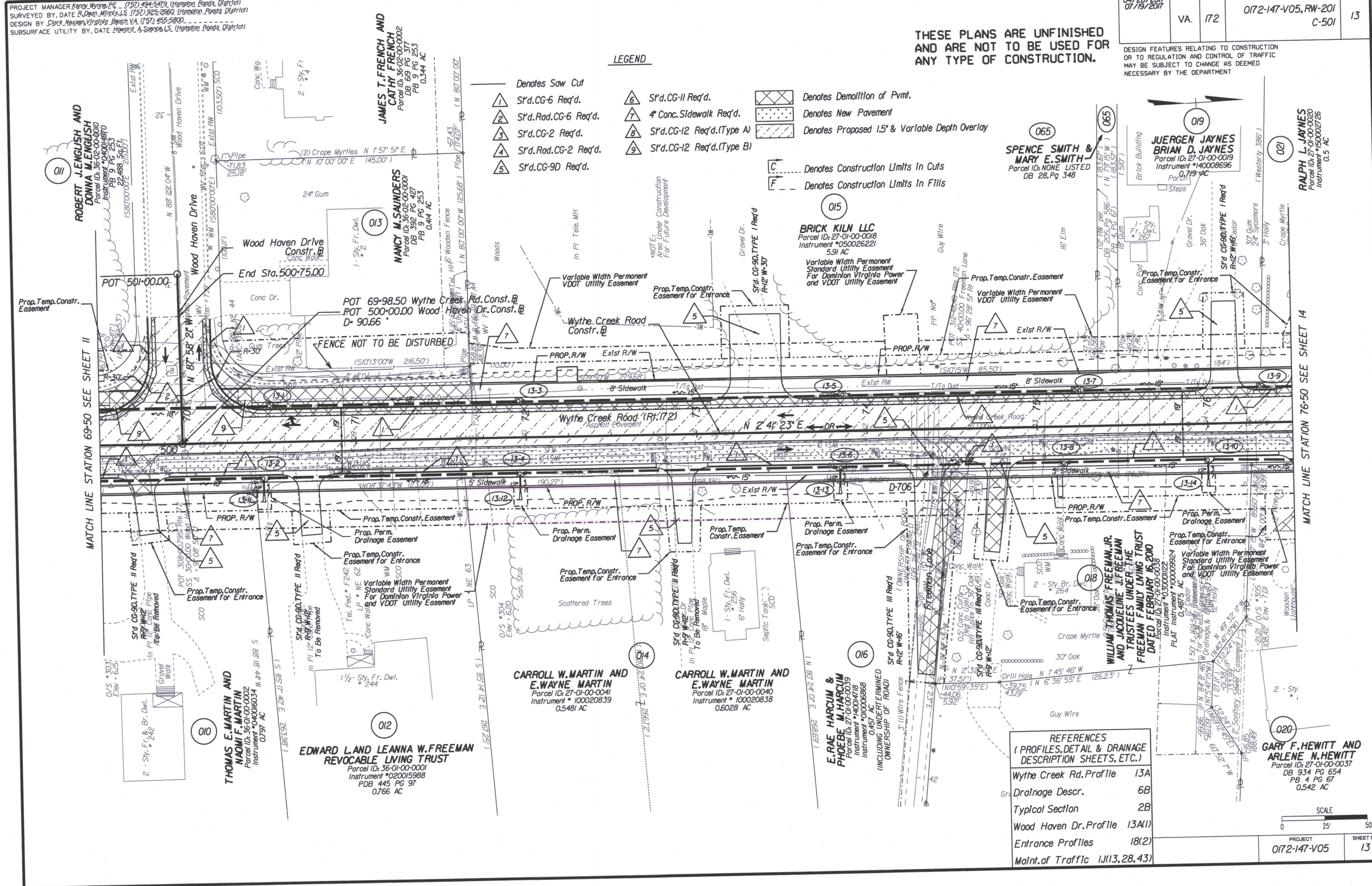

LEGEND

- Denotes Saw Cut
- ▲ 1 S'd.CG-6 Req'd.
- ▲ 2 S'd.Rad.CG-6 Req'd.
- ▲ 3 S'd.CG-2 Req'd.
- ▲ 4 S'd.Rad.CG-2 Req'd.
- ▲ 5 S'd.CG-9D Req'd.
- ▲ 6 S'd.CG-11 Req'd.
- ▲ 7 4" Conc.Sidewalk Req'd.
- ▲ 8 S'd.CG-12 Req'd.(Type A)
- ▲ 9 S'd.CG-12 Req'd.(Type B)
- ▨ Denotes Demolition of Pmnt.
- ▤ Denotes New Pavement
- ▥ Denotes Proposed 1.5' & Variable Depth Overlay
- C --- Denotes Construction Limits In Cuts
- F --- Denotes Construction Limits In Fills

005
ROBERT J. ENGLISH AND
DONNA M. ENGLISH
Parcel ID: 35-01-00-010
Instrument # 040004970
DB 28, PG 253
0.344 AC

006
JAMES T. FRENCH AND
CATHY FRENCH
Parcel ID: 36-02-00-0002
DB 69, PG 377
PB 9, PG 253
0.344 AC

007
NANCY M. SAUNDERS
Parcel ID: 36-02-00-0001
DB 69, PG 377
PB 9, PG 253
0.414 AC

008
BRICK KILN LLC
Parcel ID: 27-01-00-0018
Instrument # 050026221
5.91 AC
Variable Width Permanent
Standard Utility Easement
For Dominion Virginia Power
and VDOT Utility Easement

009
JUERGEN JAYNES
BRIAN D. JAYNES
Parcel ID: 27-01-00-0019
Instrument # 140008696
0.719 AC

010
THOMAS E. MARTIN AND
MAOMI E. MARTIN
Parcel ID: 36-01-00-0002
Instrument # 040016034
0197 AC

011
EDWARD L. AND LEANNA W. FREEMAN
REVOCABLE LIVING TRUST
Parcel ID: 36-01-00-0001
Instrument # 020015988
PDB 445 PG 97
0.766 AC

012
CARROLL W. MARTIN AND
E. WAYNE MARTIN
Parcel ID: 27-01-00-0041
Instrument # 100020839
0.5481 AC

013
CARROLL W. MARTIN AND
E. WAYNE MARTIN
Parcel ID: 27-01-00-0040
Instrument # 100020838
0.5028 AC

014
E. RAE HARCUM &
PHOEBE M. HARCUM
Parcel ID: 27-01-00-0039
Instrument # 140004718
Instrument # 010006868
Instrument # 010006868
(INCLUDING UNDERDETERMINED
OWNERSHIP OF ROAD)

015
WILLIAM THOMAS FREEMAN, JR.
AND JACQUELINE J. FREEMAN
TRUSTEES UNDER THE
FREEMAN FAMILY LIVING TRUST
DATED FEBRUARY 16, 2010
Parcel ID: 27-01-00-0038
Instrument # 0300002924
0.615 AC

016
GARY F. HEWITT AND
ARLENE N. HEWITT
Parcel ID: 27-01-00-0037
DB 934 PG 654
PB 4 PG 67
0.542 AC

REFERENCES
(PROFILES, DETAIL & DRAINAGE
DESCRIPTION SHEETS, ETC.)

Wythe Creek Rd. Profile	13A
Drainage Descr.	6B
Typical Section	2B
Wood Haven Dr. Profile	13A(1)
Entrance Profiles	18(2)
Maint. of Traffic	1J(13, 28, 43)

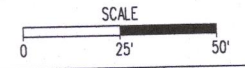

PROJECT: 0172-147-V05
SHEET NO.: 13