

PROJECT MANAGER: **Kenny Wythe, PE** (757) 494-5479 (Hampton Roads District)  
 SURVEYED BY, DATE: **R. Dean Minnix, LS** (757) 925-2660 (Hampton Roads District)  
 DESIGN BY: **Clark Nexsen, Virginia Beach, VA** (757) 455-5800  
 SUBSURFACE UTILITY BY, DATE: **Howard A. Spence, LS** (Hampton Roads District)

REVISED	STATE	ROUTE	PROJECT	SHEET NO.
03/29/2017 04/28/2017 07/19/2017	VA	172	0172-147-V05, RW-201 C-501	13

**THESE PLANS ARE UNFINISHED  
 AND ARE NOT TO BE USED FOR  
 ANY TYPE OF CONSTRUCTION.**

DESIGN FEATURES RELATING TO CONSTRUCTION  
 OR TO REGULATION AND CONTROL OF TRAFFIC  
 MAY BE SUBJECT TO CHANGE AS DEEMED  
 NECESSARY BY THE DEPARTMENT

PLAT INSTRUMENT # 1700156440

**LEGEND**

- Denotes Saw Cut
- 1 S'd.CG-6 Req'd.
- 2 S'd.Rad.CG-6 Req'd.
- 3 S'd.CG-2 Req'd.
- 4 S'd.Rad.CG-2 Req'd.
- 5 S'd.CG-9D Req'd.
- 6 S'd.CG-II Req'd.
- 7 4" Conc.Sidewalk Req'd.
- 8 S'd.CG-12 Req'd.(Type A)
- 9 S'd.CG-12 Req'd.(Type B)
- Denotes Demolition of Pvmf.
- Denotes New Pavement
- Denotes Proposed 15' & Variable Depth Overlay
- C Denotes Construction Limits In Cuts
- F Denotes Construction Limits In Fills

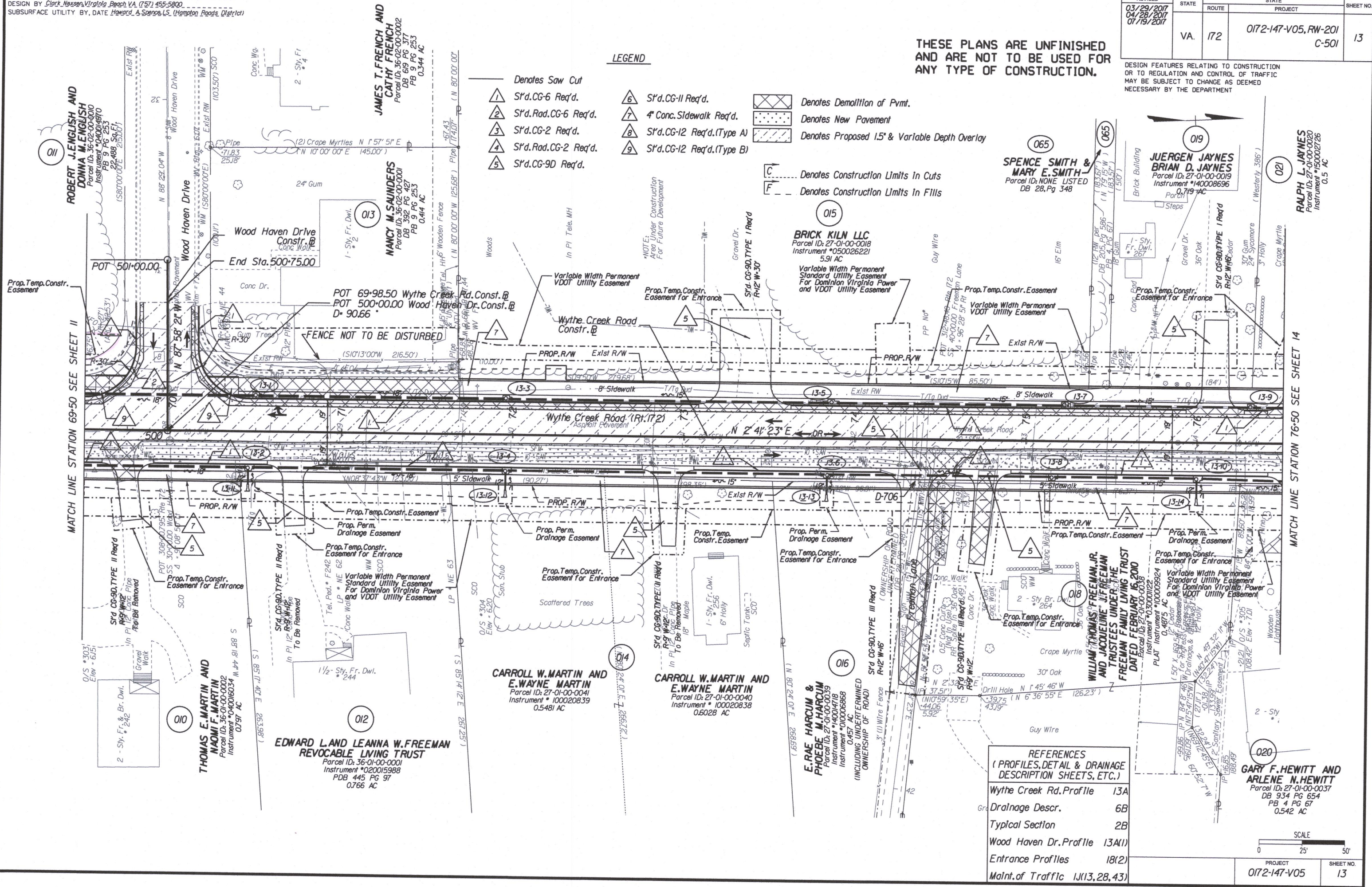

MATCH LINE STATION 69+50 SEE SHEET 11

MATCH LINE STATION 76+50 SEE SHEET 14

**REFERENCES  
 (PROFILES, DETAIL & DRAINAGE  
 DESCRIPTION SHEETS, ETC.)**

Wythe Creek Rd. Profile	13A
Drainage Descr.	6B
Typical Section	2B
Wood Haven Dr. Profile	13A(1)
Entrance Profiles	18(2)
Maint. of Traffic	1J(1,28,43)

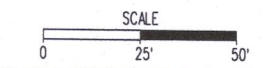

PROJECT	0172-147-V05
SHEET NO.	13

**ROBERT J. ENGLISH AND  
 DONNA M. ENGLISH**  
 Parcel ID: 36-02-00-0010  
 Instrument # 040014970  
 PB 9 PG 253  
 0.344 AC

**JAMES T. FRENCH AND  
 CATHY FRENCH**  
 Parcel ID: 36-02-00-0002  
 DB 619 PG 377  
 PB 9 PG 253  
 0.344 AC

**NANCY M. SAUNDERS**  
 Parcel ID: 36-02-00-0001  
 DB 392 PG 427  
 PB 9 PG 253  
 0.414 AC

**BRICK KILN LLC**  
 Parcel ID: 27-01-00-0018  
 Instrument # 050026221  
 5.91 AC

**SPENCE SMITH &  
 MARY E. SMITH**  
 Parcel ID: NONE LISTED  
 DB 28, PG 348

**JUERGEN JAYNES  
 BRIAN D. JAYNES**  
 Parcel ID: 27-01-00-0019  
 Instrument # 140008696  
 0.719 AC

**RALPH L. JAYNES**  
 Parcel ID: 27-01-00-0020  
 Instrument # 150002726  
 0.5 AC

**THOMAS E. MARTIN AND  
 NAOMI F. MARTIN**  
 Parcel ID: 36-01-00-0002  
 Instrument # 040016034  
 W. #4 B1, B8 S  
 0.797 AC

**EDWARD L. AND LEANNA W. FREEMAN  
 REVOCABLE LIVING TRUST**  
 Parcel ID: 36-01-00-0001  
 Instrument # 020015988  
 PDB 445 PG 97  
 0.766 AC

**CARROLL W. MARTIN AND  
 E. WAYNE MARTIN**  
 Parcel ID: 27-01-00-0041  
 Instrument # 100020839  
 0.5481 AC

**CARROLL W. MARTIN AND  
 E. WAYNE MARTIN**  
 Parcel ID: 27-01-00-0040  
 Instrument # 100020838  
 0.6028 AC

**E. RAE HARCUM &  
 PHOEBE M. HARCUM**  
 Parcel ID: 27-01-00-0039  
 Instrument # 140014718  
 Instrument # 010006968  
 0.457 AC  
 (INCLUDING UNDERDETERMINED  
 OWNERSHIP OF ROAD)

**WILLIAM THOMAS FREEMAN, JR.  
 AND JACQUELINE J. FREEMAN  
 TRUSTEES UNDER THE  
 FREEMAN FAMILY LIVING TRUST  
 DATED FEBRUARY 16, 2010**  
 Parcel ID: 27-01-00-0038  
 Instrument # 030001022  
 Instrument # 000009924  
 0.4875 AC

**GARY F. HEWITT AND  
 ARLENE N. HEWITT**  
 Parcel ID: 27-01-00-0037  
 DB 934 PG 654  
 PB 4 PG 67  
 0.542 AC