

PROJECT MANAGER: Kenny Wythe, PE (757) 494-5479 (Hampton Roads District)  
 SURVEYED BY: DATE: R. Dean Minor, LS (757) 925-2660 (Hampton Roads District)  
 DESIGN BY: Clark Nexsen, Virginia Beach, VA (757) 455-5800  
 SUBSURFACE UTILITY BY: DATE: Howard A. Spence, LS (Hampton Roads District)

REVISED	STATE	ROUTE	STATE PROJECT	SHEET NO.
03/29/2017	VA	172	0172-147-V05, RW-201	11
04/28/2017				
05/10/2017				
06/06/2017				
06/14/2017				
06/29/2017				

THESE PLANS ARE UNFINISHED  
 AND ARE NOT TO BE USED FOR  
 ANY TYPE OF CONSTRUCTION.

DESIGN FEATURES RELATING TO CONSTRUCTION  
 OR TO REGULATION AND CONTROL OF TRAFFIC  
 MAY BE SUBJECT TO CHANGE AS DEEMED  
 NECESSARY BY THE DEPARTMENT

PLAT INSTRUMENT # 1700150410

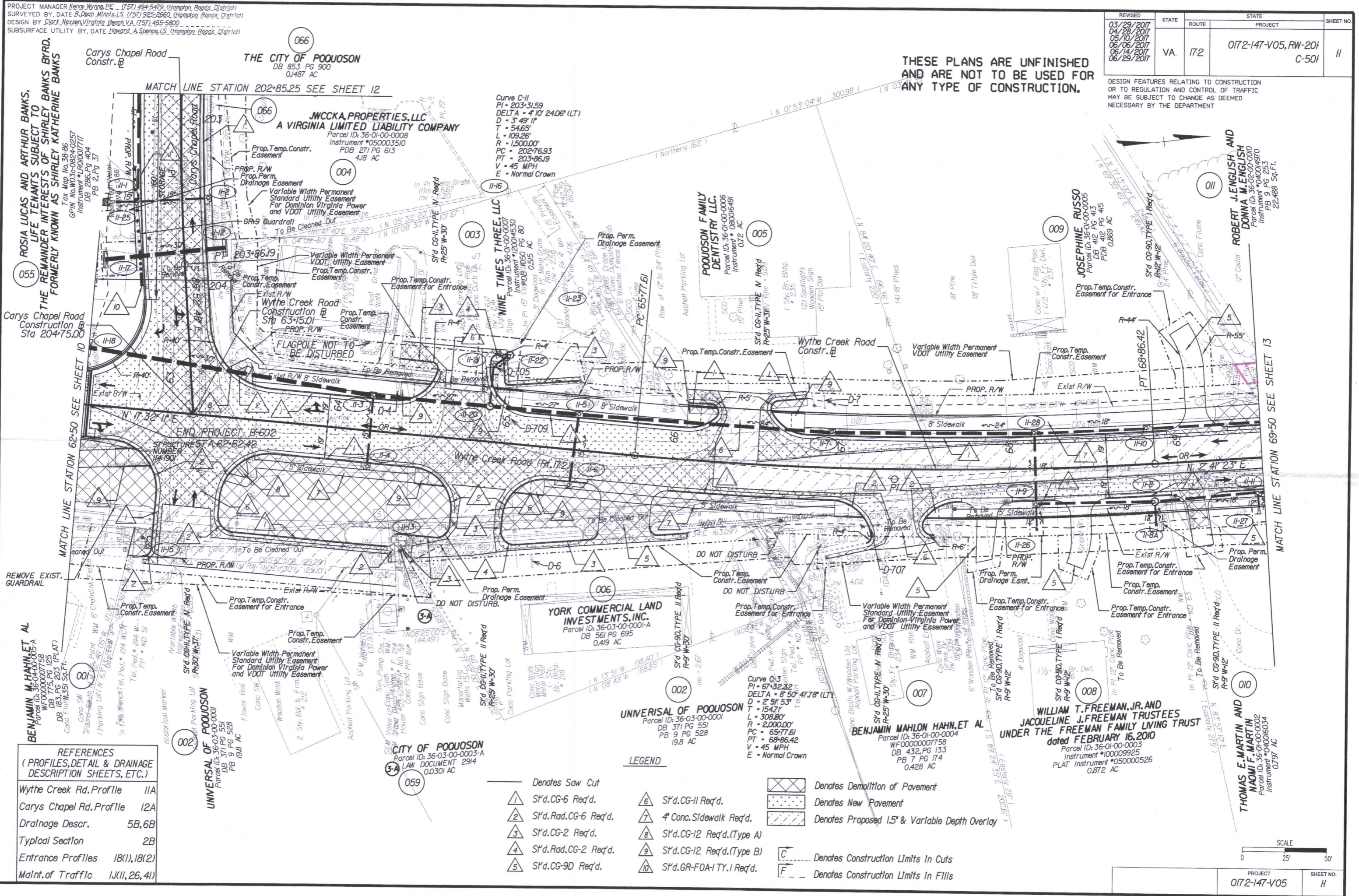

**REFERENCES  
 (PROFILES, DETAIL & DRAINAGE  
 DESCRIPTION SHEETS, ETC.)**

Wythe Creek Rd. Profile	11A
Carys Chapel Rd. Profile	12A
Drainage Descr.	5B, 6B
Typical Section	2B
Entrance Profiles	18(1), 18(2)
Maint. of Traffic	11(K), 26, 41)

**UNIVERSAL OF POQUOSON**  
 Parcel ID: 36-03-00-0001  
 DB 371 PG 551  
 PB 9 PG 528  
 19.8 AC

- LEGEND**
- Denotes Saw Cut
  - ① S'd. CG-6 Req'd.
  - ② S'd. Rad. CG-6 Req'd.
  - ③ S'd. CG-2 Req'd.
  - ④ S'd. Rad. CG-2 Req'd.
  - ⑤ S'd. CG-9D Req'd.
  - ⑥ S'd. CG-11 Req'd.
  - ⑦ 4' Conc. Sidewalk Req'd.
  - ⑧ S'd. CG-12 Req'd. (Type A)
  - ⑨ S'd. CG-12 Req'd. (Type B)
  - ⑩ S'd. GR-FOA-TY. I Req'd.
  - ▨ Denotes Demolition of Pavement
  - ▩ Denotes New Pavement
  - ▧ Denotes Proposed 1.5' & Variable Depth Overlay
  - C --- Denotes Construction Limits In Cuts
  - F --- Denotes Construction Limits In Fills

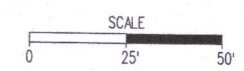

PROJECT	0172-147-V05
SHEET NO.	11