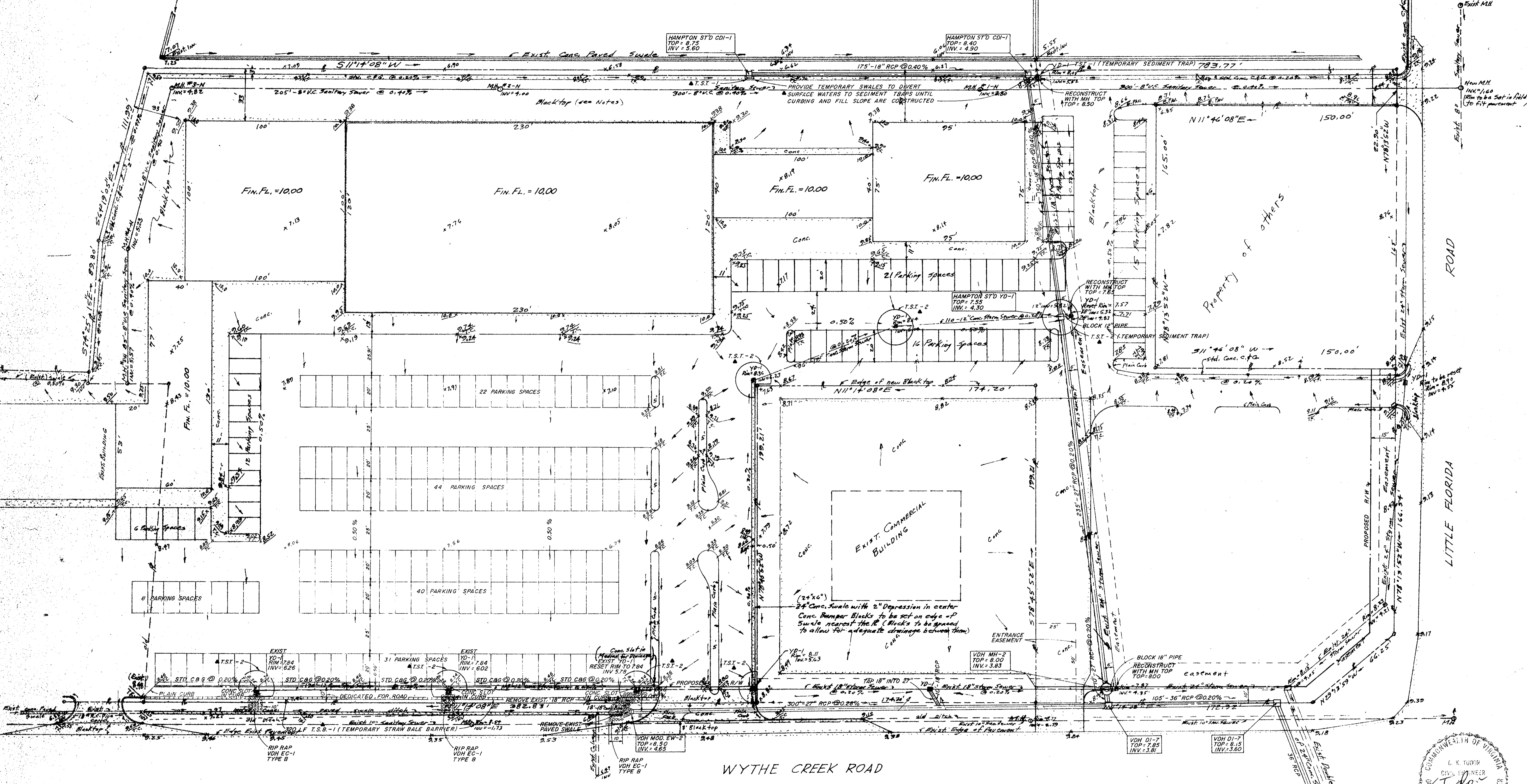

EXHIBIT A

WYTHE CREEK PLAZA SEC. 2



Note:

1. Exist. elevations shown thus: x 8.50
2. Proposed elevations shown thus: x 2.80 Top of Curb x 2.40
3. Conc. Paved swale on Wythe Creek Rd. to be 20"x7" with a 3" Depression (all others have a 2" Depression)
4. Parking Areas to be 5" crushed stone on approved base & approved sub-base with 2" Blacktop at Fin. grade (Heavy delivery areas to have 7" Crushed Stone with 3" Blacktop at Fin. Grade)
5. All work to conform to the City of Poquoson Standards & Practices

SOIL EROSION AND SEDIMENT CONTROL NOTES

1. DURING CONSTRUCTION CONTRACTOR SHALL CONTROL EROSION AND SEDIMENTATION BY MEASURES CONFORMING TO THE VIRGINIA EROSION CONTROL HANDBOOK AND AS ADDITIONALLY DETAILED ON THESE PLANS.
2. INITIAL CONSTRUCTION SHALL BE INSTALLATION OF THE ONSITE AND OFFSITE DRAINAGE SYSTEM. TEMPORARY SEDIMENT TRAPS, STRAW BALE BARRIER AND CHECK DAM ARE TO BE INSTALLED WHERE SHOWN ON THE PLANS PRIOR TO ANY ONSITE EARTHWORK AND GRADING ACTIVITY.
3. ALL SEDIMENT CONTROL MEASURES ARE TO BE MAINTAINED AND REMAIN IN PLACE UNTIL COMPLETION OF SITE IMPROVEMENTS.
4. AFTER COMPLETION OF ALL SITE IMPROVEMENTS, DITCHES ARE TO BE CLEANED, FINE GRADED AND SEEDING.

Filed in the Clerk's Office, Circuit Court, York Co., Va.  
 the 15 day of Aug 1980

Edith M. Elliott, Clerk

Head Back # 343, page 477

BENCH MARK — TOP OF STAKE ON THE SIDE OF A UTILITY POLE LOCATED AT THE NORTHEAST CORNER OF LITTLE FLORIDA ROAD AND WYTHE CREEK ROAD (SET BY J. LAWSON) ELEVATION = 11.95 U.S.C&G.S DATUM

site plan  
**POQUOSON SHOPPING CENTER**

POQUOSON  
 John W. Lawson: Certified Land Surveyor, N.N. Va. — SCALE: 1"=30'

**ISSUED**  
 JUN 12 1980  
 G. K. TUDOR ENGINEERS, INC.

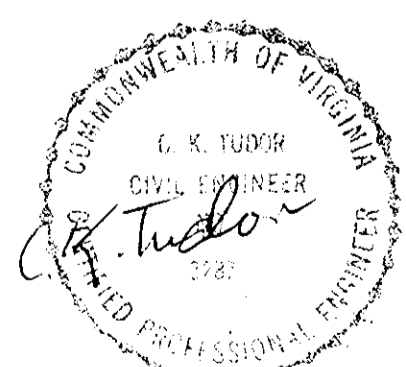

VIRGINIA  
 MAY 15 1979  
 Revised Sept 11, 1979  
 Revised MARCH 17, 1980  
 Revised APRIL 22, 1980  
 SHEET 1 OF 3

REVISED APRIL 1, 1980 TO SHOW SOIL EROSION AND SEDIMENT CONTROL PLAN.