

SUBDIVISION PLAT OF YORKSHIRE DOWNS CONDOMINIUM

PHASE XV

COUNTY OF YORK, VIRGINIA
DATE : 9 FEBRUARY 1994

DAVIS & ASSOCIATES

SURVEYORS - PLANNERS
4033 GEORGE WASHINGTON
MEMORIAL HIGHWAY
YORKTOWN, VIRGINIA 23692
(804) 898-9414

SCALE : AS SHOWN

SHEET 2 OF 2

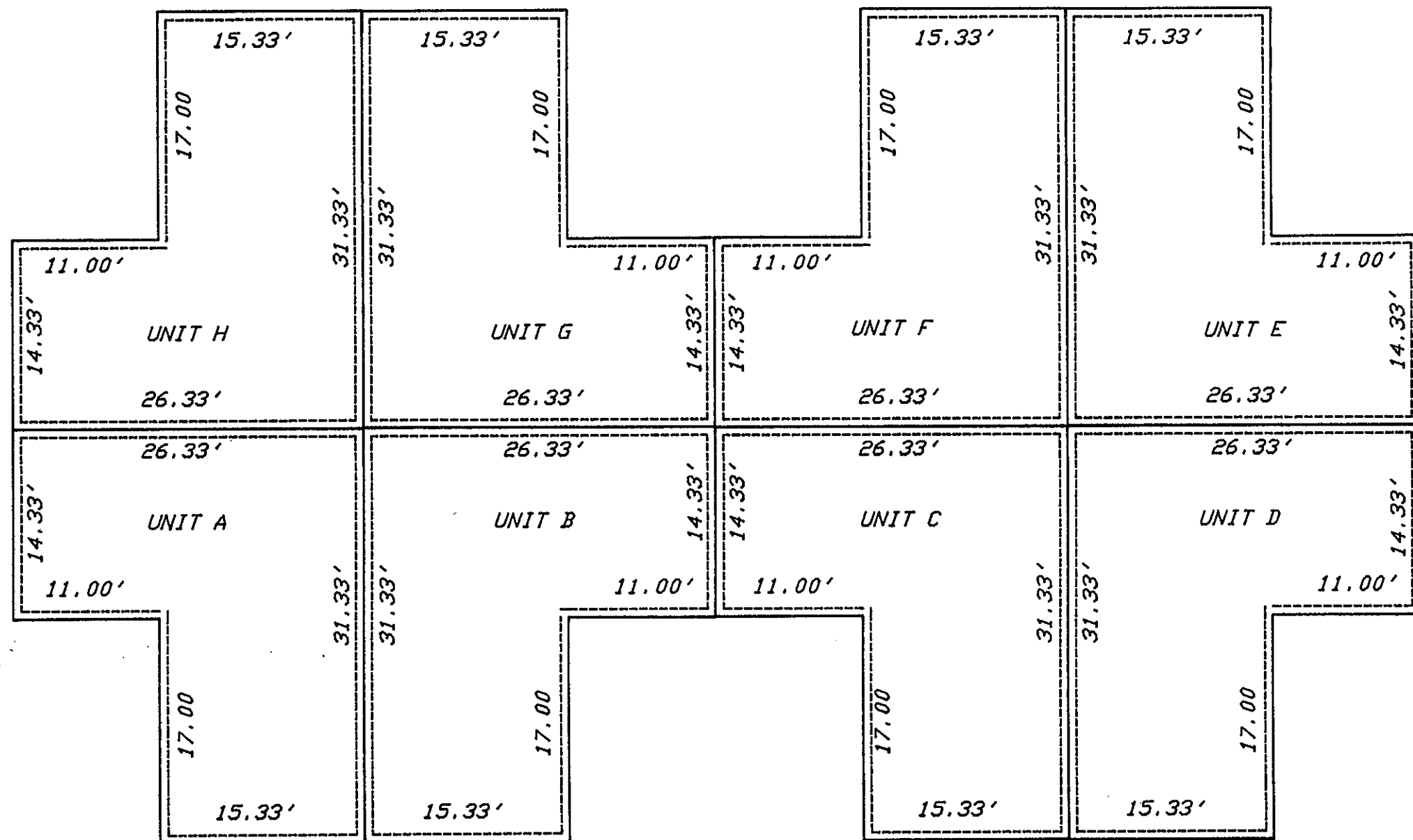

SECOND FLOOR PLAN

SCALE : 1" = 10'

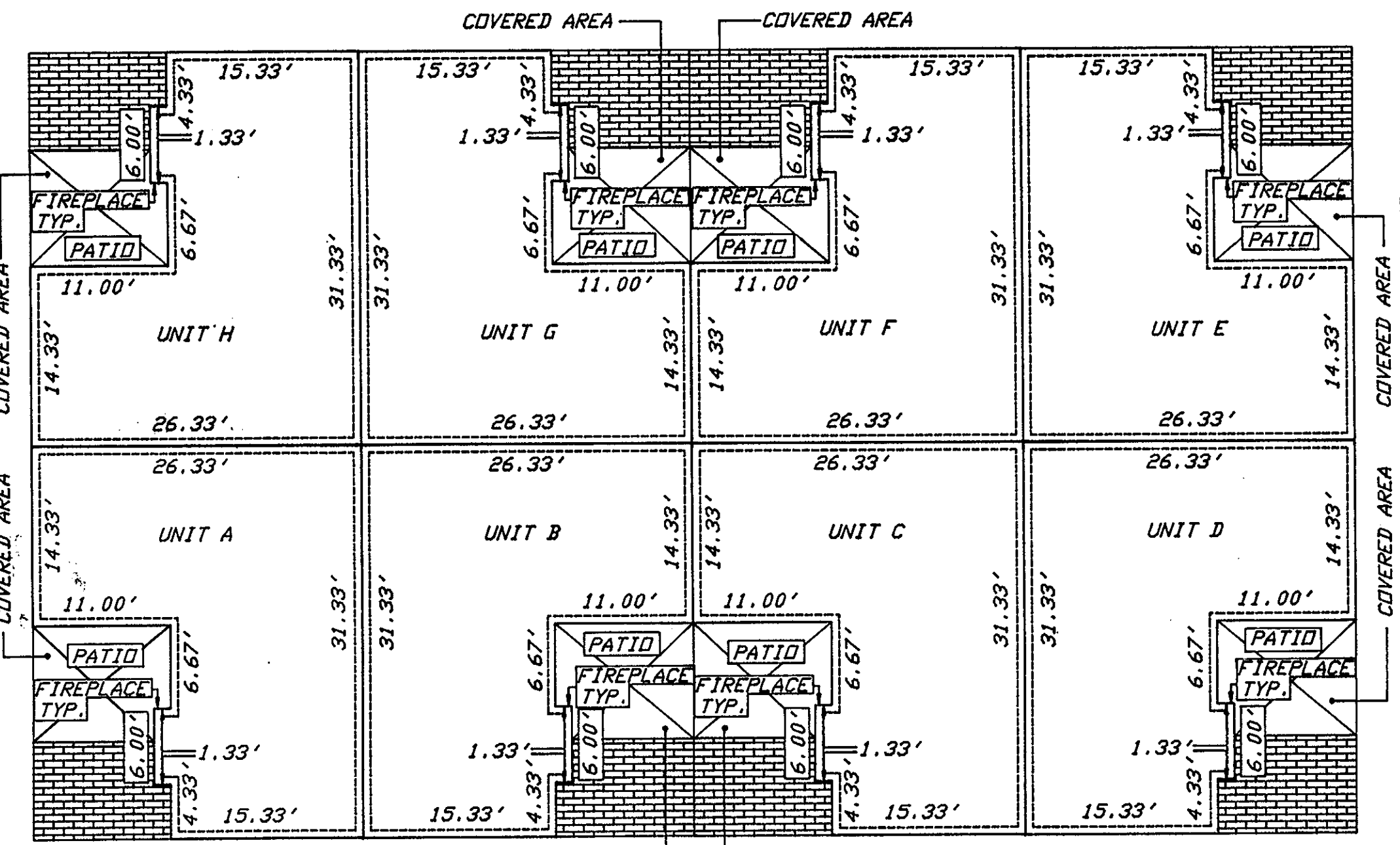

FIRST FLOOR PLAN

SCALE : 1" = 10'

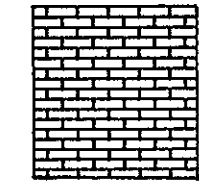
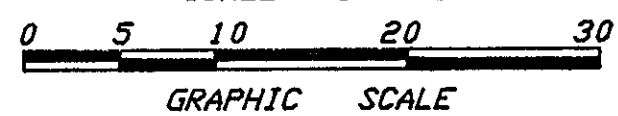

DENOTES LIMITED
COMMON ELEMENTS

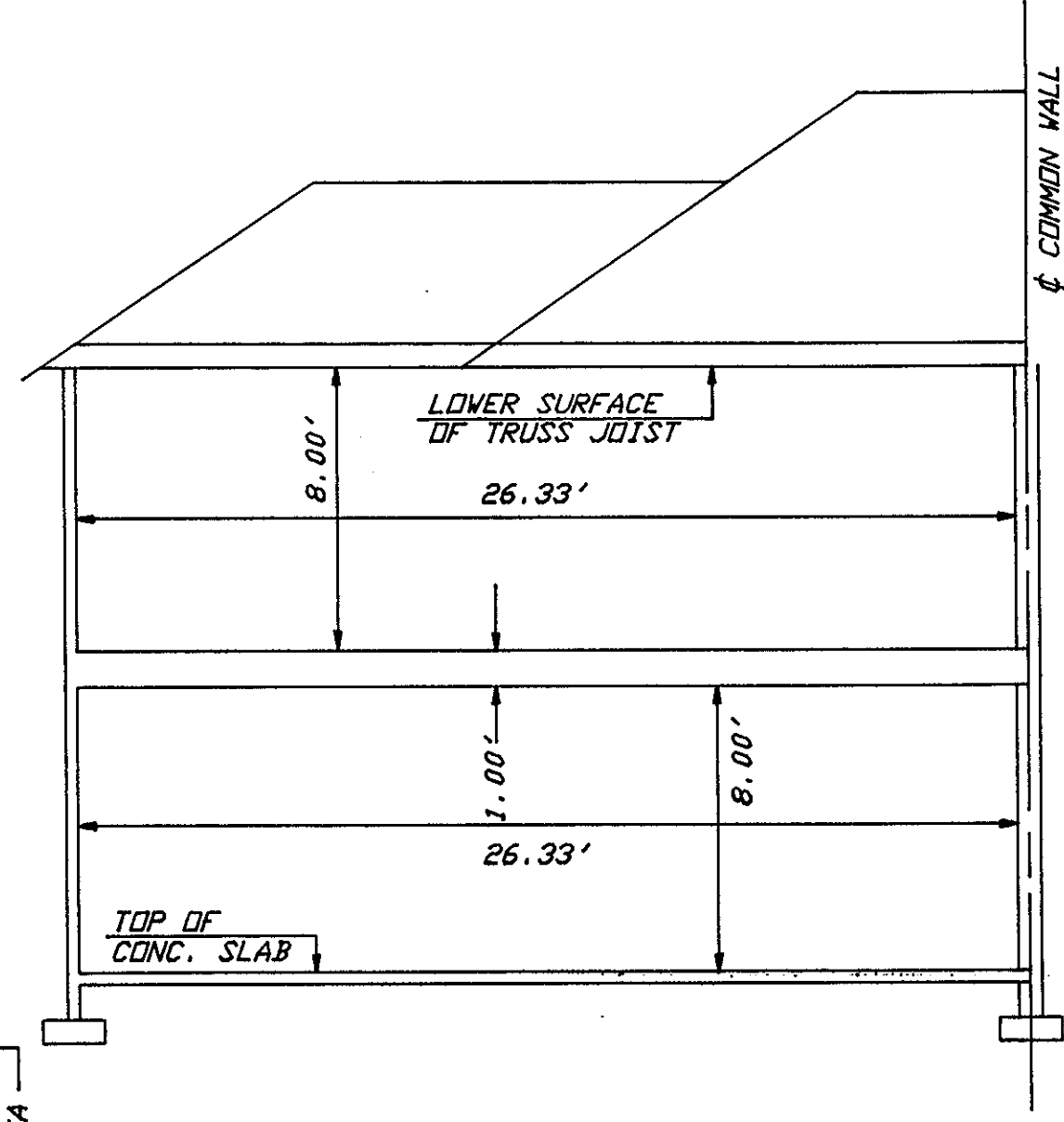

TYPICAL SECTION

SCALE : 1" = 5'

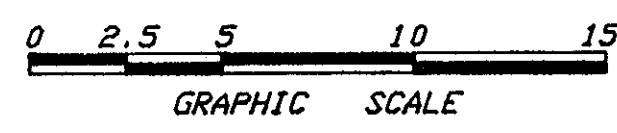

NOTE : SECTIONAL VIEWS OF UNITS AND ALL UNIT DIMENSIONS WERE OBTAINED FROM THE ARCHITECTURAL PLANS OF RICHARD LEE GRIMSTEAD, A REGISTERED ARCHITECT WITH THE COMMONWEALTH OF VIRGINIA.

I, DONALD W. DAVIS, A DULY REGISTERED SURVEYOR, DO HEREBY CERTIFY THAT THIS DRAWING IS ACCURATE (WITHIN NORMAL TOLERANCES) AND COMPLIES WITH SECTION 55-79.58(b) OF THE CONDOMINIUM ACT AND THAT THE UNITS SHOWN HEREON ARE SUBSTANTIALLY COMPLETED IN ACCORDANCE HEREIN.

Donald W. Davis
DONALD W. DAVIS, C.L.S.

9 FEB 94
DATE

STATE OF VIRGINIA
COUNTY OF YORK
IN THE CLERK'S OFFICE OF THE CIRCUIT
COURT FOR THE COUNTY OF YORK THE 1
DAY OF April 1994, THIS MAP WAS
PRESENTED AND ADMITTED TO RECORD AS
THE LAW DIRECTS IN PLAT BOOK 122
PAGE 33

TESTE : NANCY B. KANE, CLERK
BY : Carol Dromalmin, Deputy Clerk