

W. LINDSEY

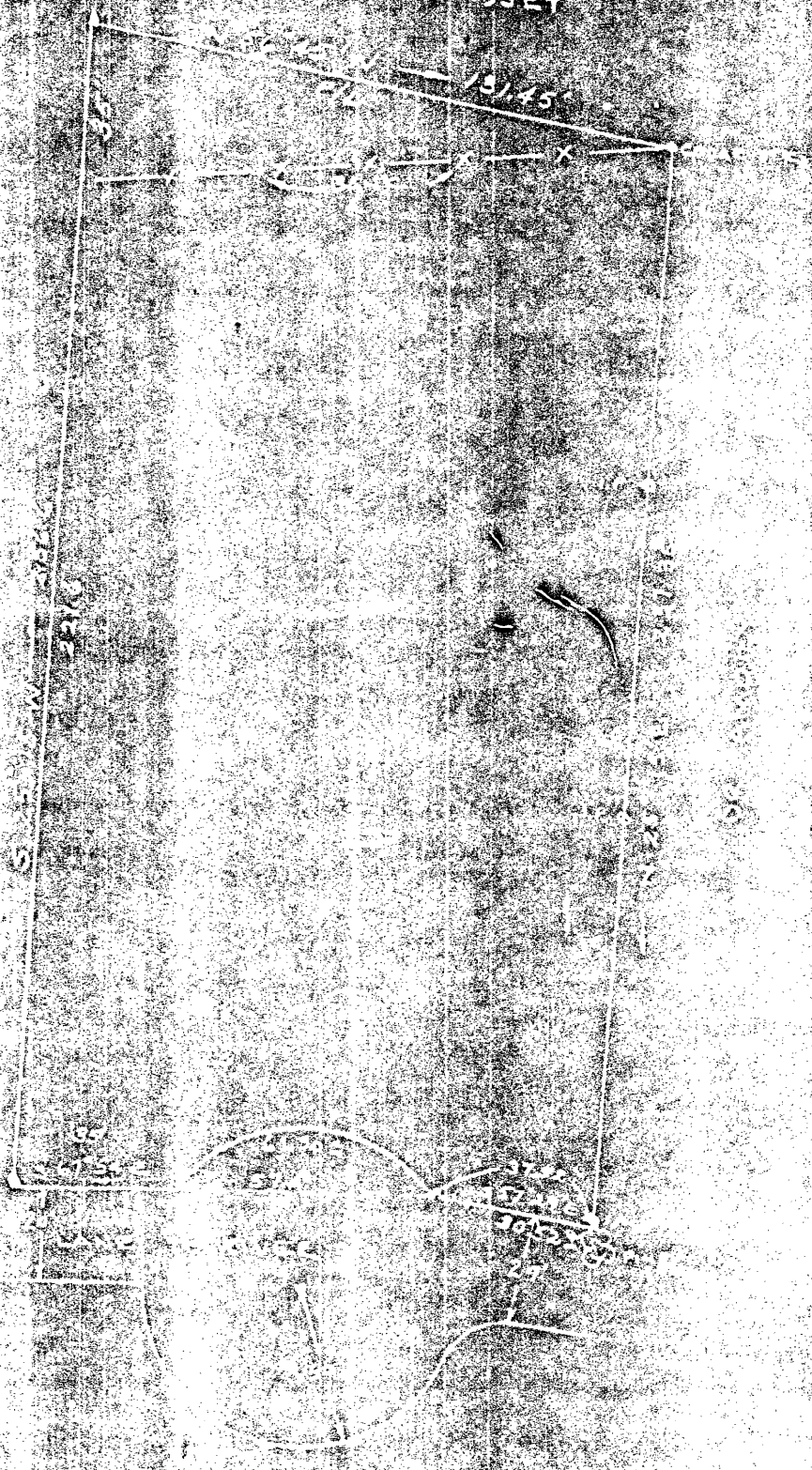

THE FOLLOWING BOUNDARY LINES BELONG
 TO THE LANDS BELONGING TO THE
 STATE OF MICHIGAN AND ARE SITUATED IN
 THE COUNTY OF WASHTENAW COUNTY, MICHIGAN
 SURVEYED BY J. W. LINDSEY SCALE 1" = 40'

J. W. LINDSEY
 Surveyor

3000 8

OB 114-199