

F.E.M.A. Does not lie in
 Special Flood Hazard Area
 Community No. 510182
 Panel No. 0003 A
 DATE OF FIRM: 7-2-82

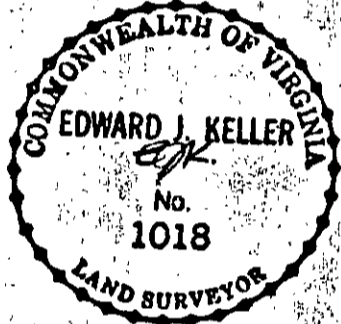
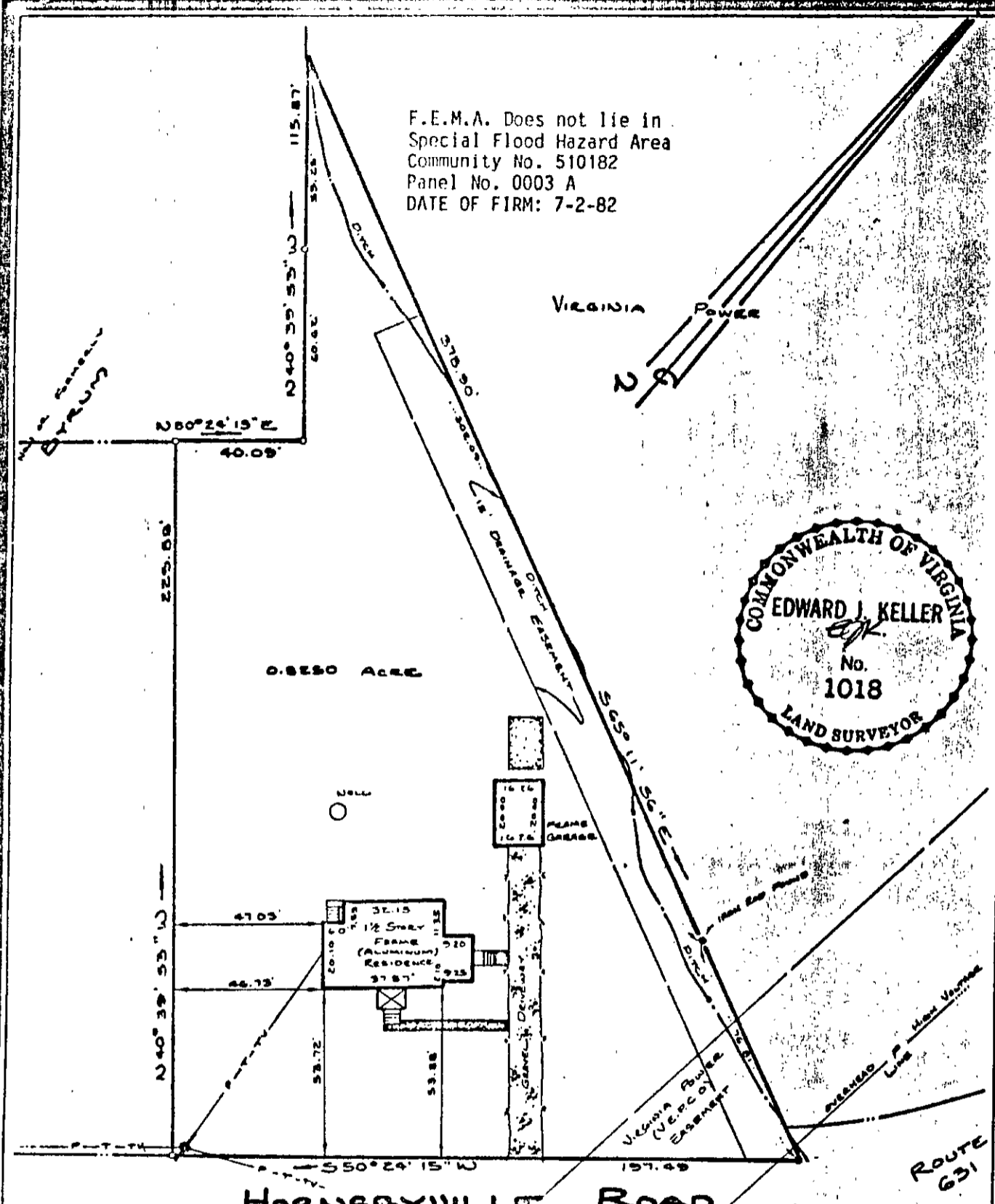

- SYMBOLS DENOTE**
- PIPE FOUND
 - PIPE SET
 - ROD FOUND
 - CONG. MONUMENT

ADDRESS: # 393 HORNSBYVILLE ROAD
 PLAT OF THE PROPERTY OF:
 JAMES C. & PATRICIA A. ROBINETTE

PARCEL of LAND
 CONTAINING
 0.8250 ACRES

Edward J. Keller
 HEREBY CERTIFY THAT THE
 SURVEY REPRESENTED BY THIS
 PLAT WAS MADE ON THIS DATE
 AND IS CORRECT TO THE BEST
 OF MY KNOWLEDGE AND BELIEF.
 I AM A LICENSED LAND SURVEYOR
 IN THE COMMONWEALTH OF VIRGINIA
 AND AM NOT PROVIDING THIS
 SERVICE AS AN EMPLOYEE OF THE
 FEDERAL GOVERNMENT.

DATE: 05-21-86

(2 pcs?)
 24-355