

N/F
FL. & J.D. ROSE
DB. 133, PG. 270
DB 432, PG. 54

1.175 Ac.

BOUNDARY SURVEY
IS BASED ON
EVIDENCE FOUND
IN THE FIELD

N/F
TE & ET. TRAGLE
DB 321, PG. 643

N 79° 55' E
255.9' AB SOUTHALL
DB 302, PG. 783

271'±
TO ROUTE 175

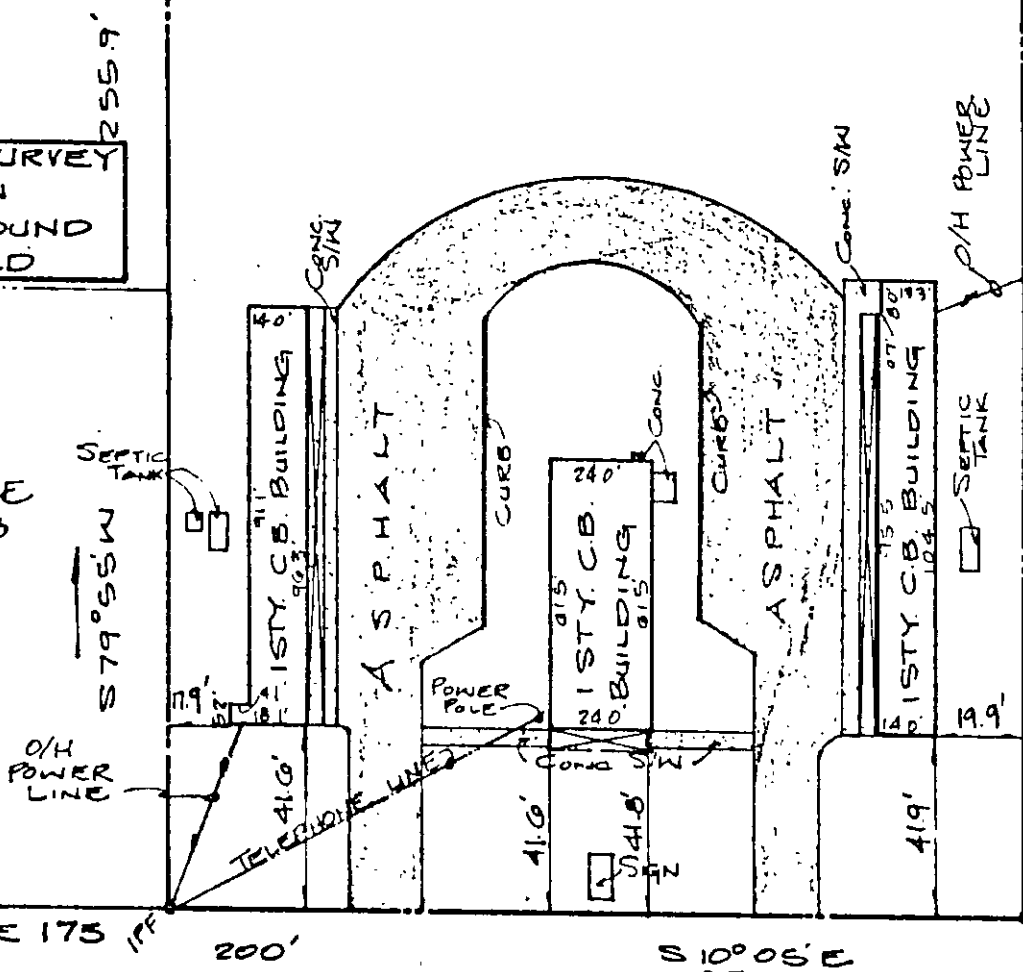

GEORGE WASHINGTON MEMORIAL HWY. (U.S. ROUTE 17)

THIS IS TO CERTIFY THAT ON FEBRUARY 8, 1988,
THIS OFFICE SURVEYED THE PROPERTY SHOWN ON
THIS PLAT. SUBJECT TO EASEMENTS, SERVITUDES
AND COVENANTS OF RECORD.

Property shown is not within a flood zone as
shown on panel 4 of FEMA map dated July 2,
1982 of community number 510182.



PLAT OF THE PROPERTY
TO BE CONVEYED TO
CHANDRA, INC.
CONTAINING 1.175 Ac.
YORK COUNTY, VIRGINIA

SCALE 1" = 40'

JOB No. 88-06-3532

DATE FEB. 8, 1988

F.B. 93 / 38 PG 32



J. J. ALFONSO

SURVEYOR - PLANNER

804 - 873 - 0750
NEWPORT NEWS, VIRGINIA

IRVING'S BLUEPRINTING PF 512703

29-66 L