

Design File - c:\documents of me... Ref. File - c:\documents of me... Levels On - 1502563

DESIGN FEATURES RELATING TO CONSTRUCTION OR TO REGULATION AND CONTROL OF TRAFFIC MAY BE SUBJECT TO CHANGE AS DEEMED NECESSARY BY THE DEPARTMENT.

REVISION	AREA	STATE	FEDERAL AID	ROUTE	STATE PROJECT
09/18/01 10/17/01		VA		782	0782-099-188.C-501

HAMPTON ROADS DISTRICT DESIGN UNIT

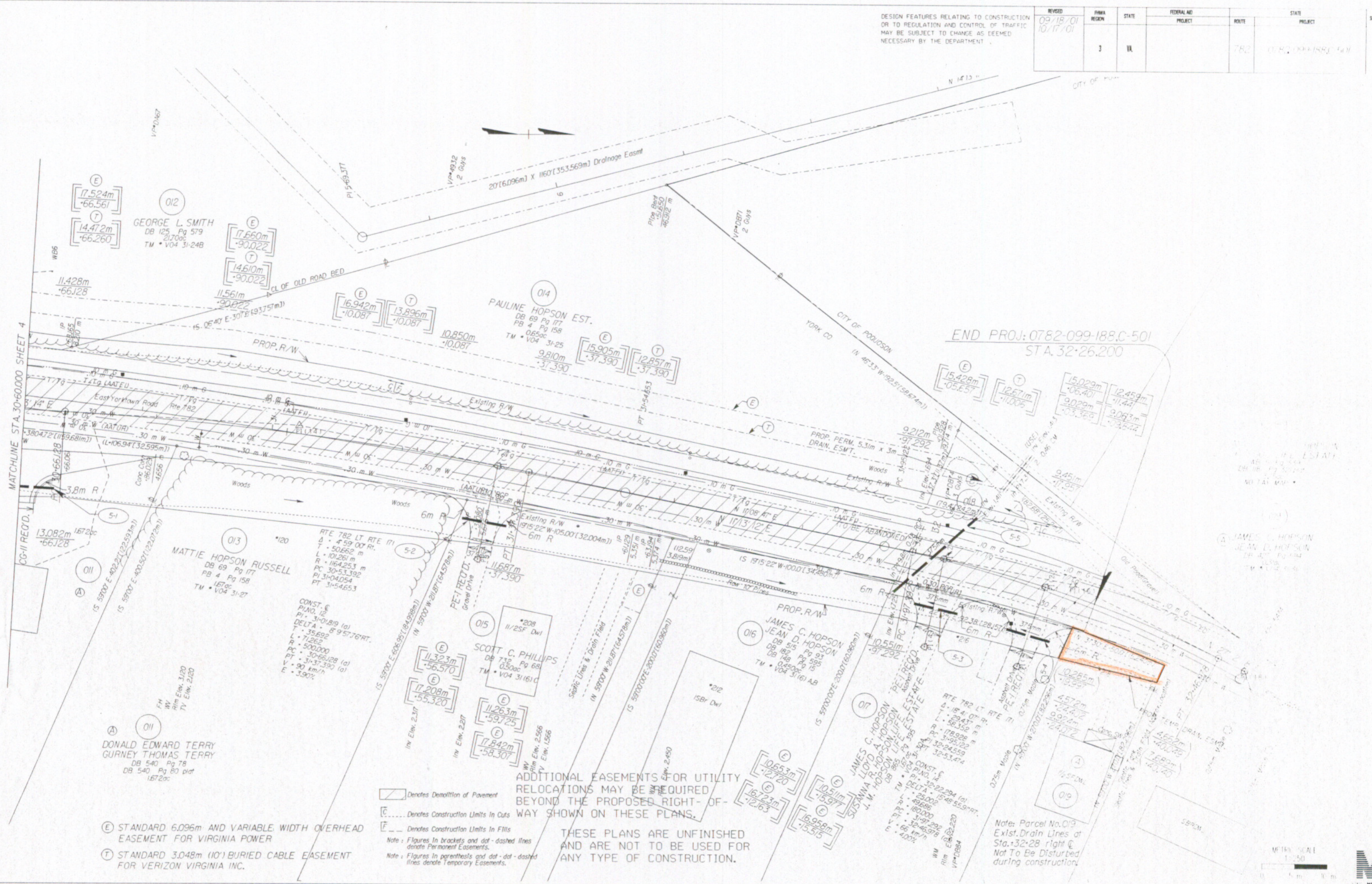

SURVEYED BY: R.G. HANCOCK 752-253-5171  
 DESIGNED BY: K.C. BOUTER 752-245-5588  
 CADD OPERATOR: JACOB J. JACOBI 752-245-5588  
 REVISIONS BY: JACOB J. JACOBI 752-245-5588

2/26/02 060806

- ⊠ Denotes Demolition of Pavement
- ⊞ Denotes Construction Limits In Cuts
- ⊞ Denotes Construction Limits In Fills
- ⊞ Figures in brackets and dot-dashed lines denote Permanent Easements.
- ⊞ Figures in parentheses and dot-dashed lines denote Temporary Easements.

ADDITIONAL EASEMENTS FOR UTILITY RELOCATIONS MAY BE REQUIRED BEYOND THE PROPOSED RIGHT-OF-WAY SHOWN ON THESE PLANS.

THESE PLANS ARE UNFINISHED AND ARE NOT TO BE USED FOR ANY TYPE OF CONSTRUCTION.

Note: Parcel No. 013 Exist. Drain Lines at Sta. 32+28 right of Way Not To Be Disturbed during construction.

