

Design File - c:\documents of ms_jacob\79355\79355-5.dgn Ref. File - c:\documents of ms_jacob\79355\79355.dgn ... Levels On - F&S

HAMPTON ROADS DISTRICT DESIGN UNIT

State Hwy. Plat Book No. 9 Page 54

DESIGN FEATURES RELATING TO CONSTRUCTION OR TO REGULATION AND CONTROL OF TRAFFIC MAY BE SUBJECT TO CHANGE AS DEEMED NECESSARY BY THE DEPARTMENT

REVISION	DATE	BY	STATE	FEDERAL AID PROJECT	ROUTE	STATE PROJECT	SHEET NO.
09/18/01	10/17/01		VA		782	0782-099-188.C-501	5

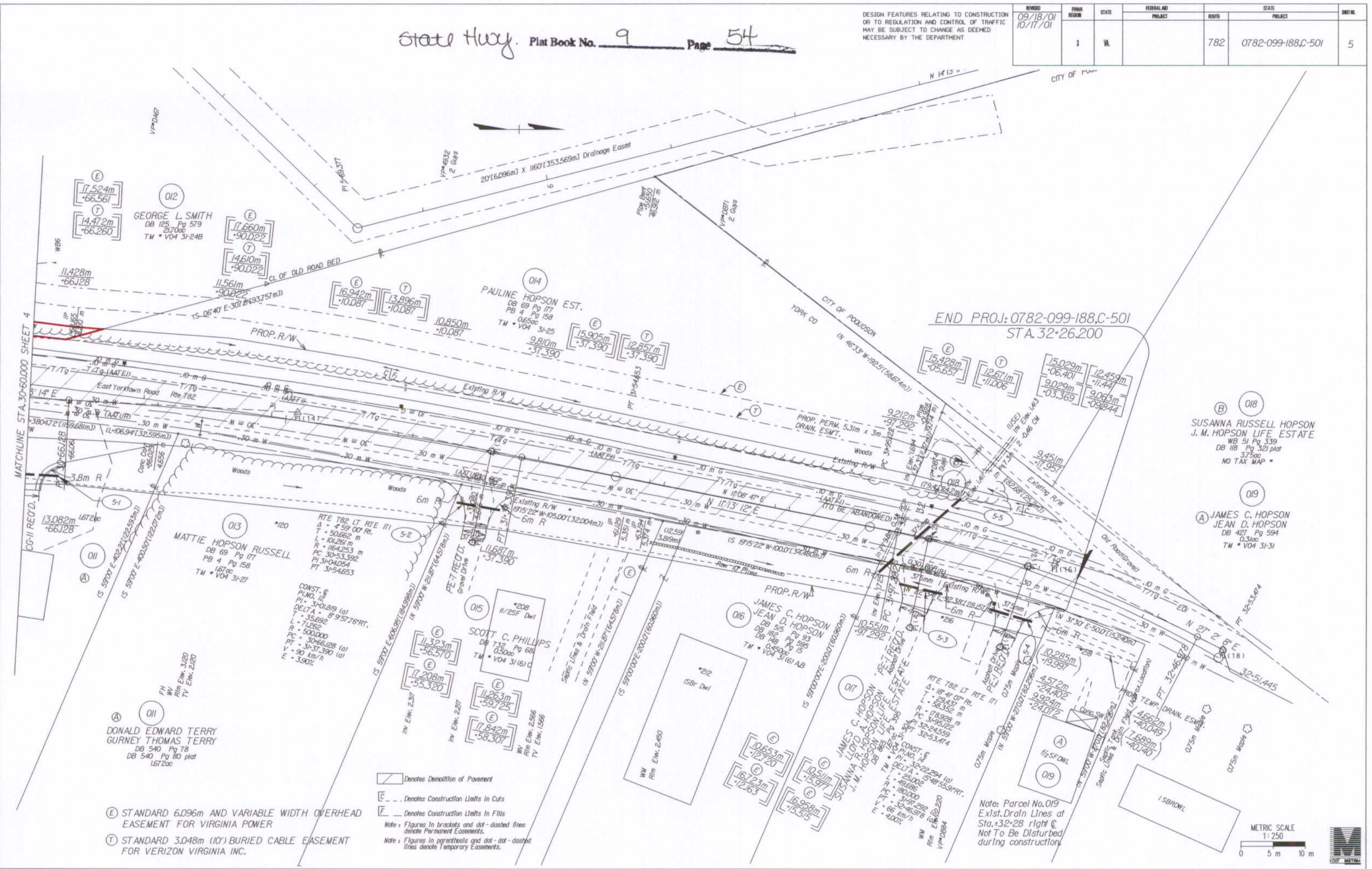

SURVEYED BY B. O. HARMON 757-253-5937 SUPERVISED BY L. K. BARTEN 757-392-5556 DESIGNED BY L. K. BARTEN 757-392-5556 CAD OPERATOR M. J. BARTEN 757-392-5556

- (E) STANDARD 6.096m AND VARIABLE WIDTH OVERHEAD EASEMENT FOR VIRGINIA POWER
- (T) STANDARD 3.048m (10') BURIED CABLE EASEMENT FOR VERIZON VIRGINIA INC.

Denotes Demolition of Pavement
 --- Denotes Construction Limits in Cuts
 --- Denotes Construction Limits in Fills
 Note: Figures in brackets and dot-dashed lines denote Permanent Easements.
 Note: Figures in parenthesis and dot-dashed lines denote Temporary Easements.

Note: Parcel No. 019 Exst. Drain Lines at Sta. 32+28 right of Way Not To Be Disturbed during construction.

