

PLAT OF SUBDIVISION
THE VILLAGES OF KILN CREEK
CORPORATE CENTER 16C
BETHEL MAGISTERIAL DISTRICT
COUNTY OF YORK, VIRGINIA

DATE: 02/01/02 SHEET 2 OF 2 SCALE: 1"=40'
PROJECT NO: 31121.00 DRAWN BY: DWP

VHB Vanasse Hangen Brustlin, Inc.
Transportation Land Development Environmental Services
11832 Rock Landing Drive, Suite 203
Newport News, Virginia 23606-4231
(757) 873-3386 • FAX (757) 873-0757

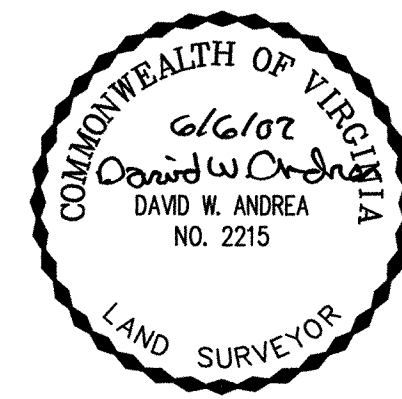

NOW OR FORMERLY
KEENERS AUTO PARTS INC.
ZONED GB
INSTRUMENT NO. 00000905
GPIN S03C-0949-0074
MAP#36-00-00-023

VILLAGE AVENUE - STATE ROUTE 1838
(60' R/W)

NOW OR FORMERLY
ADANAC SPORTS MANAGEMENT LTD
ZONED GB
D.B. 872, PG. 850
GPIN S03C-0922-0755
MAP# 36-02-16-000B

NOW OR FORMERLY
VILLAGES OF KILN CREEK
PROFESSIONAL & BUSINESS ASSOC INC
LAKE 13
ZONED GB
D.B. 1038, PG. 762
GPIN S03C-1111-0506
MAP# 36-02-16-000D

VARIABLE WIDTH DRAINAGE
EASEMENT RESERVED FOR THE
BENEFIT OF PARCEL 16C-1

15' PRIVATE DRAINAGE
EASEMENT RESERVED FOR THE
BENEFIT OF PARCEL 16C-2

EXISTING VDOT VARIABLE
WIDTH DRAINAGE EASEMENT
(P.B. 11, PG. 564-566)

PARCEL 16C-1
81,807 SQ. FT
(1.878 ACRES)

PARCEL 16C-2
92,434 SQ. FT
(2.122 ACRES)

EXISTING 20' KILN CREEK
PROFESSIONAL AND BUSINESS
ASSOCIATION, INC. LANDSCAPE
EASEMENT (P.B. 11, PG. 564-566)

VARIABLE WIDTH INGRESS/
EGRESS & UTILITY EASEMENT
RESERVED FOR THE BENEFIT
OF PARCELS 16C-1 & 16C-2

20'x20' SIGHT EASEMENT
HEREBY CONVEYED TO
THE COUNTY OF YORK

EXISTING 10' CITY
OF NEWPORT NEWS
WATERMAIN EASEMENT
(D.B. 810, PG. 540)

LEGEND

- INDICATES IRON PIN FOUND
- INDICATES IRON PIN SET
- INDICATES CONC. MON. FOUND

EXISTING 10' CITY
OF NEWPORT NEWS
WATERMAIN EASEMENT
(D.B. 810, PG. 540)

COMMONWEALTH DRIVE - STATE ROUTE 1839
(90' R/W)

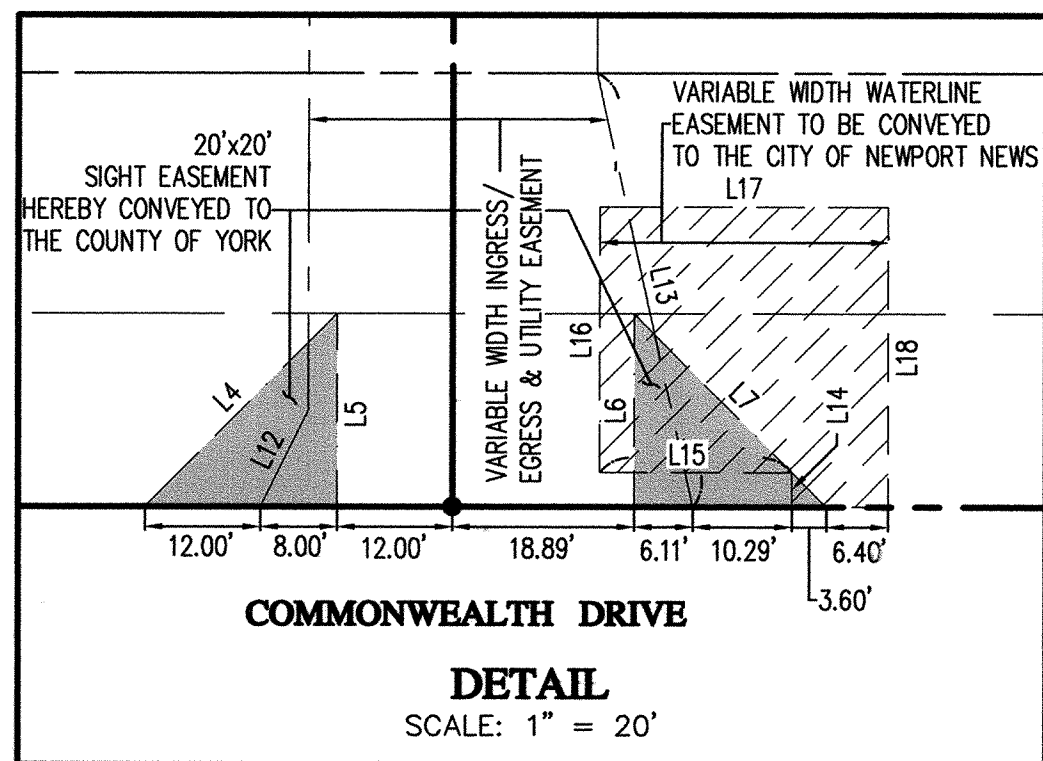
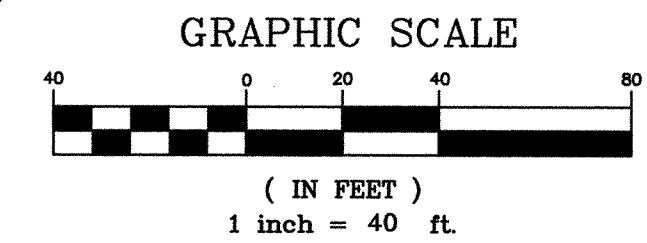

LINE	BEARING	LENGTH
L1	S30°25'04"E	37.59'
L2	S46°14'40"W	14.51'
L3	S53°22'58"W	1.19'
L4	S81°37'02"E	28.28'
L5	S53°22'58"W	20.00'
L6	N53°22'58"E	20.00'
L7	S08°22'58"W	28.28'
L8	S81°37'02"E	28.28'
L9	S53°22'58"W	20.00'
L10	S53°22'58"W	20.00'
L11	N08°22'58"E	28.28'
L12	N79°56'52"E	11.18'
L13	N40°51'14"E	46.10'

LINE	BEARING	LENGTH
L14	N53°22'58"E	3.56'
L15	N36°37'02"W	19.98'
L16	N53°22'58"E	27.50'
L17	S36°37'02"E	29.98'
L18	S53°22'58"W	31.06'
L19	N36°37'02"W	21.50'
L20	S60°29'04"E	23.51'
L21	S53°22'58"W	16.40'
L22	S60°29'04"E	7.11'
L23	N36°37'02"W	6.50'
L24	S36°37'02"E	15.00'
L25	S36°37'02"E	15.00'
L26	S36°37'02"E	30.57'

CURVE DATA TABLE						
NUMBER	RADIUS	DELTA	ARC LENGTH	TANGENT	CHORD	CHORD BEARING
C1	50.00'	92°10'23"	80.44'	51.93'	72.04'	N09°28'10"E
C2	4,109.26'	4°01'35"	288.77'	144.45'	288.72'	N57°34'09"E

APPROVED:
YORK COUNTY BOARD OF SUPERVISORS
BY: *Al Maddalena*
PLAT APPROVING AGENT
DATE: 8/1/02

STATE OF VIRGINIA
COUNTY OF YORK
IN THE CLERK'S OFFICE OF THE CIRCUIT COURT FOR
THE COUNTY OF YORK, THE 22 DAY OF AUG., 2002.
THIS MAP WAS PRESENTED AND ADMITTED TO RECORD AS
THE LAW DIRECTS AS INSTRUMENT NO. 020017150
d: 58 pm

TESTE: *Lynn S. Jenkins*
CLERK
BY: *Natalie C. Owens, D.C.*