

VICINITY MAP SCALE: 1" = 2000'

THIS BOUNDARY LINE ADJUSTMENT IS APPROVED BY THE UNDERSIGNED AND MAY BE ADMITTED TO RECORD  
*Reed T. Nish* 3/17/03  
 SUBDIVISION AGENT OF CITY OF WILLIAMSBURG / DATE  
 PLAT RECORDED IN P.B. NO. \_\_\_\_\_ PAGE \_\_\_\_\_, CITY OF WILLIAMSBURG

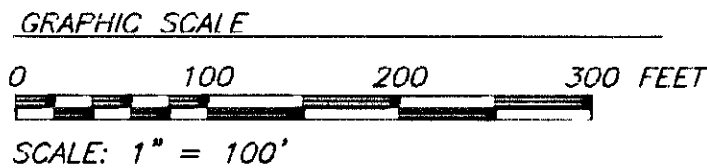

VA. STATE GRID BASED ON:  
 YORK COUNTY CONTROL MONUMENT #024  
 SEE NOTE 5

JURISDICTIONAL BOUNDARY ADJUSTMENT  
 BETWEEN  
 YORK COUNTY, VIRGINIA  
 AND  
 CITY OF WILLIAMSBURG, VIRGINIA  
 SCALE: 1" = 100' DATE: APRIL 15, 2002  
 BRUTON DISTRICT - YORK COUNTY - VIRGINIA

PRECISION MEASUREMENTS, INC.  
 SURVEYORS • GPS • GIS  
 813 DILIGENCE DRIVE, SUITE 121-E  
 NEWPORT NEWS, VIRGINIA 23606  
 (757) 595-7570 (757) 595-7571 FAX  
 SHEET 2 OF 2

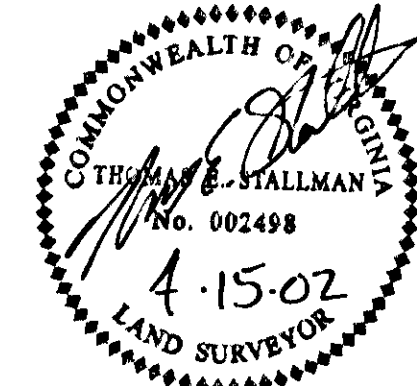

- LEGEND**
- PROPERTY LINE
  - - - RIGHT OF WAY LINE
  - - - EASEMENT
  - - - JURISDICTIONAL BOUNDARY LINE (EXISTING)
  - - - JURISDICTIONAL BOUNDARY LINE (PROPOSED)
  - IRON PIN FOUND
  - PIP FOUND
  - PIN WITH CAP FOUND (RM2)
  - ▨ DENOTES AREA TO BECOME UNDER YORK COUNTY JURISDICTION  
 AREA = 7,483 SQ. FT. OR 0.172 ACRES

**LINE TABLE (FIELD)**

LINE	BEARING	DISTANCE
L1	N 03°40'42" W	31.41'
L2	N 03°40'42" W	93.56'
L3	S 65°33'07" E	51.00'
L4	N 06°30'57" W	11.66'
L5	S 69°31'28" E	72.17'
L6	S 76°51'43" E	25.50'
L7	S 70°31'18" E	115.43'
L8	S 67°04'46" E	75.03'
L9	S 36°13'18" W	3.84'
L10	S 24°40'11" W	7.45'
L18	N 20°07'56" W	134.14'

**BYPASS ROAD U.S. ROUTE 60**  
 (VARIABLE WIDTH RIGHT OF WAY)

NOW OR FORMERLY  
 CRACKER BARREL  
 OLD COUNTRY STORE, INC.  
 D.B. 528, PG. 491  
 GPIN D15C-1670-1946  
 T.M. #09-09-00-001

NOW OR FORMERLY  
 GREEN LANE, INC.  
 D.B. 455, PG. 311  
 P.B. 8, PG. 171  
 GPIN D15C-1307-2055  
 T.M. #09-00-00-006

NOW OR FORMERLY  
 HORNSBY LAND COMPANY  
 D.B. 177, PG. 654  
 GPIN D15C-1545-1450  
 T.M. #09-09-00-002

NOW OR FORMERLY  
 RALPH M. GOLDSTEIN,  
 ET UX, ET AL  
 D.B. 1078, PG. 567  
 INSTRUMENT NO. 010018170  
 P.B. 11, PG. 398 - J.C.C.  
 GPIN D15C-1018-2300  
 T.M. #09-00-00-004A

NOW OR FORMERLY  
 SOUTHERN STATES  
 COOPERATIVE, INC.  
 D.B. 207, PG. 63  
 INSTRUMENT NO. 010018170  
 P.B. 11, PG. 398 - J.C.C.  
 GPIN D15C-1135-2170  
 T.M. #09-00-00-005

NOW OR FORMERLY  
 RMG BYPASS  
 ROAD, L.L.C.  
 INSTRUMENT NO. 000003340  
 D.B. 313, PG. 500 - PLAT  
 GPIN D15C-0873-2454  
 T.M. #09-00-00-004

**CURVE TABLE (FIELD)**

CURVE	RADIUS	ARC LENGTH	DELTA ANGLE	TANGENT	CHORD LENGTH	CHORD BEARING
C1	1909.86'	134.37'	04°01'52"	67.21'	134.35'	S 67°53'51" E
C2	5705.60'	191.09'	01°55'08"	95.55'	191.08'	N 28°07'25" W
C3	5705.60'	236.04'	02°22'13"	118.04'	236.02'	N 25°58'45" W
C4	5705.60'	239.12'	02°24'05"	119.58'	239.10'	N 23°35'36" W
C5	5705.60'	79.18'	00°47'43"	39.59'	79.18'	N 21°59'42" W
C6	5695.60'	694.89'	06°59'25"	347.88'	694.46'	N 25°35'19" W

**CURVE TABLE (PLAT/DEED)**

CURVE	RADIUS	ARC LENGTH	DELTA ANGLE	TANGENT	CHORD LENGTH	CHORD BEARING
C1	1909.86'	134.36'	04°01'44"	-	134.35'	S 61°09'40" E
C2	5705.6'	190.5'	01°56'45"	-	-	-
C3	5705.60'	240.02'	02°24'37"	120.03'	240.00'	N 22°18'39" W
C4	5705.60'	235.00'	02°21'35"	-	235.00'	N 24°14'24" W

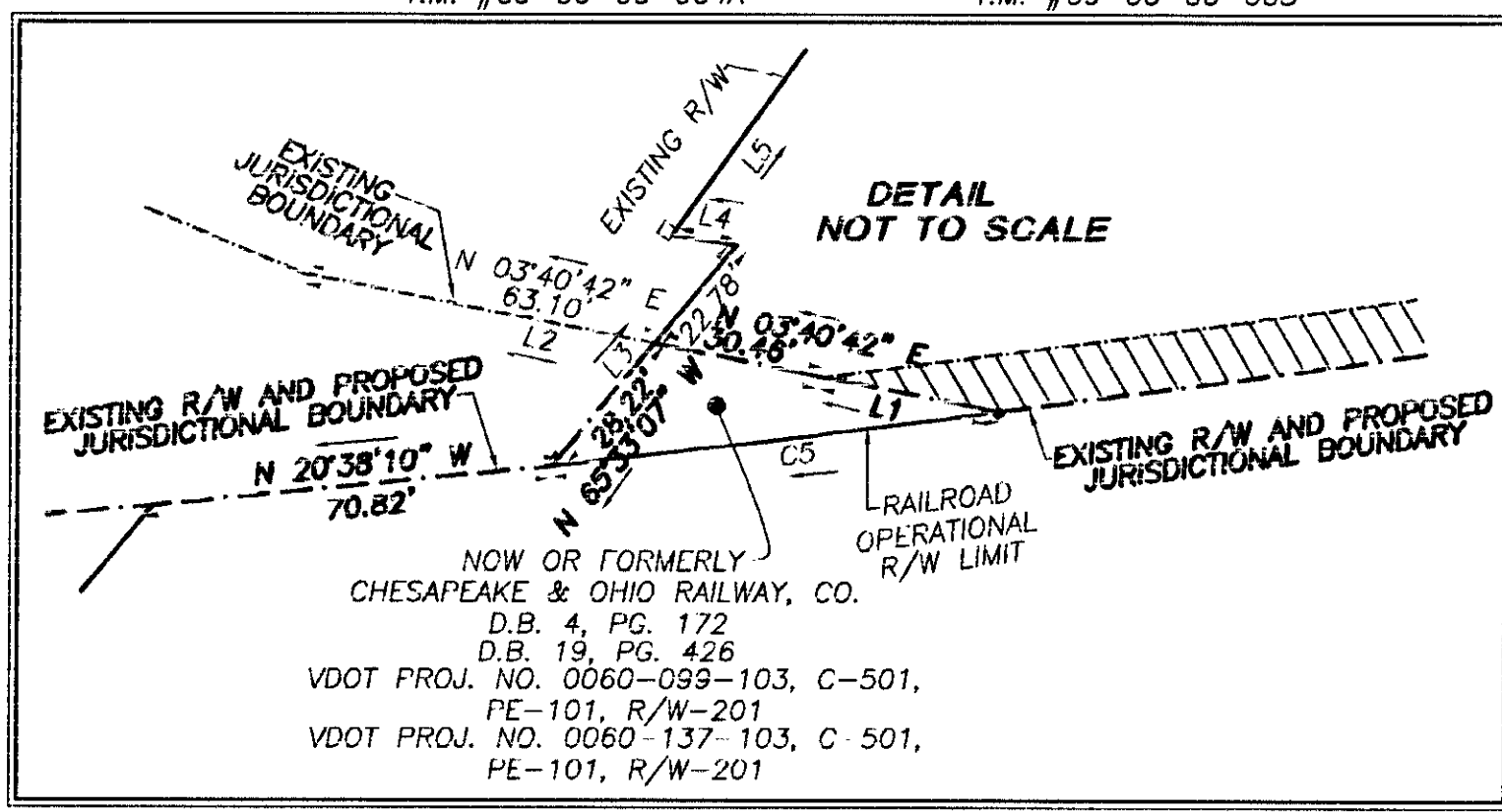

FLOOD ZONE NOTE:  
 PROPERTY APPEARS TO BE IN ZONE X; ON COMMUNITY PLAN 510182-0025B, MAP DATED DECEMBER 16, 1988.

REVISED: 9/10/02 AS PER YORK COUNTY COMMENTS

- NOTES:**
- PROPERTY LINE INFORMATION IS BASED ON VARIOUS PLATS AND DEEDS OF RECORD AND ACTUAL FIELD MEASUREMENTS. EXISTING RIGHT OF WAY INFORMATION IS BASED ON VARIOUS PLATS AND DEEDS OF RECORD AND ACTUAL FIELD MEASUREMENTS.
  - THIS PLAT WAS PREPARED WITHOUT THE BENEFIT OF A TITLE REPORT, AND DOES NOT SHOW ALL PHYSICAL IMPROVEMENTS, NOR ALL EASEMENTS AND RESTRICTIONS THAT MAY AFFECT THE PROPERTY.
  - THIS SURVEY DOES NOT CONSTITUTE A SUBDIVISION OF LAND.
  - THIS PLAT IS INTENDED FOR THE SOLE PURPOSE OF THE JURISDICTIONAL BOUNDARY ADJUSTMENT. NO CONVEYANCE OF TITLE SHALL OCCUR BY THIS INSTRUMENT.
  - COUNTY OF YORK SURVEY MARK, STATION 024, HAS BEEN DESTROYED. THE REFERENCE MARKS SHOWN ON THE COUNTY REFERENCE AND RECOVERY DATA SHEET WERE USED.

APPROVED:  
 YORK COUNTY BOARD OF SUPERVISORS  
 BY: *Al Maddalena* PLAT APPROVING AGENT  
 DATE: 3/12/03  
 STATE OF VIRGINIA  
 COUNTY OF YORK

IN THE CLERK'S OFFICE OF THE CIRCUIT COURT FOR THE COUNTY OF YORK THE 17th DAY OF 3rd, 2003 THIS MAP WAS PRESENTED AND ADMITTED TO RECORD AS THE LAW DIRECT AS INSTRUMENT NO. 03001748a  
 TESTE: *Lynn S. Jenkins* CLERK 10:11 am  
 BY: *Shelia Crown D.C.*