

PLAT INSTRUMENT #030021817

PLAT OF
A PORTION OF
SHADY BANKS FARM
CONTAINING APPROXIMATELY 63.8± ACRES

BETHEL DISTRICT - COUNTY OF YORK, VIRGINIA
SCALE: 1" = 200' JUNE 25, 2003
(PROP. REF.: D.B.54, P.107; D.B.968, PGS.532-550)

0 100 200 400 600 800 FEET

GRAPHIC SCALE

THE SIRINE GROUP, LTD.

SURVEYORS • ENGINEERS • PLANNERS
4794 GEORGE WASHINGTON MEMORIAL HIGHWAY
U.S. ROUTE 17
P.O. BOX 450
WHITE MARSH, VIRGINIA 23183
(804) 693-9548

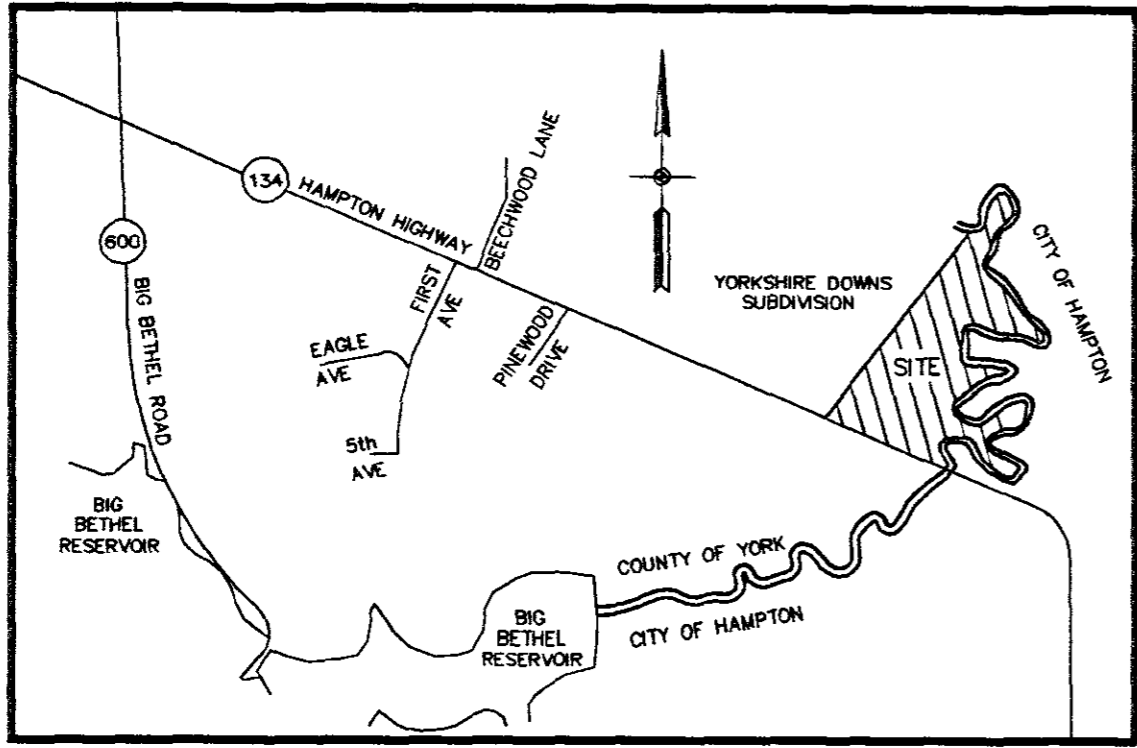

VICINITY MAP
SCALE: 1" = 2,000'

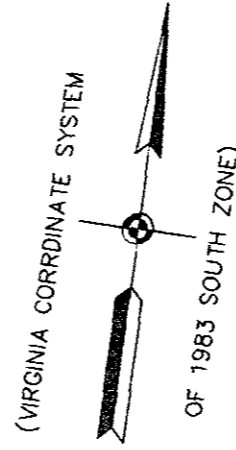

SURVEYOR'S CERTIFICATE

I HEREBY CERTIFY THAT THIS SURVEY, TO THE BEST OF MY KNOWLEDGE AND BELIEF, IS CORRECT AND COMPLIES WITH THE MINIMUM PROCEDURES AND STANDARDS ESTABLISHED BY THE VIRGINIA BOARD OF ARCHITECTS, PROFESSIONAL ENGINEERS, LAND SURVEYORS, AND CERTIFIED LANDSCAPE ARCHITECTS.

SIGNED: *James S. Leigh* DATE: 7/11/2003
JAMES S. LEIGH, L.S. # 1758



THE PROPERTY AS DEPICTED ON THIS PLAT DOES NOT VIOLATE THE PROVISIONS OF THE YORK COUNTY SUBDIVISION ORDINANCE
SIGNED: *Al Madalena*
TITLE: Chief of Development & Compliance
DATE: 7/11/03

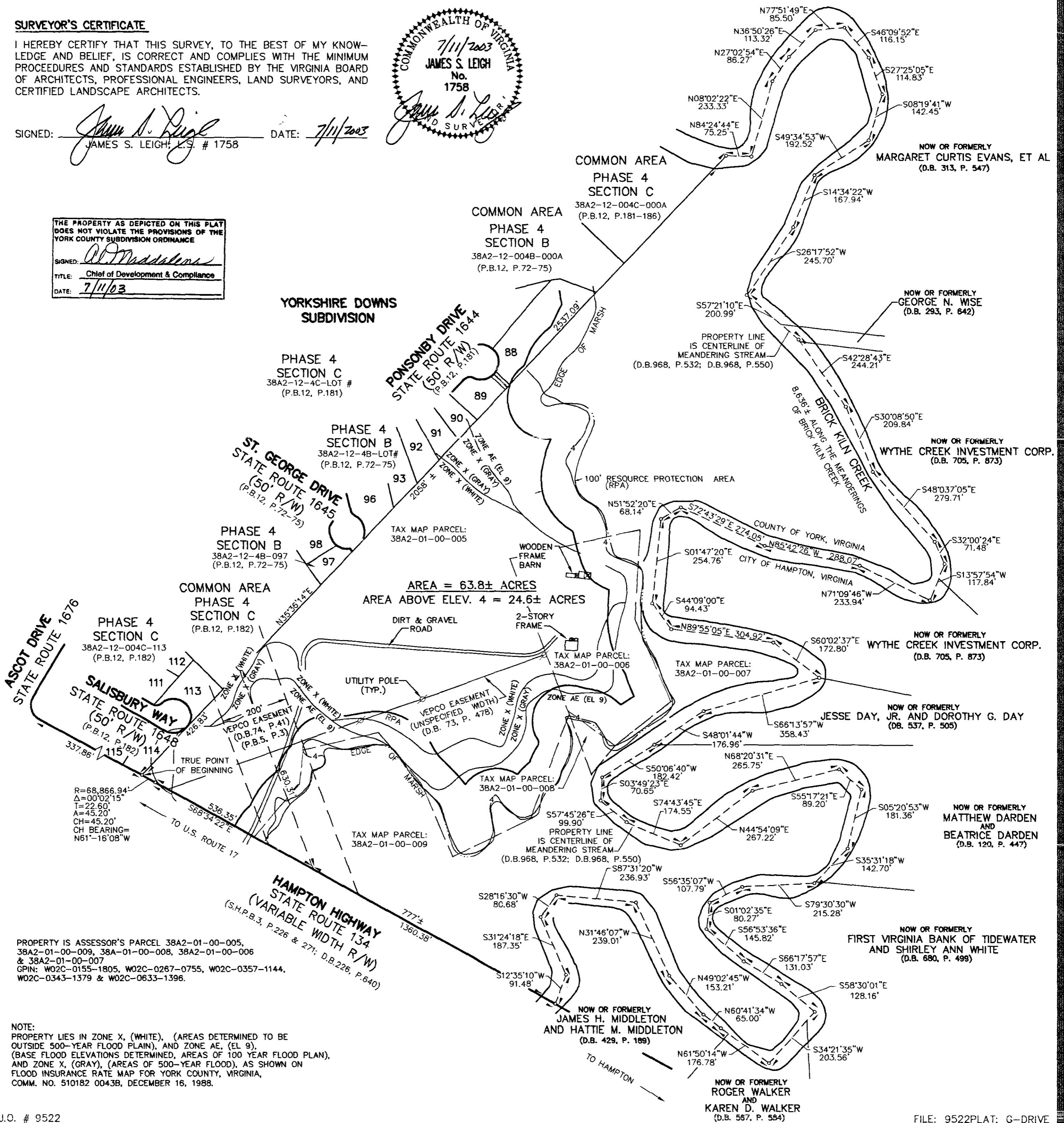

PROPERTY IS ASSESSOR'S PARCEL 38A2-01-00-005, 38A2-01-00-009, 38A-01-00-008, 38A2-01-00-006 & 38A2-01-00-007
GPIN: W02C-0155-1805, W02C-0267-0755, W02C-0357-1144, W02C-0343-1379 & W02C-0633-1396.

NOTE:
PROPERTY LIES IN ZONE X, (WHITE), (AREAS DETERMINED TO BE OUTSIDE 500-YEAR FLOOD PLAIN), AND ZONE AE, (EL 9), (BASE FLOOD ELEVATIONS DETERMINED, AREAS OF 100 YEAR FLOOD PLAN), AND ZONE X, (GRAY), (AREAS OF 500-YEAR FLOOD), AS SHOWN ON FLOOD INSURANCE RATE MAP FOR YORK COUNTY, VIRGINIA, COMM. NO. 510182 0043B, DECEMBER 16, 1988.