

EXHIBIT A CONDOMINIUM PLAT OF MICHAEL COMMONS - PHASE ONE

BRUTON DISTRICT YORK COUNTY, VIRGINIA
DATE: 04/07/03 SCALE: 1"=40'

Richard

Rickmond Engineering, Inc.

Engineering Surveying Land Planning
1643 Merrimac Trail Williamsburg, VA 23185
Voice: (757)229-1776 Fax: (757)229-4683
Vint Hill • P.O. Box 861647
Warrenton, VA 20187
Voice: (540)349-7730 Fax: (540)349-7731

www.rickmond.com **Sheet 2**

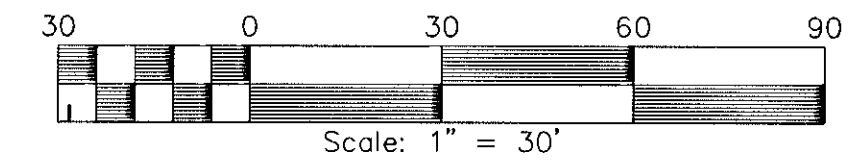

REVISED: 6/20/03 **DETAIL**

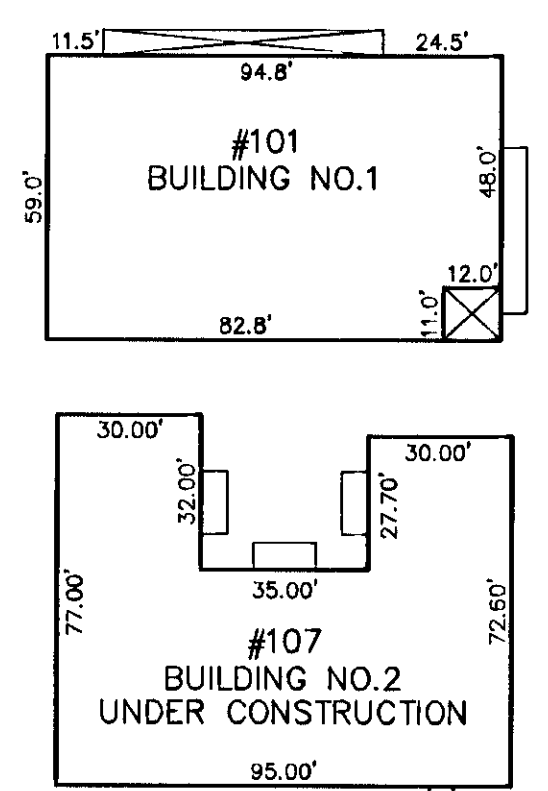

N/F
BULIFANTS LP
(DB 433 PG 163)
TAX PARCEL 02-00-00-034

N/F
BULIFANTS LP
(DB 433 PG 163)
TAX PARCEL 02-00-00-034

APPROVED: YORK COUNTY BOARD OF SUPERVISORS
BY: *Al Maddalena* DATE: *7/19/03*
PLAT APPROVING AGENT

STATE OF VIRGINIA
COUNTY OF YORK
IN THE CLERK'S OFFICE OF THE CIRCUIT COURT FOR THE
COUNTY OF YORK THIS *18th* DAY OF *July* 2003.
THIS MAP WAS PRESENTED AND ADMITTED TO RECORD
AS LAW THE DIRECTS AS INSTRUMENT NO. *030021939* 9.36am

TESTE: *Lynn S. Jenkins, Clerk*
CLERK
BY: *Lisa Brogden, P.C.*

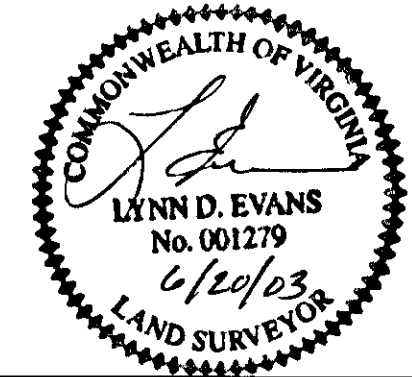

BULIFANTS BLVD.
(100' R/W)

VA STATEPLANE (SOUTH ZONE)

MOORETOWN ROAD
STATE ROUTE 903
(VARIABLE WIDTH R/W)

EXISTING
10' YORK COUNTY
RESTRICTED ACCESS
EASEMENT
(INST. NO. 020008861)

