

PG0019 AUG-6

03rd OLD RAILWAY ROAD

RAILWAY ROAD STATE ROUTE 620 50' R/W

TOTAL
Δ=23°38'30"
R=929.93'
A=383.70'
T=194.62'
CH=380.99'
BRG=N 44°25'10" E

50' R/W

N. or F.
WALTER FAY PRESSON
TAX MAP # 25-35-00-000G2

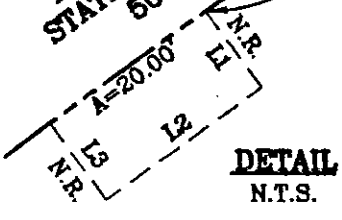

ⓐ
L=31.02'
R=929.93'
Δ=01°54'40"
CH=31.01'
BRG=N 55°16'58" E

RAILWAY ROAD STATE ROUTE 620 50' R/W

SEE NOTE "A"

Tax Map No. 25-486A
GPIN T078-3806-3296

S 75°45'53" W

N. or F.
DELMA P. BRISTOW, TRUSTEE
INST. NO. 020007462
TAX MAP # 25-00-00-485

LINE	BEARING	DISTANCE
L1	S 36°17'20" E	10.00'
L2	S 53°42'40" W	20.00'
L3	N 36°17'20" W	10.00'

NOTE "A": UTILITY EASEMENT HEREBY CONVEYED TO THE COUNTY OF YORK. 200± S.F. or 0.0005 Ac. (SEE DETAIL)

YORK COUNTY APPROVED FOR RECORDATION
BY: *J. B. Anguette*
TITLE: *Right-of-Way Agent*
DATE: *July 31, 2003*

NOTES:
THIS PROPERTY IS LOCATED IN FIRM ZONE X, (AREA OF 500-YEAR FLOOD PLAIN) AS SHOWN ON COMMUNITY PANEL NO. 510182 0037 B DATED DECEMBER 18, 1988

NO TITLE REPORT PROVIDED

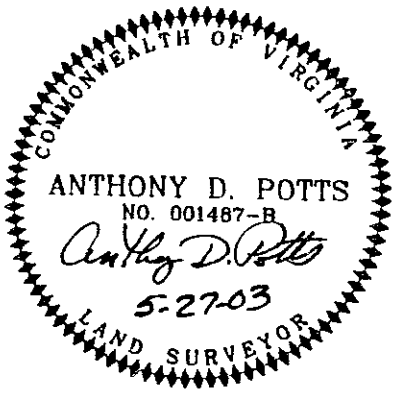

#214 RAILWAY ROAD

PLAT OF EASEMENT DEDICATION

FROM: ROBERT GEORGE HOLIHAN III & DAWN MARIE HOLIHAN
TO: COUNTY OF YORK, VIRGINIA
REF: INST.# 020017857

GRAFTON DISTRICT YORK COUNTY, VIRGINIA

ADPA A.D. POTTS & ASSOCIATES, INC.
11524 JEFFERSON AVENUE
NEWPORT NEWS, VIRGINIA 23601
PHONE: (757)-595-4610
SCALE: 1"=40'

DATE: 5/27/03

RECORD PLAT
PLAT INSTRUMENT # 03002437