

EXHIBIT "C"

PLAT OF VILLAS ON SHADY BANKS A CONDOMINIUM PHASE VII

(PROP. REF.: D.B. 54, P.107; D.B. 988, PGS.532-550) (INSTR. #050004843; INSTR. #030021817) SHEET 2 OF 5

BETHEL DISTRICT - COUNTY OF YORK, VIRGINIA SCALE: 1" = 100' FEBRUARY 10, 2006

GRAPHIC SCALE JOHN E. SIRINE AND ASSOCIATES, LTD. SURVEYORS • ENGINEERS • PLANNERS

4317 BONNEY ROAD VIRGINIA BEACH, VIRGINIA 23452 TELE: (757) 486-4910 FAX: (757) 486-4607

REVISED: MARCH 20, 2006 REVISED: APRIL 17, 2006

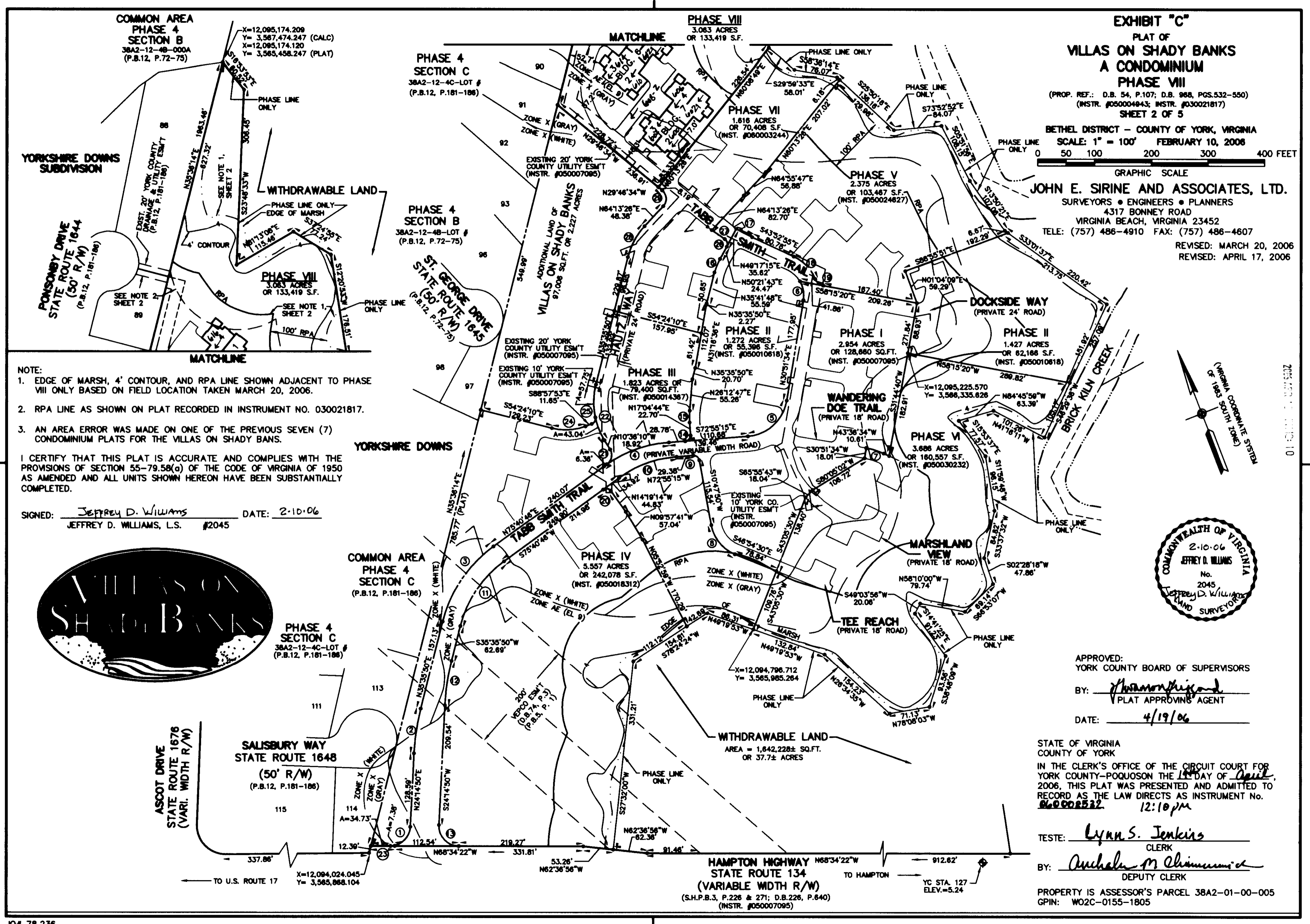

- NOTE:
- EDGE OF MARSH, 4' CONTOUR, AND RPA LINE SHOWN ADJACENT TO PHASE VIII ONLY BASED ON FIELD LOCATION TAKEN MARCH 20, 2006.
 - RPA LINE AS SHOWN ON PLAT RECORDED IN INSTRUMENT NO. 030021817.
 - AN AREA ERROR WAS MADE ON ONE OF THE PREVIOUS SEVEN (7) CONDOMINIUM PLATS FOR THE VILLAS ON SHADY BANS.

I CERTIFY THAT THIS PLAT IS ACCURATE AND COMPLIES WITH THE PROVISIONS OF SECTION 55-79.58(a) OF THE CODE OF VIRGINIA OF 1950 AS AMENDED AND ALL UNITS SHOWN HEREON HAVE BEEN SUBSTANTIALLY COMPLETED.

SIGNED: JEFFREY D. WILLIAMS DATE: 2-10-06
JEFFREY D. WILLIAMS, L.S. #2045



APPROVED: YORK COUNTY BOARD OF SUPERVISORS
BY: [Signature] PLAT APPROVING AGENT
DATE: 4/19/06

STATE OF VIRGINIA COUNTY OF YORK
IN THE CLERK'S OFFICE OF THE CIRCUIT COURT FOR YORK COUNTY-POQUOSON THE 19th DAY OF April, 2006, THIS PLAT WAS PRESENTED AND ADMITTED TO RECORD AS THE LAW DIRECTS AS INSTRUMENT NO. 060002532 12:10pm

TESTE: Lynn S. Jenkins CLERK
BY: Anchela M. Chinnici DEPUTY CLERK

PROPERTY IS ASSESSOR'S PARCEL 38A2-01-00-005 GPIN: WO2C-0155-1805