

EXHIBIT "C"

PLAT OF VILLAS ON SHADY BANKS A CONDOMINIUM PHASE IX

(PROP. REF.: D.B. 54, P.107; D.B. 968, PGS.532-550) (INSTR. #050004943; INSTR. #030021817) SHEET 2 OF 4

BETHEL DISTRICT - COUNTY OF YORK, VIRGINIA

SCALE: 1" = 100' MARCH 20, 2006

GRAPHIC SCALE 0 50 100 200 300 400 FEET

GRAPHIC SCALE

JOHN E. SIRINE AND ASSOCIATES, LTD.

SURVEYORS • ENGINEERS • PLANNERS

4317 BONNEY ROAD

VIRGINIA BEACH, VIRGINIA 23452

TELE: (757) 486-4910 FAX: (757) 486-4607

REVISED: MAY 18, 2006

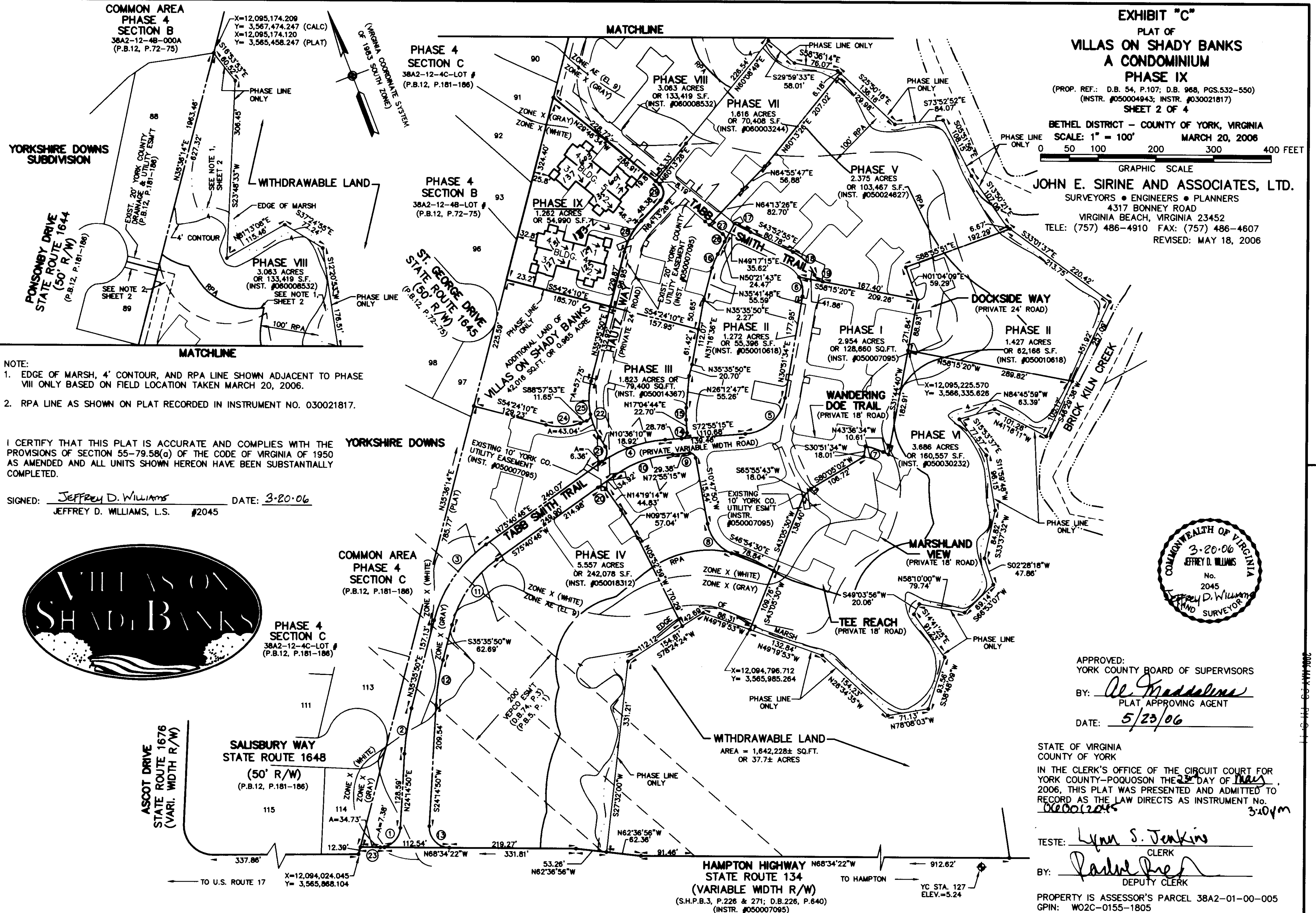

NOTE:
1. EDGE OF MARSH, 4' CONTOUR, AND RPA LINE SHOWN ADJACENT TO PHASE VIII ONLY BASED ON FIELD LOCATION TAKEN MARCH 20, 2006.
2. RPA LINE AS SHOWN ON PLAT RECORDED IN INSTRUMENT NO. 030021817.

I CERTIFY THAT THIS PLAT IS ACCURATE AND COMPLIES WITH THE PROVISIONS OF SECTION 55-79.58(a) OF THE CODE OF VIRGINIA OF 1950 AS AMENDED AND ALL UNITS SHOWN HEREON HAVE BEEN SUBSTANTIALLY COMPLETED.

SIGNED: Jeffrey D. Williams DATE: 3-20-06
JEFFREY D. WILLIAMS, L.S. #2045

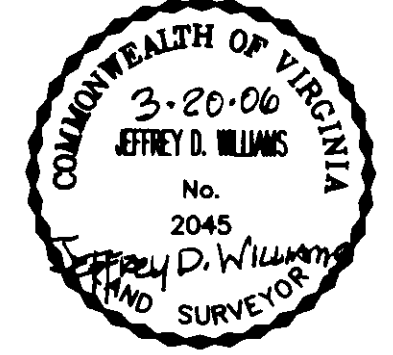

APPROVED:
YORK COUNTY BOARD OF SUPERVISORS
BY: Al. Maddalena
PLAT APPROVING AGENT
DATE: 5/23/06

STATE OF VIRGINIA
COUNTY OF YORK
IN THE CLERK'S OFFICE OF THE CIRCUIT COURT FOR YORK COUNTY-POQUOSON THE 23 DAY OF May, 2006, THIS PLAT WAS PRESENTED AND ADMITTED TO RECORD AS THE LAW DIRECTS AS INSTRUMENT NO. 06002045 3:04pm

TESTE: Lynn S. Jenkins
CLERK
BY: Patrick [Signature]
DEPUTY CLERK

PROPERTY IS ASSESSOR'S PARCEL 38A2-01-00-005
GPIN: WO2C-0155-1805