

SURVEYED BY - B.B. HARRISON (151) 253-5131
SUPERVISED BY - P.H. BYRUM (151) 925-2557
DESIGNED BY - J.D. WINSTEAD (151) 925-2556
HAMPTON ROADS DISTRICT DESIGN UNIT

DESIGN FEATURES RELATING TO CONSTRUCTION OR TO REGULATION AND CONTROL OF TRAFFIC MAY BE SUBJECT TO CHANGE AS DEEMED NECESSARY BY THE DEPARTMENT

REVISED 12/09/05 02/06/06 03/23/06 06/08/06	STATE VA.	FEDERAL AID PROJECT	ROUTE 17	STATE PROJECT 6017-099-129, RW-201, C-501	SHEET NO. 13
---	--------------	------------------------	-------------	---	-----------------

THESE PLANS ARE UNFINISHED AND ARE NOT TO BE USED FOR ANY TYPE OF CONSTRUCTION.

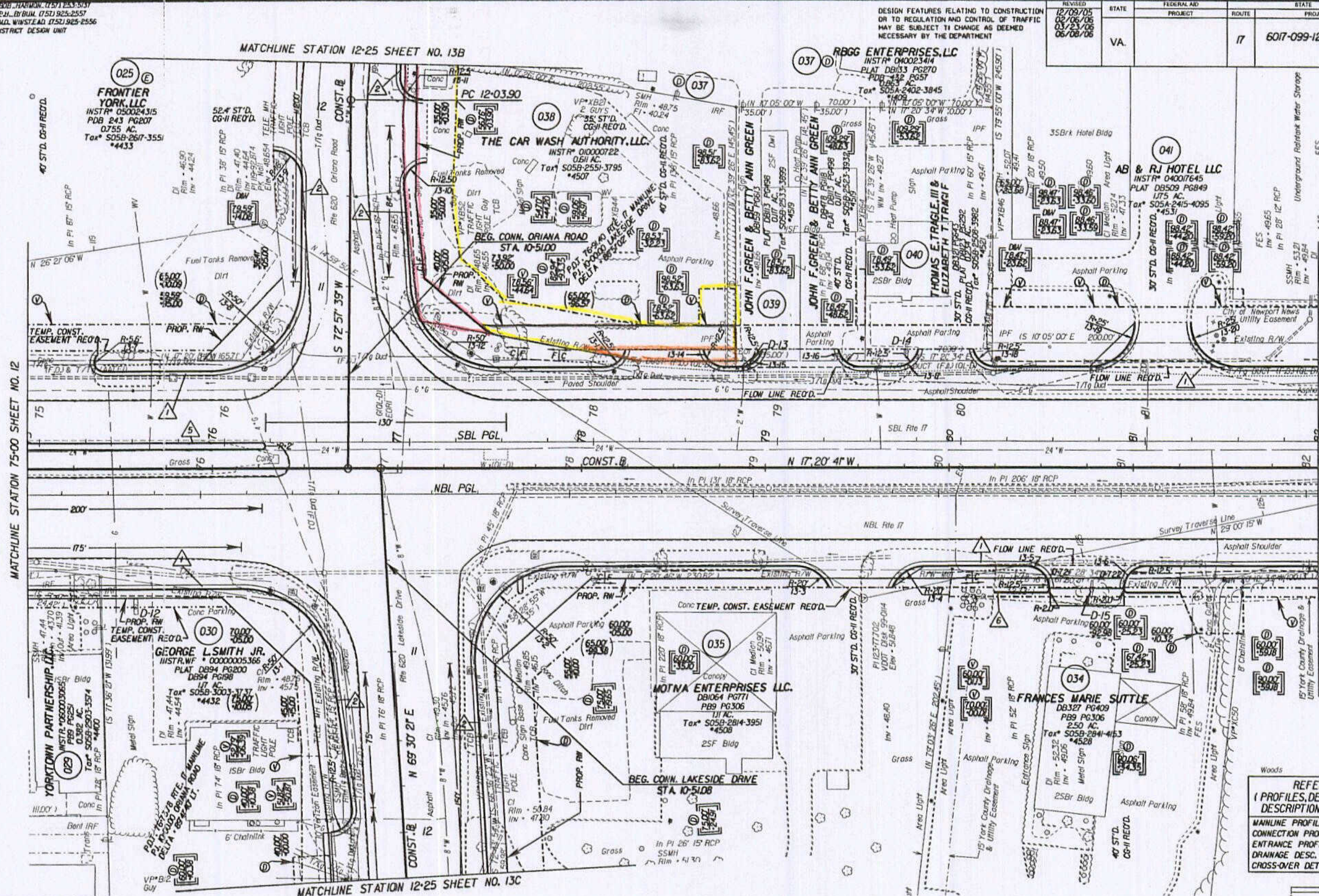

MATCHLINE STATION 75-00 SHEET NO. 12

MATCHLINE STATION 12-25 SHEET NO. 13B

MATCHLINE STATION 12-25 SHEET NO. 13C

MATCHLINE STATION 82-00 SHEET NO. 14

NOTE: PGL DENOTES PROFILE GRADE LINE
NOTE: SEE GENERAL NOTES FOR E&S LEGEND
○ DENOTES DRAINAGE STRUCTURE NUMBER

Note: Figures in brackets and dot-dashed lines denote Permanent Easements.
① Denotes variable easement required for Verizon Virginia
② Denotes variable easement required for Dominion Virginia Power

Note: Figures in parentheses and dot-dashed lines denote Temporary Easements.
E..... Denotes Construction Limits in Cuts
E..... Denotes Construction Limits in Fills

▲ ST'D. CG-7 REO'D. ▲ ST'D. MS-1A REO'D.
▲ ST'D. CG-6 REO'D. ▲ ST'D. CG-3 REO'D.

REFERENCES
(PROFILES, DETAIL & DRAINAGE DESCRIPTION SHEETS, ETC.)

MAINLINE PROFILES	13A
CONNECTION PROFILES	13D
ENTRANCE PROFILES	24D, E, I, J
DRAINAGE DESC.	2H(1) - 2H(7)
CROSS-OVER DETAIL	2E



PLAN NO.	PROJECT	FILE NO.	SHEET NO.
	6017-099-129		13

doc. instr # 060028981 Plat Book No. 9 Page 281

7/16/2006