

PLAT INSTRUMENT # 160007164

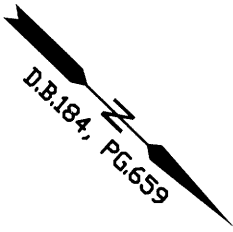

Filed in the Clerk's Office, Circuit Court,  
York County - Poquoson, VA  
the 4th day of May, 2016  
Teste: Kriston N. Neilson, Clerk 8:32 AM  
By: J. Parker D.C.

YORK COUNTY  
APPROVED FOR RECORDATION  
BY: [Signature]  
CHIEF OF DEVELOPMENT & COMPLIANCE  
DATE: 5/2/16

1152 SPRINGFIELD RD.  
DANIEL JACKSON & GERALINE JACKSON  
D.B.231, PG.344  
TAX MAP# 11-00-00-126  
GPIN: 114c-1376-2255  
ZONED RR

PARCEL 1  
1150 SPRINGFIELD RD.  
VERMA S. LEWIS,  
SHURYL M. POWELL  
AND ALBERTA D. TALIAFERRO  
INST.# 000022237  
D.B.184, PG.657  
TAX MAP# 11-00-00-125  
GPIN: 114c-1310-2360  
1.1708 ACRES  
ZONED RR

NEW  
PARCEL 1-A  
60,787 SQ.FT.  
1.3955 ACRES

EXIST.  
RESIDENCE

PARCEL 2  
1144 SPRINGFIELD RD.  
VERMA S. LEWIS,  
SHURYL M. POWELL  
AND ALBERTA D. TALIAFERRO  
INST.# 000022237  
D.B.184, PG.657  
TAX MAP# 11-00-00-124  
GPIN: 114c-1270-2425  
0.2247 ACRES  
ZONED RR

1134 SPRINGFIELD RD.  
ROGER D. HOWELL &  
LINDA P. HOWELL, TRUSTEES  
D.B.933, PG.891  
TAX MAP# 11-00-00-123  
GPIN: 114a-1099-2592  
ZONED RR

- NOTES:
- SURVEY PREPARED WITHOUT BENEFIT OF A TITLE REPORT
  - FLOOD INSURANCE RATE MAP ZONE: X
  - PANEL NO. 0044D
  - COMMUNITY NO. 510182
  - PANEL DATE: 1-16-15
  - INDEX DATE: 1-16-15
  - MAP: 51199C0044D

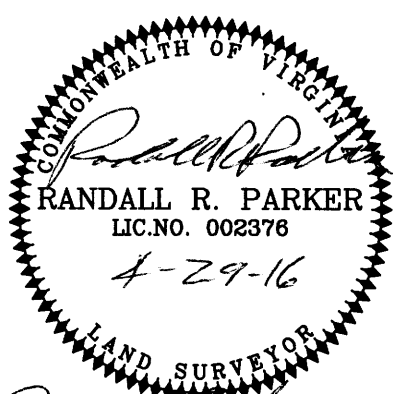

I, [Signature] HEREBY CERTIFY THAT THE PROPERTY SHOWN ON THIS PLAT WAS SURVEYED ON THIS DATE AND IS CORRECT TO THE BEST OF MY KNOWLEDGE AND BELIEF.

PARKER SURVEYING INC.  
6858 MICHAEL LANE  
HAYES, VIRGINIA 23072  
PHONE: 804-684-0600

# 1150 SPRINGFIELD ROAD SHEET 2 OF 2

PROPERTY LINE VACATION PLAT  
OF PROPERTY OWNED BY  
VERMA S. LEWIS, SHURYL M. POWELL & ALBERTA D. TALIAFERRO  
NEW PARCEL 1-A  
BEING  
PARCELS 1 & 2, D.B.184, PG.659  
BRUTON DISTRICT, YORK COUNTY, VIRGINIA

JOB #: 16-086	DRAWN: RRP	F.B.-PG: 52-4	TO: BAKER	SCALE: 1" = 50'	DATE: 4-21-16
------------------	---------------	------------------	--------------	--------------------	------------------

