

VIRGINIA ELECTRIC & POWER CO.
 Proposed Line
 TRANSMISSION LINE
 PLAT TO ACCOMPANY RIGHT-OF-WAY AGREEMENT
 DISTRICT: V.D. McMuris
 COUNTY: York
 STATE: Va
 SCALE: 1 INCH = 20 FT
 DATE: 3-11-30
 SURVEYED BY: Wbg-M-W-16-5

DRAWER NO. SHEET NO.

70

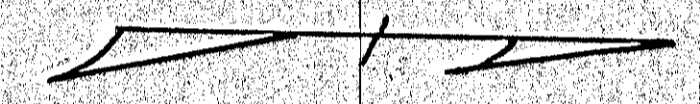
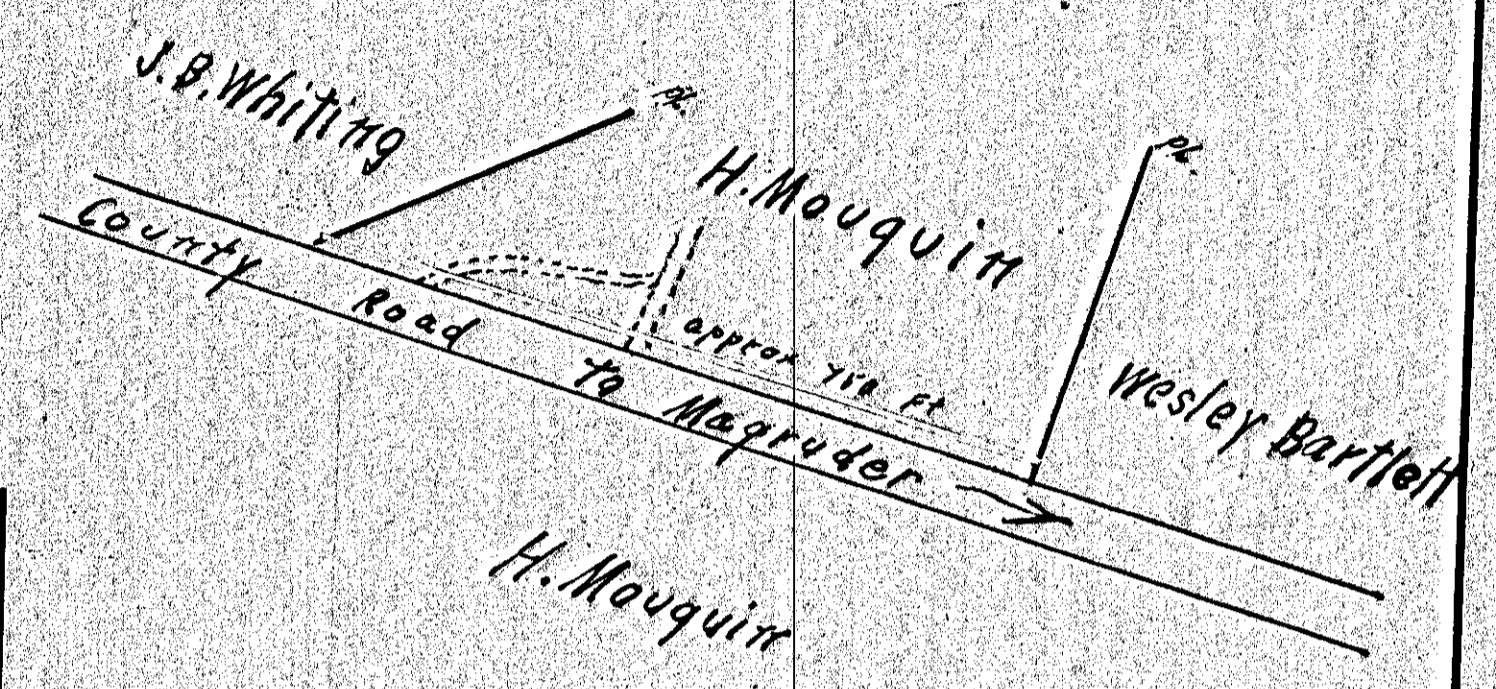

VIRGINIA ELECTRIC & POWER CO.
 Proposed Line
 TRANSMISSION LINE
 PLAT TO ACCOMPANY RIGHT-OF-WAY AGREEMENT
 DISTRICT: H. Moquin
 COUNTY: York
 STATE: Va
 SCALE: 1 INCH = 20 FT
 DATE: 3-11-30
 SURVEYED BY: Wbg-M-W-16-2

SHEET NO.

68

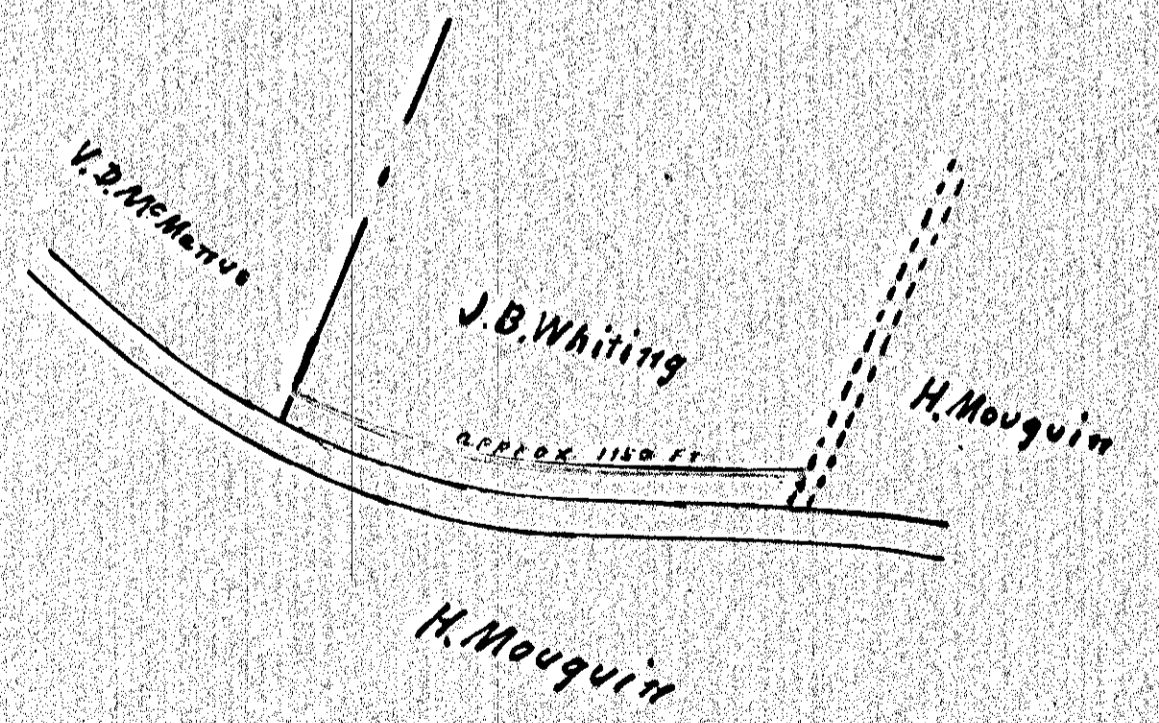

VIRGINIA ELECTRIC & POWER CO.
 Proposed Line
 TRANSMISSION LINE
 PLAT TO ACCOMPANY RIGHT-OF-WAY AGREEMENT
 DISTRICT: J.B. Whiting
 COUNTY: York
 STATE: Va
 SCALE: 1 INCH = 20 FT
 DATE: 3-11-30
 SURVEYED BY: Wbg-M-W-16-6

DRAWER NO. SHEET NO.

71

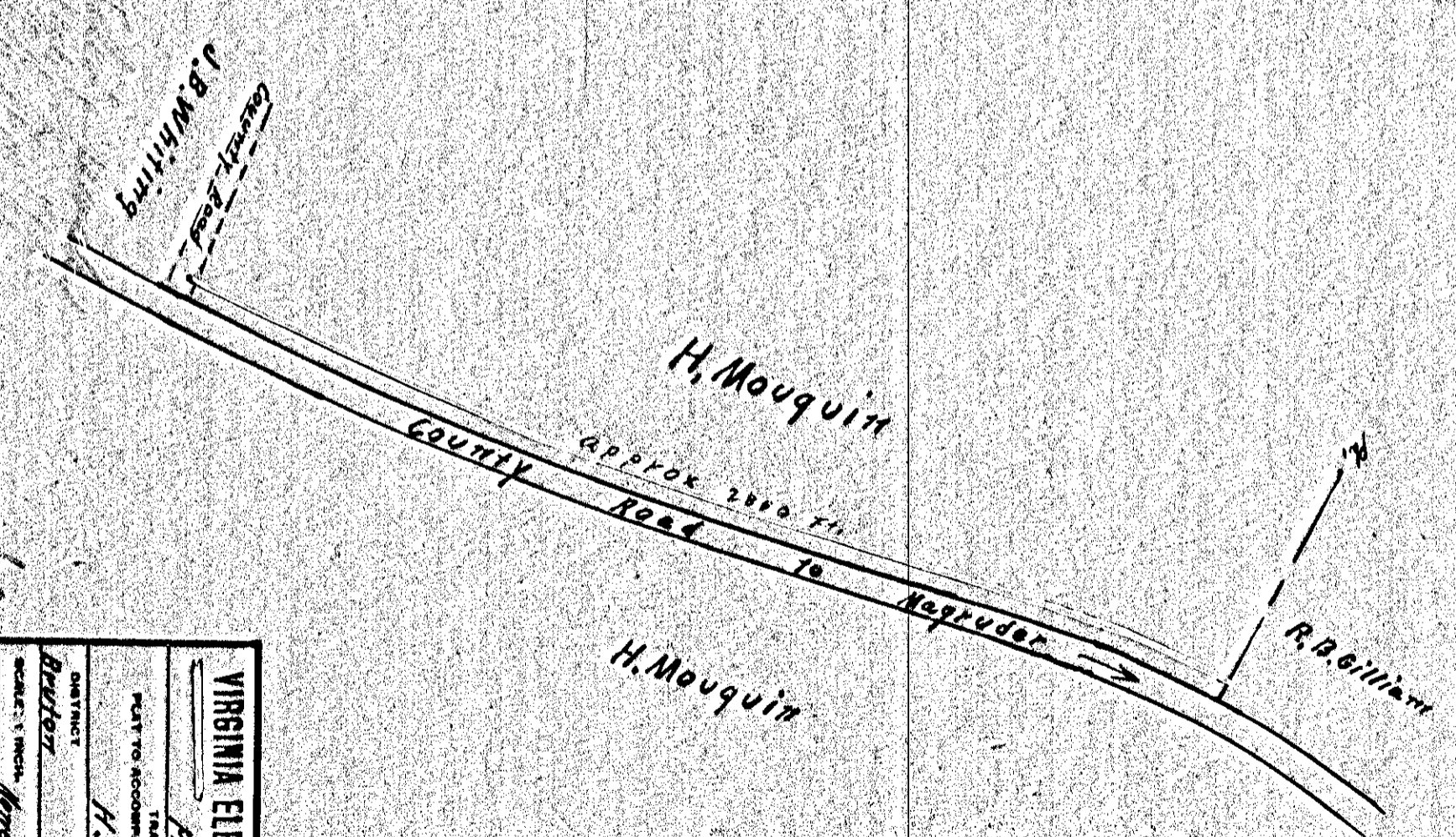

VIRGINIA ELECTRIC & POWER CO.
 Proposed Line
 TRANSMISSION LINE
 PLAT TO ACCOMPANY RIGHT-OF-WAY AGREEMENT
 DISTRICT: H. Moquin
 COUNTY: York
 STATE: Va
 SCALE: 1 INCH = 20 FT
 DATE: 3-11-30
 SURVEYED BY: Wbg-M-W-16-7

DRAWER NO. SHEET NO.

69