

103

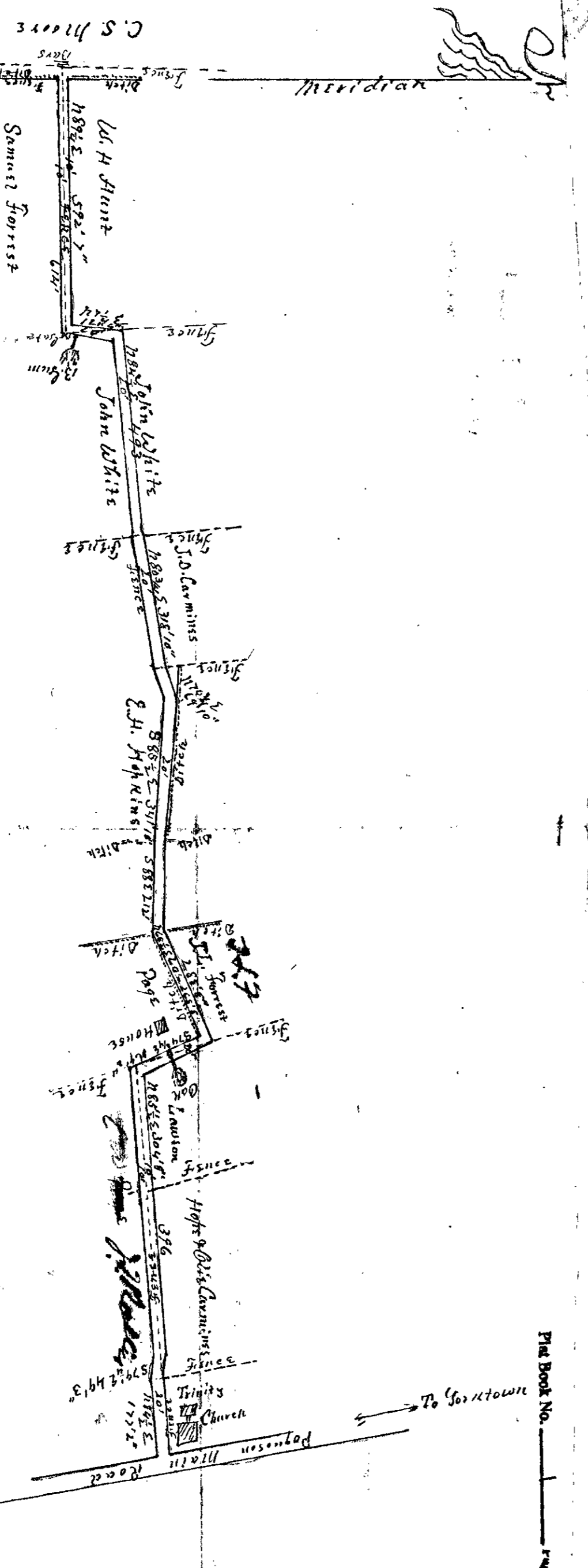

104

Filed and recorded April 20, 1922.
 Book of Supervisors minutes page 114, Book # 3.
 Test: Floyd Holloway, Clerk

A survey and diagram of the highway road leading from the Division Main Road, at the corner of Trinity Church, through the lands of J. A. Forrest, J. D. Carmine, E. H. Hopkins, J. I. Forrest, Page, J. A. Forrest, E. H. Hopkins, J. D. Carmine, John White, W. H. Hunt and Samuel Forrest, to the State and C. S. Moore's line - The corners distances are given on the diagram - Surveyed for the Commissioners, C. W. Smith, E. T. Firstman Voters, October 13th 1921

C. W. Smith
 Surveyor

Scale
 24 feet = one inch

Total area of Road 1.63 Acres

Total length of Road 3554' 6"

Width of Road 20'

Surveyor's fees
 for Survey \$10.00
 for plat 5.00
 for total \$15.00

C. S. Moore

104