

VIRGINIA ELECTRIC & POWER CO.
 Williamsburg - York
 TRANSMISSION LINE
 PLAT TO ACCOMPANY WITH
 BETTY D. & G.S.
 DISTRICT COUNTY STATE
 YORK YORK VA.
 DATED 10-13-1926
 SCALE 1/4" = 100'

W-7-12-A

118

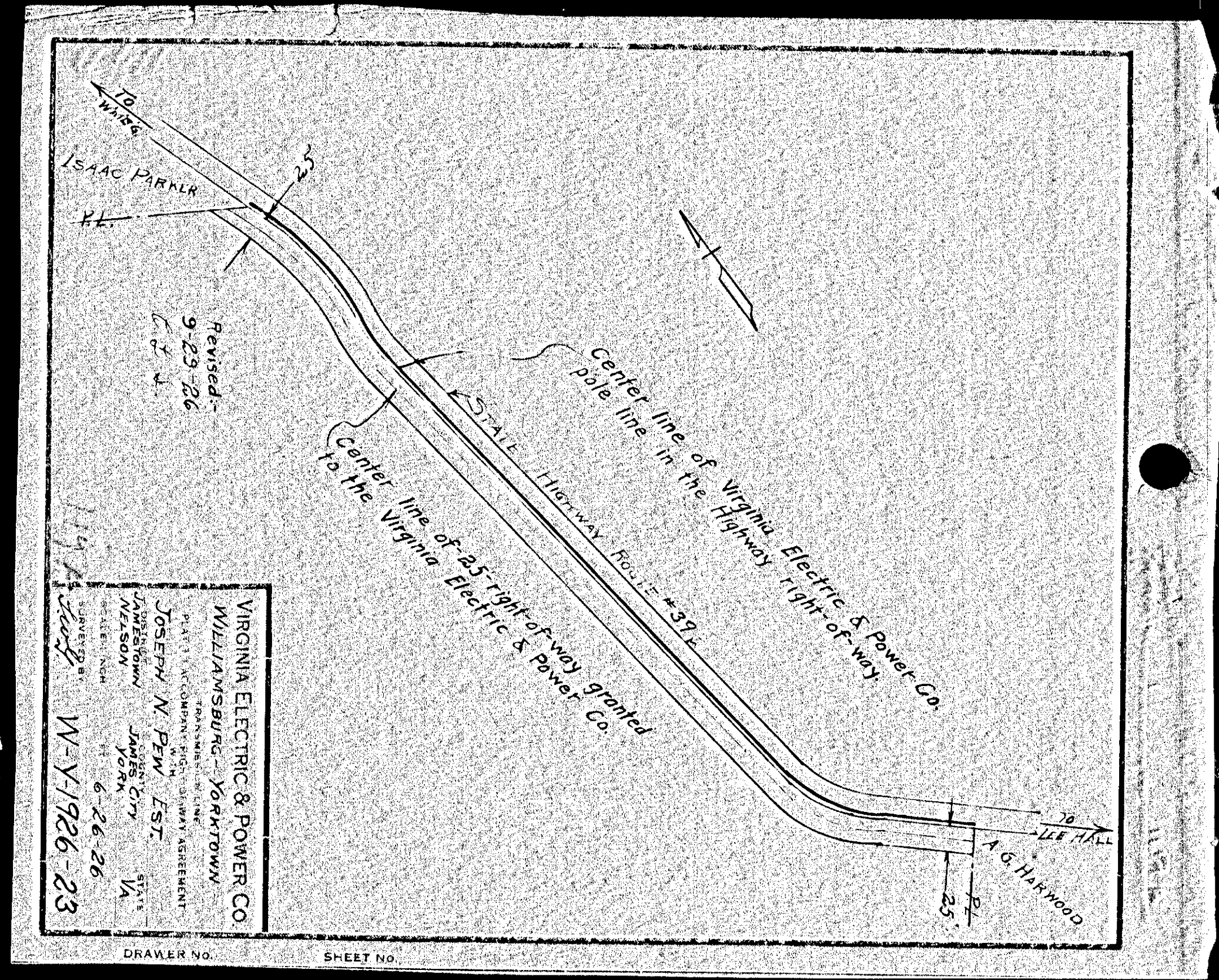

VIRGINIA ELECTRIC & POWER CO.
 Williamsburg - Yorktown
 TRANSMISSION LINE
 PLAT TO ACCOMPANY WITH
 JOSEPH N. PEW EST.
 JAMES TOWN YORK VA.
 DATED 6-26-26
 SCALE 1/4" = 100'

W-V-1926-23

117A

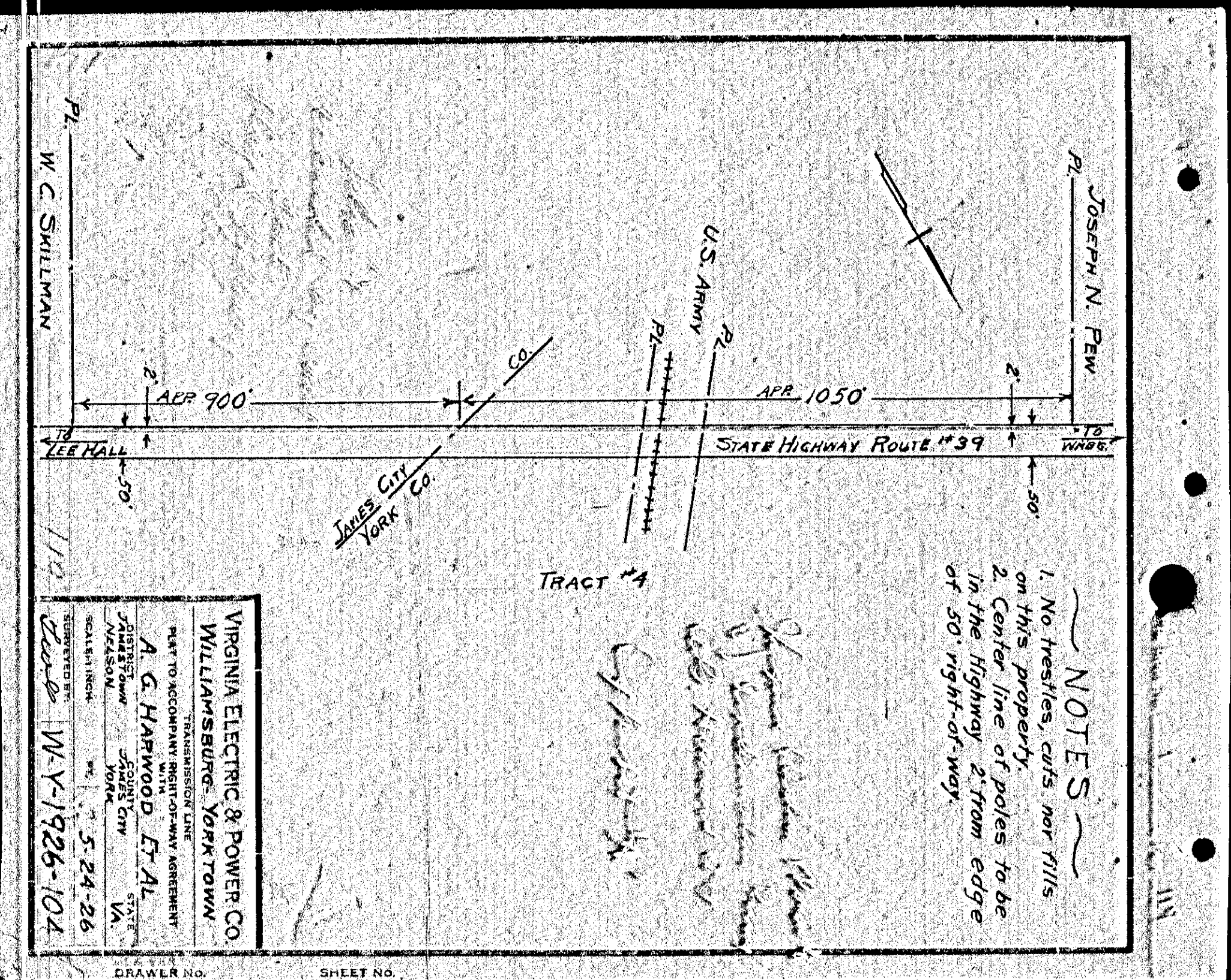

VIRGINIA ELECTRIC & POWER CO.
 Williamsburg - Yorktown
 TRANSMISSION LINE
 PLAT TO ACCOMPANY WITH
 A. G. HARWOOD ET AL
 JAMES TOWN YORK VA.
 DATED 5-24-26
 SCALE 1/4" = 100'

W-V-1926-104

NOTES
 1. No trestles, cuts nor fills on this property.
 2. Center line of poles to be in the highway 2' from edge of 50' right-of-way.

119

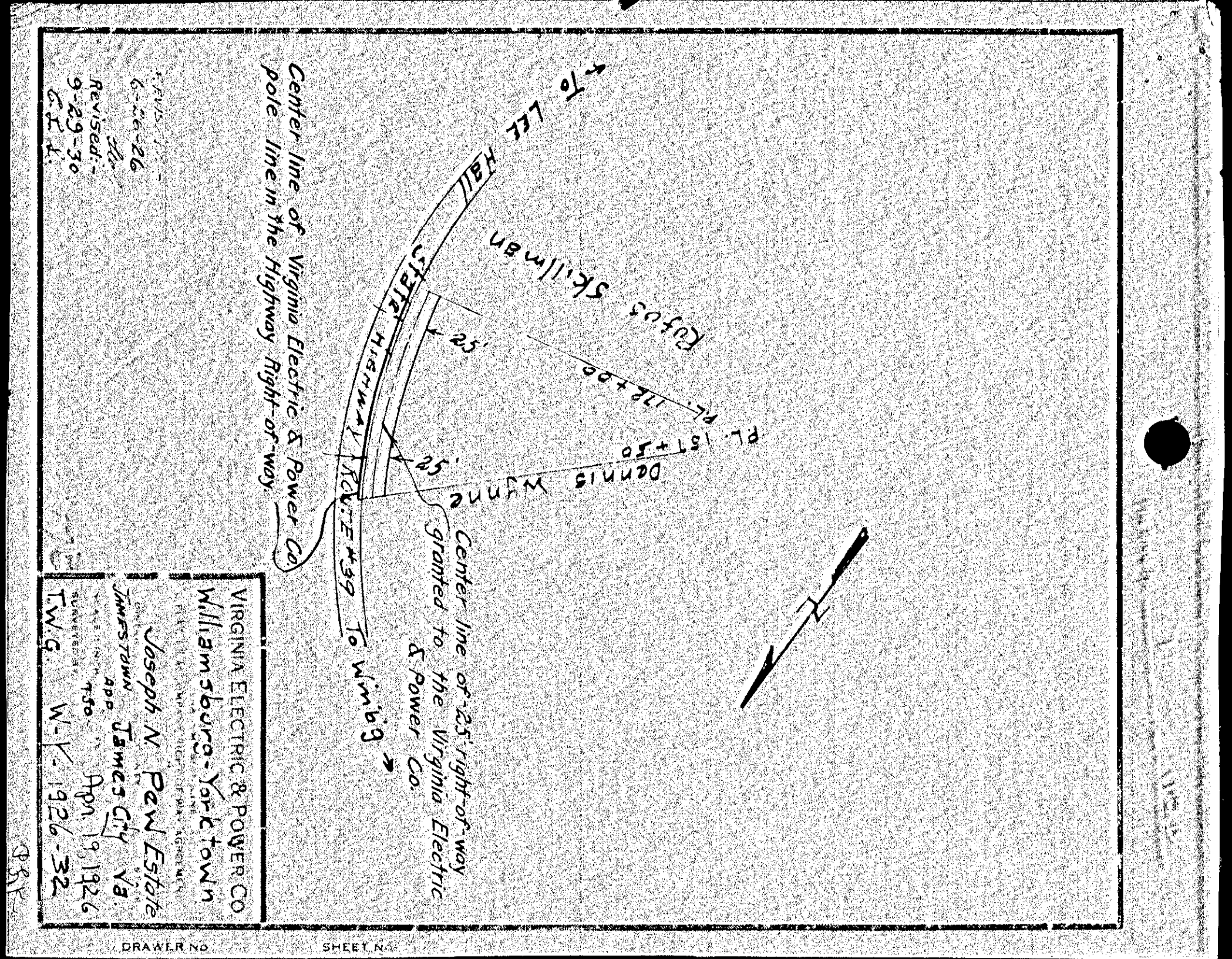

VIRGINIA ELECTRIC & POWER CO.
 Williamsburg - Yorktown
 TRANSMISSION LINE
 PLAT TO ACCOMPANY WITH
 JOSEPH N. PEW ESTATE
 JAMES TOWN YORK VA.
 DATED 6-26-26
 SCALE 1/4" = 100'

W-V-1926-32

117B