

AREAS	
HIGHLAND	99.00 ACRES
MARSH	15.00 "
TIDAL FLATS	11.00 "
TOTAL LAND	205.00 "
WATER AREA	25.00 "
TOTAL AREA	230.00 "

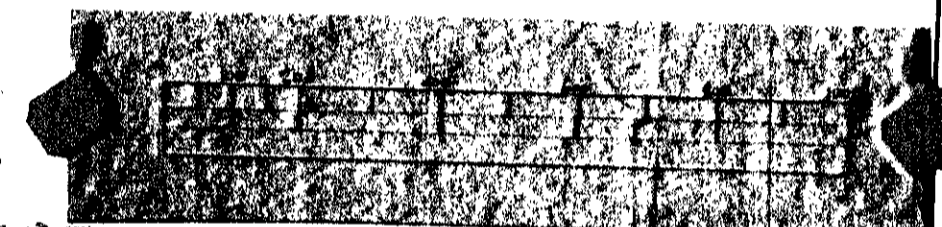
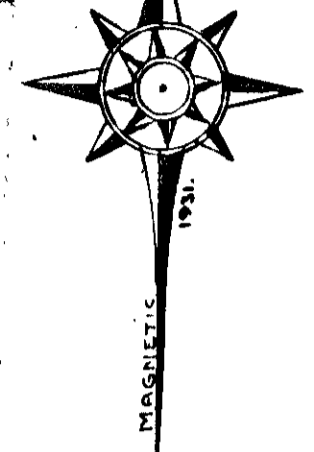
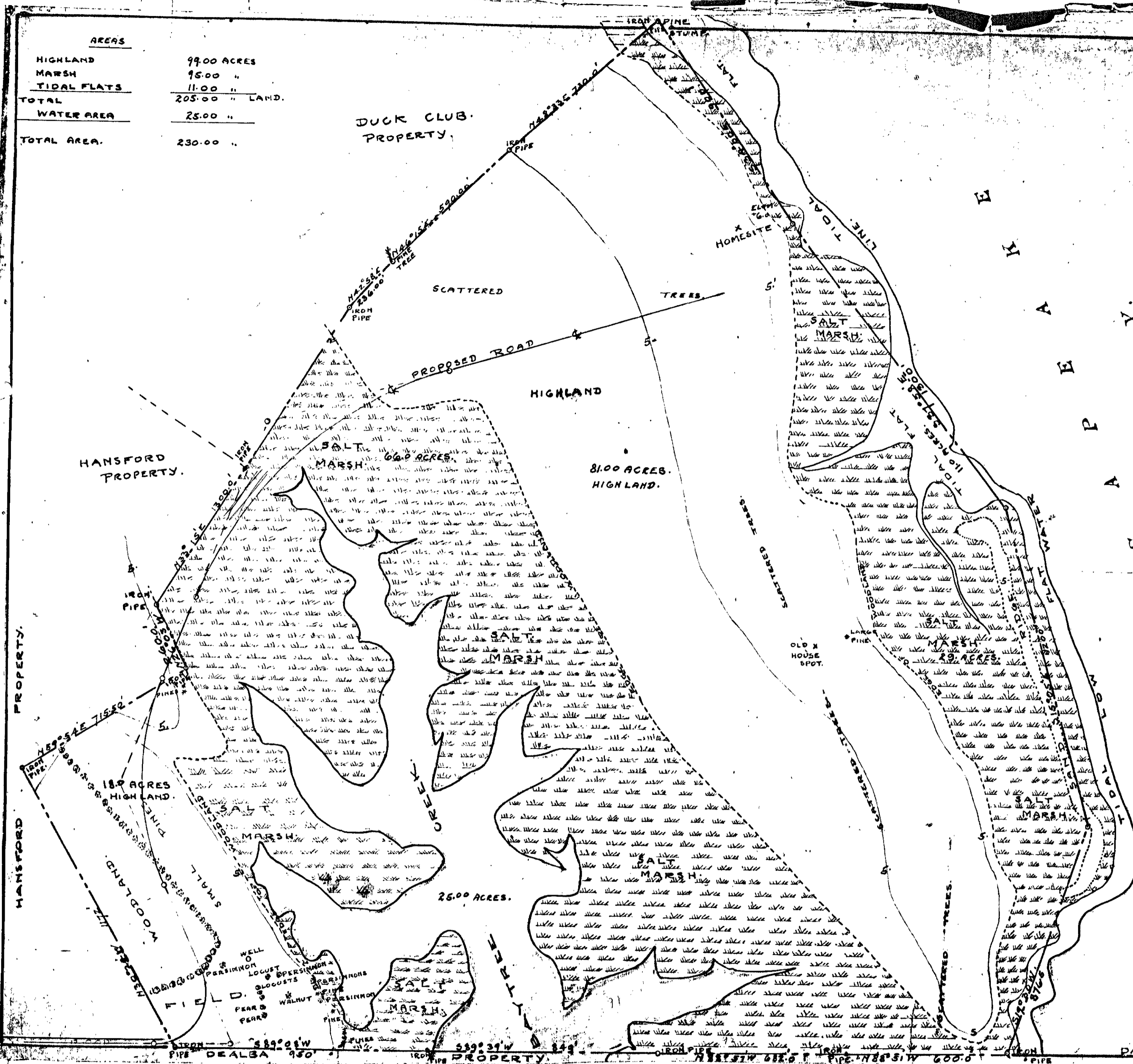

1st Book No. _____ Page 227

MAP

SHOWING

"BAY TREE FARM"

IN

GRAFTON DISTRICT

YORK COUNTY VA

PROPERTY OF

MRS. ALMERIA A. BAILEY

BOX # 517-NEWPORT NEWS VA.

SCALE 1" = 200'. December 22nd 1931.

Chesapeake Engineering Co.

H. B. Gilroy

J. M. McLean

CERTIFIED CIVIL ENGINEERS

PATUM-MEAN SEA LEVEL.