

VIRGINIA ELECTRIC & POWER CO.  
WILLIAMSBURG DISTRIBUTION  
TRANSMISSION LINE  
PLAT TO ACCOMPANY RIGHT-OF-WAY AGREEMENT  
WITH  
JOHN D. ROCKEFELLER JR.  
DISTRICT BRUTON COUNTY WILLIAMSBURG  
SCALE: 1" = 200' FEB. 30, 1934  
SURVEYED BY D.A.H. WMBG # 1117

Filed & Recorded  
Oct. 25th 1934  
Court Holbway Clerk

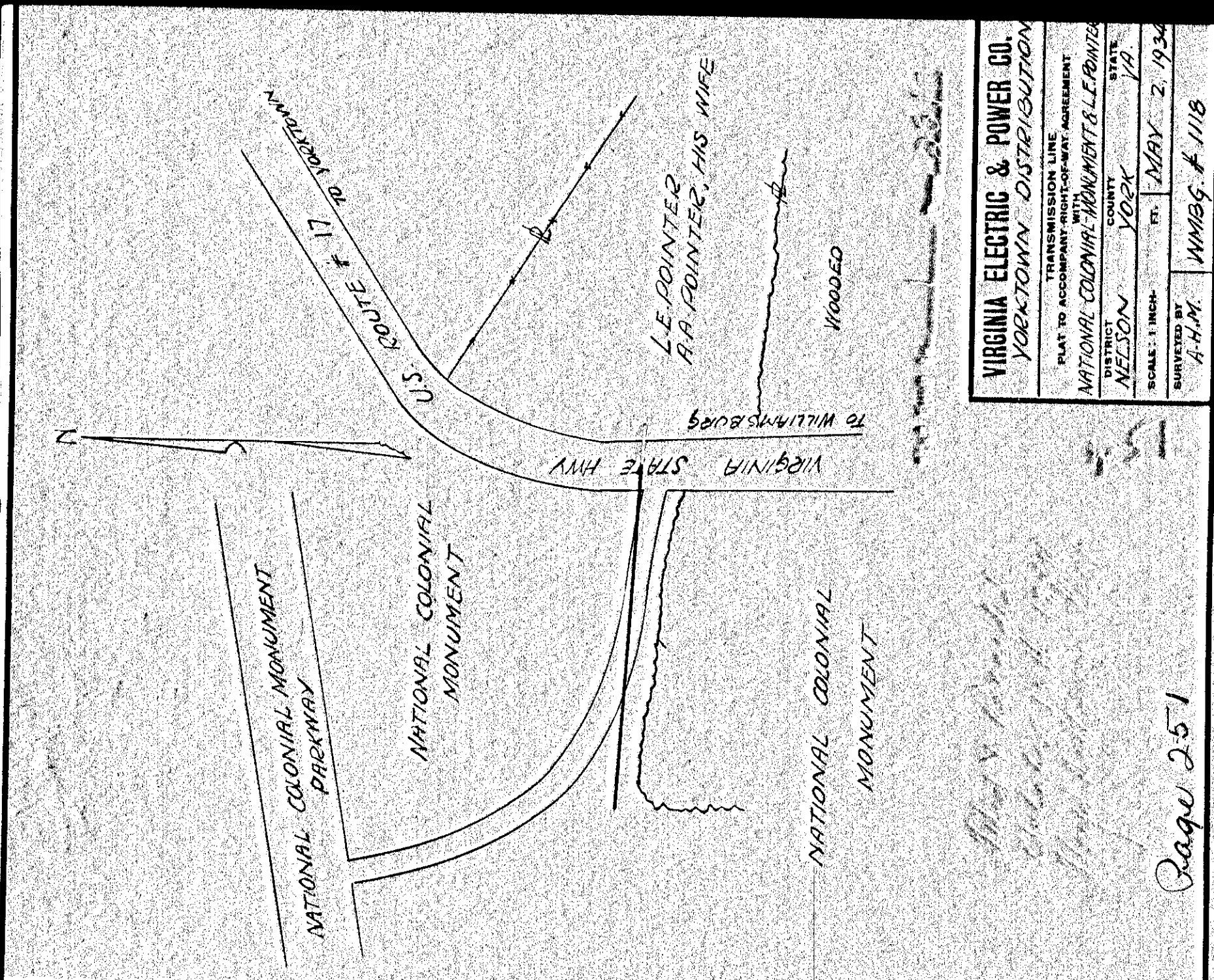

VIRGINIA ELECTRIC & POWER CO.  
WILLIAMSBURG DISTRIBUTION  
TRANSMISSION LINE  
PLAT TO ACCOMPANY RIGHT-OF-WAY AGREEMENT  
WITH  
NATIONAL COLONIAL MONUMENT & L.E. POINTER  
DISTRICT BRUTON COUNTY WILLIAMSBURG  
SCALE: 1" = 100' MAY 2, 1934  
SURVEYED BY A.H.M. WMBG # 1118

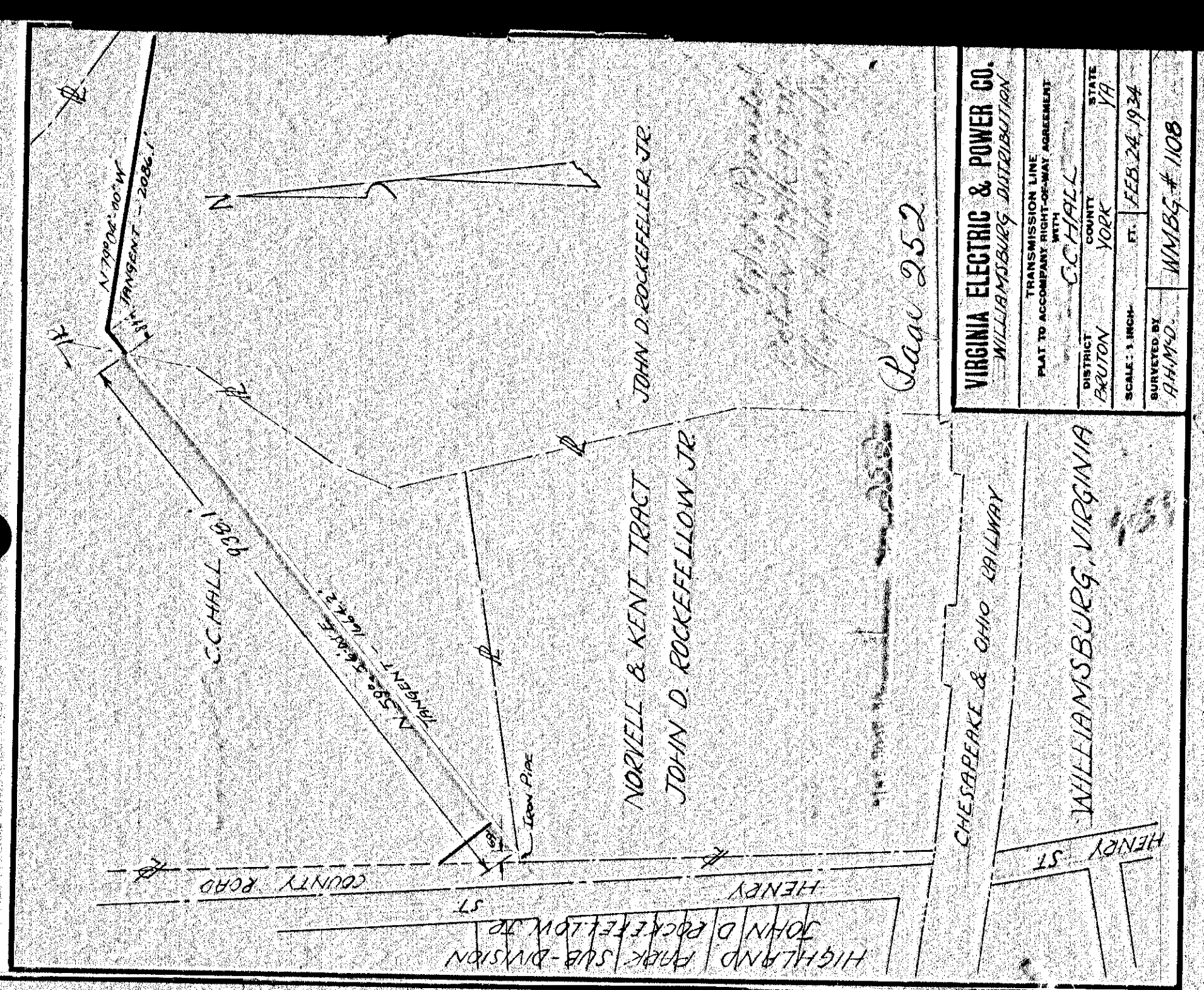

VIRGINIA ELECTRIC & POWER CO.  
WILLIAMSBURG DISTRIBUTION  
TRANSMISSION LINE  
PLAT TO ACCOMPANY RIGHT-OF-WAY AGREEMENT  
WITH  
C.C. HALL  
DISTRICT BRUTON COUNTY WILLIAMSBURG  
SCALE: 1" = 100' FEB. 24, 1934  
SURVEYED BY A.H.M. WMBG # 1108