

275

Page 275

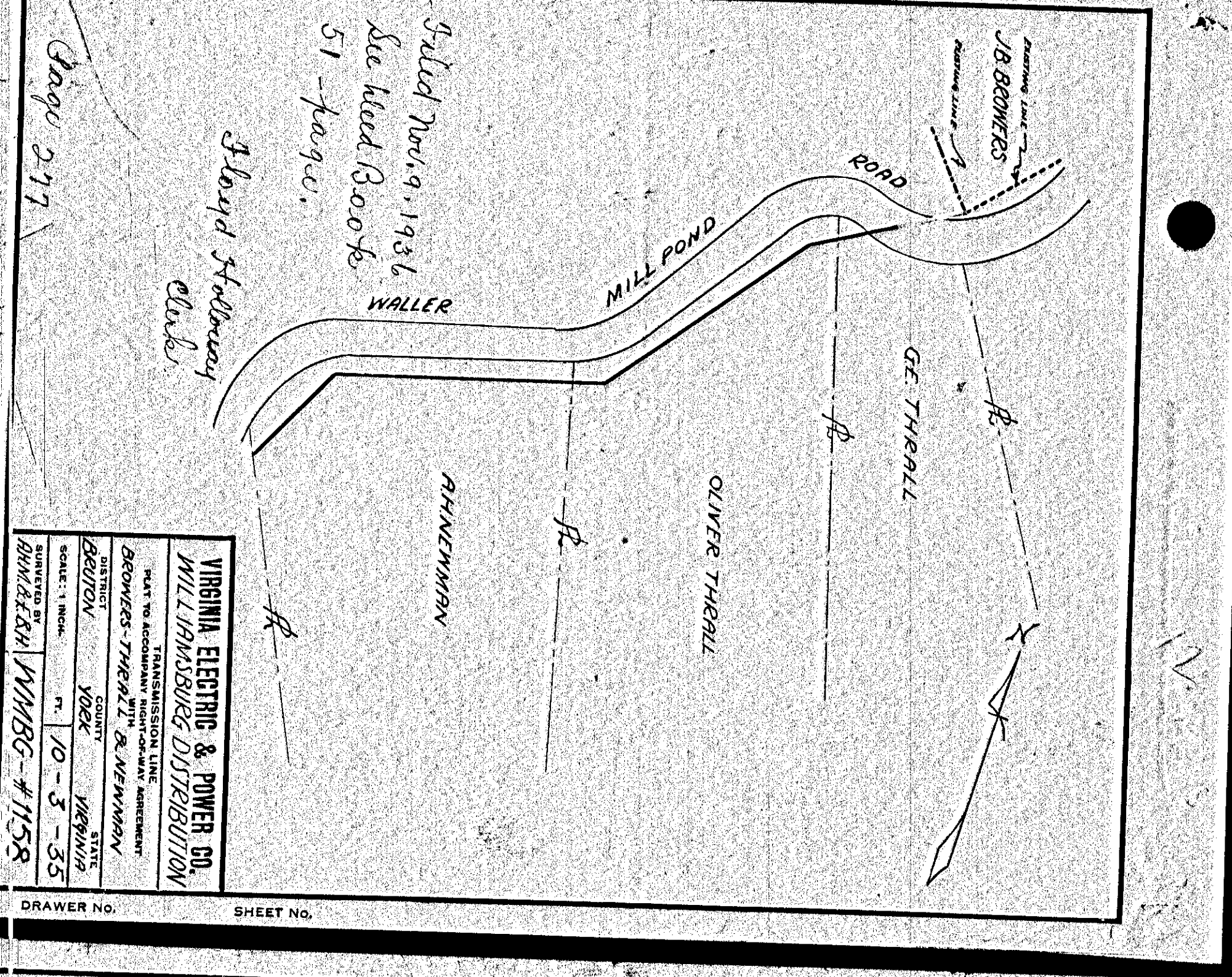

277

Page 277

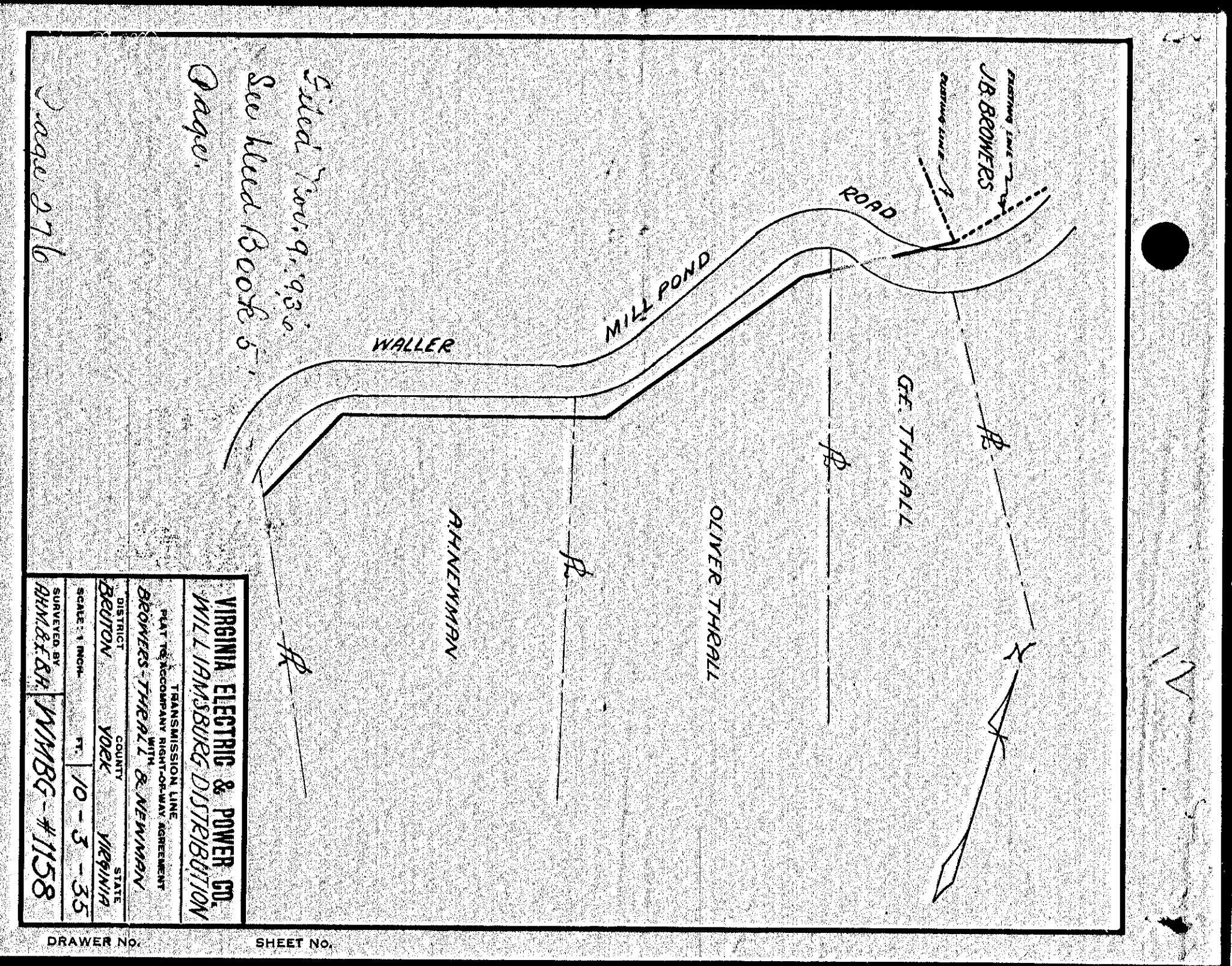

276

Page 276

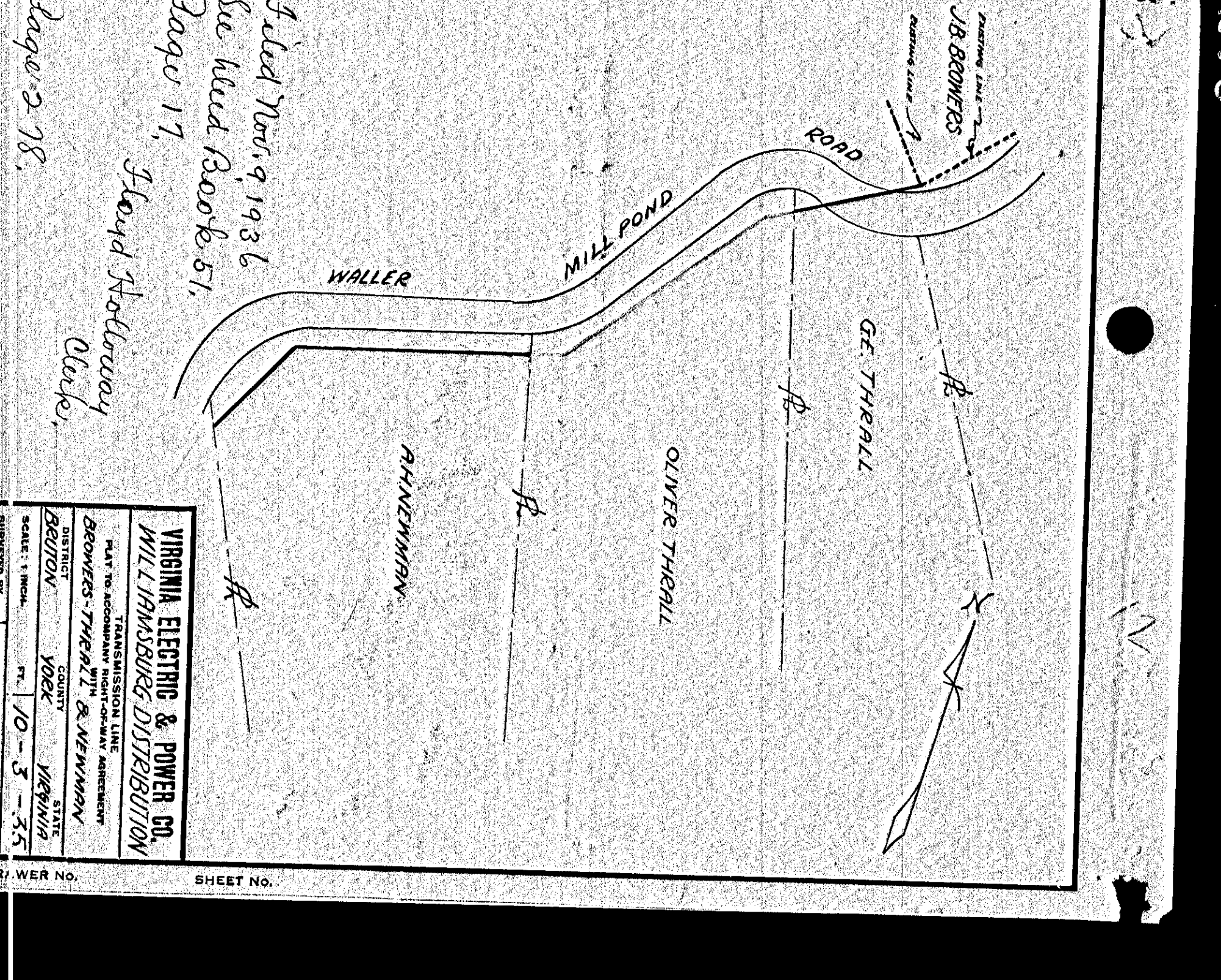

278

Page 278

VIRGINIA ELECTRIC & POWER CO.  
 WILLIAMSBURG DISTRIBUTION  
 TRANSMISSION LINE  
 PLAT TO ACCOMPANY RIGHT-OF-WAY AGREEMENT  
 BETWEEN  
 BROWERS - THIRALL & NEWMAN  
 DISTRICT  
 BEUTON COUNTY YORK STATE VIRGINIA  
 SCALE: 1" = 100 FT. 10-3-35  
 SURVEYED BY  
 BHMB&B WMBG-#1158

DRAWER No. SHEET No.

VIRGINIA ELECTRIC & POWER CO.  
 WILLIAMSBURG DISTRIBUTION  
 TRANSMISSION LINE  
 PLAT TO ACCOMPANY RIGHT-OF-WAY AGREEMENT  
 BETWEEN  
 BROWERS - THIRALL & NEWMAN  
 DISTRICT  
 BEUTON COUNTY YORK STATE VIRGINIA  
 SCALE: 1" = 100 FT. 10-3-35  
 SURVEYED BY  
 BHMB&B WMBG-#1158

DRAWER No. SHEET No.

VIRGINIA ELECTRIC & POWER CO.  
 WILLIAMSBURG DISTRIBUTION  
 TRANSMISSION LINE  
 PLAT TO ACCOMPANY RIGHT-OF-WAY AGREEMENT  
 BETWEEN  
 BROWERS - THIRALL & NEWMAN  
 DISTRICT  
 BEUTON COUNTY YORK STATE VIRGINIA  
 SCALE: 1" = 100 FT. 10-3-35  
 SURVEYED BY  
 BHMB&B WMBG-#1158

DRAWER No. SHEET No.

VIRGINIA ELECTRIC & POWER CO.  
 WILLIAMSBURG DISTRIBUTION  
 TRANSMISSION LINE  
 PLAT TO ACCOMPANY RIGHT-OF-WAY AGREEMENT  
 BETWEEN  
 BROWERS - THIRALL & NEWMAN  
 DISTRICT  
 BEUTON COUNTY YORK STATE VIRGINIA  
 SCALE: 1" = 100 FT. 10-3-35  
 SURVEYED BY  
 BHMB&B WMBG-#1158

DRAWER No. SHEET No.

Filed Nov. 9, 1936  
 See Book 300 p. 51 - page.

Floyd Stollaway  
 Clerk

Filed Nov. 9, 1936  
 See Book 300 p. 51,

Floyd Stollaway  
 Clerk