

VIRGINIA ELECTRIC & POWER CO.
WILLIAMSBURG DISTRIBUTION

PLAT TO ACCOMPANY NIGHT-OWNY AGREEMENT WITH ASSHOWN

DISTRICT BEUTON COUNTY YORK VIRGINIA

SCALE: 1 INCH = 75 FT. JAN 15 1937

SUBMITTED BY WMBG # 1249

DRAWER No. SHEET No.

March 10th. 1937
Filed Plat Book 1, Page 302.
Right of Way Recorded.
Map Book 1, Page 241.

Sheldon Williamson

302

302

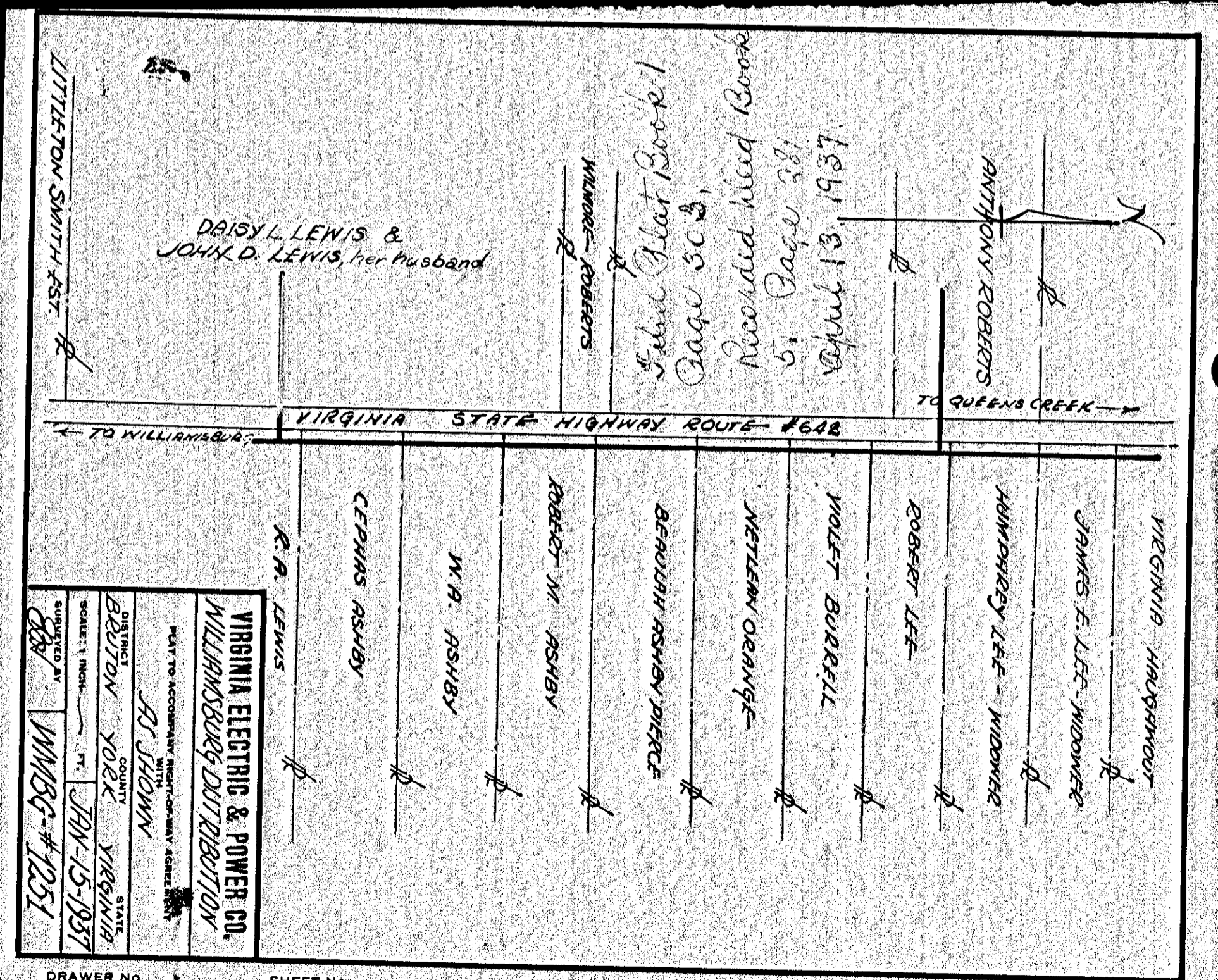

VIRGINIA ELECTRIC & POWER CO.
WILLIAMSBURG DISTRIBUTION

PLAT TO ACCOMPANY NIGHT-OWNY AGREEMENT WITH ASSHOWN

DISTRICT BEUTON COUNTY YORK VIRGINIA

SCALE: 1 INCH = 75 FT. JAN 15 1937

SUBMITTED BY WMBG # 1251

DRAWER No. SHEET No.

DAISY L. LEWIS & JOHN D. LEWIS, her husband

WILMER ROBERTS

Recorded Map Book 1 Page 303.
Recorded Map Book 5, Page 28.
April 13 1937.

303

303

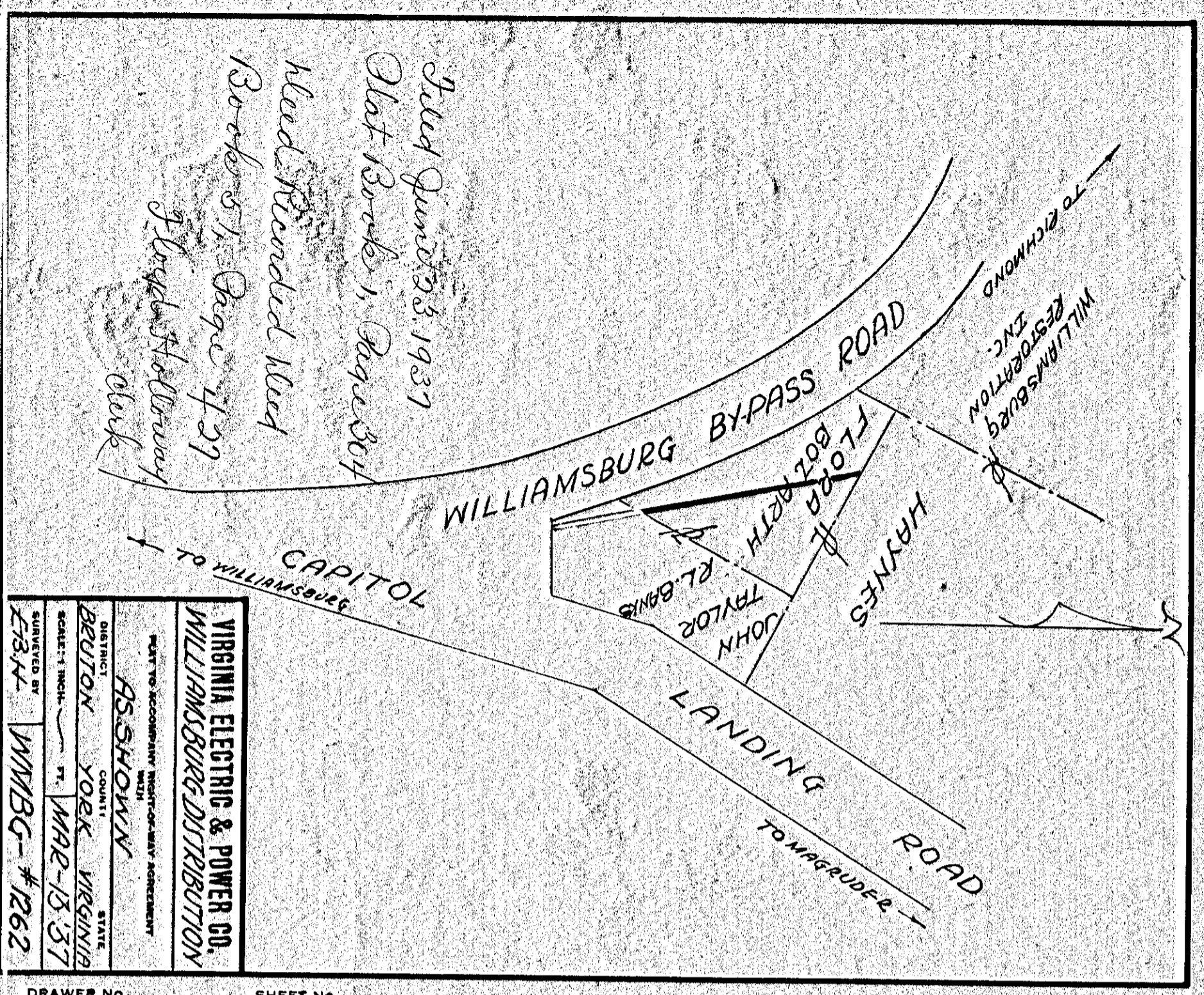

VIRGINIA ELECTRIC & POWER CO.
WILLIAMSBURG DISTRIBUTION

PLAT TO ACCOMPANY NIGHT-OWNY AGREEMENT WITH ASSHOWN

DISTRICT BEUTON COUNTY YORK VIRGINIA

SCALE: 1 INCH = 75 FT. MAR 13 1937

SUBMITTED BY WMBG # 1262

DRAWER No. SHEET No.

Filed June 23, 1937
Plat Book 1, Page 304
Filed Recorded Map Book 5, Page 429
Sheldon Williamson
Clerk

304

305

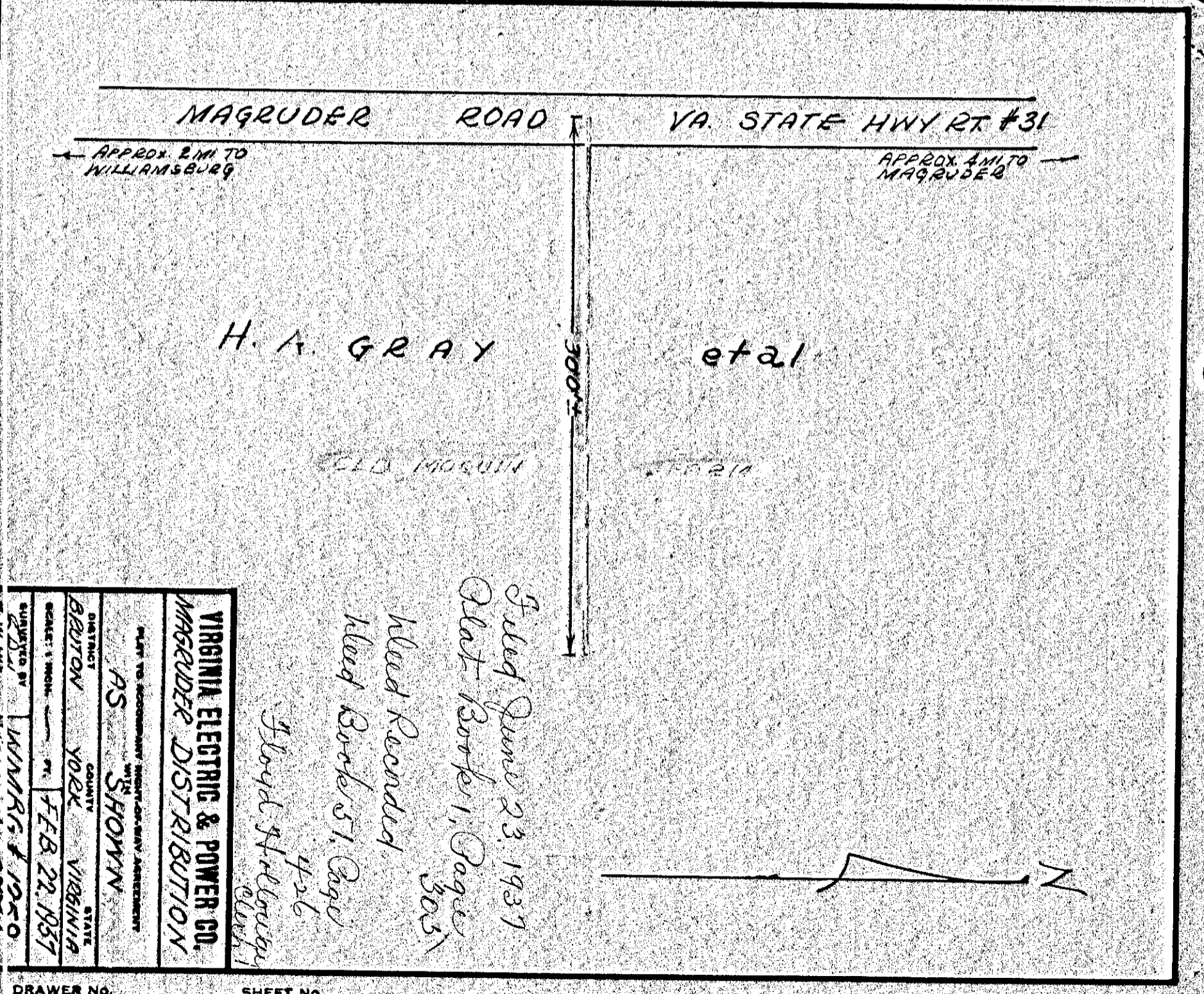

VIRGINIA ELECTRIC & POWER CO.
MAGRUDER DISTRIBUTION

PLAT TO ACCOMPANY NIGHT-OWNY AGREEMENT WITH ASSHOWN

DISTRICT BEUTON COUNTY YORK VIRGINIA

SCALE: 1 INCH = 75 FT. FEB 22 1937

SUBMITTED BY WMBG # 1259

DRAWER No. SHEET No.

Filed June 23, 1937
Plat Book 1, Page 305
Filed Recorded Map Book 5, Page 426
Sheldon Williamson
Clerk