

**VIRGINIA ELECTRIC & POWER CO.**  
**WILLIAMSBURG DISTRIBUTION**  
 PLAN TO ACCOMPANY RIGHT-OF-WAY AGREEMENT  
 As Shown  
 DISTRICT BRITAIN COUNTY VIRGINIA  
 SCALE: 1 INCH = 40 FT  
 SUBMITTED BY C.W.L. WMBG # 1486

Page 427  
 Filed Sept 22, 1939  
 Bond Record  
 Bond Book #54, Page 136  
 Gloyd & Manning, Clerk

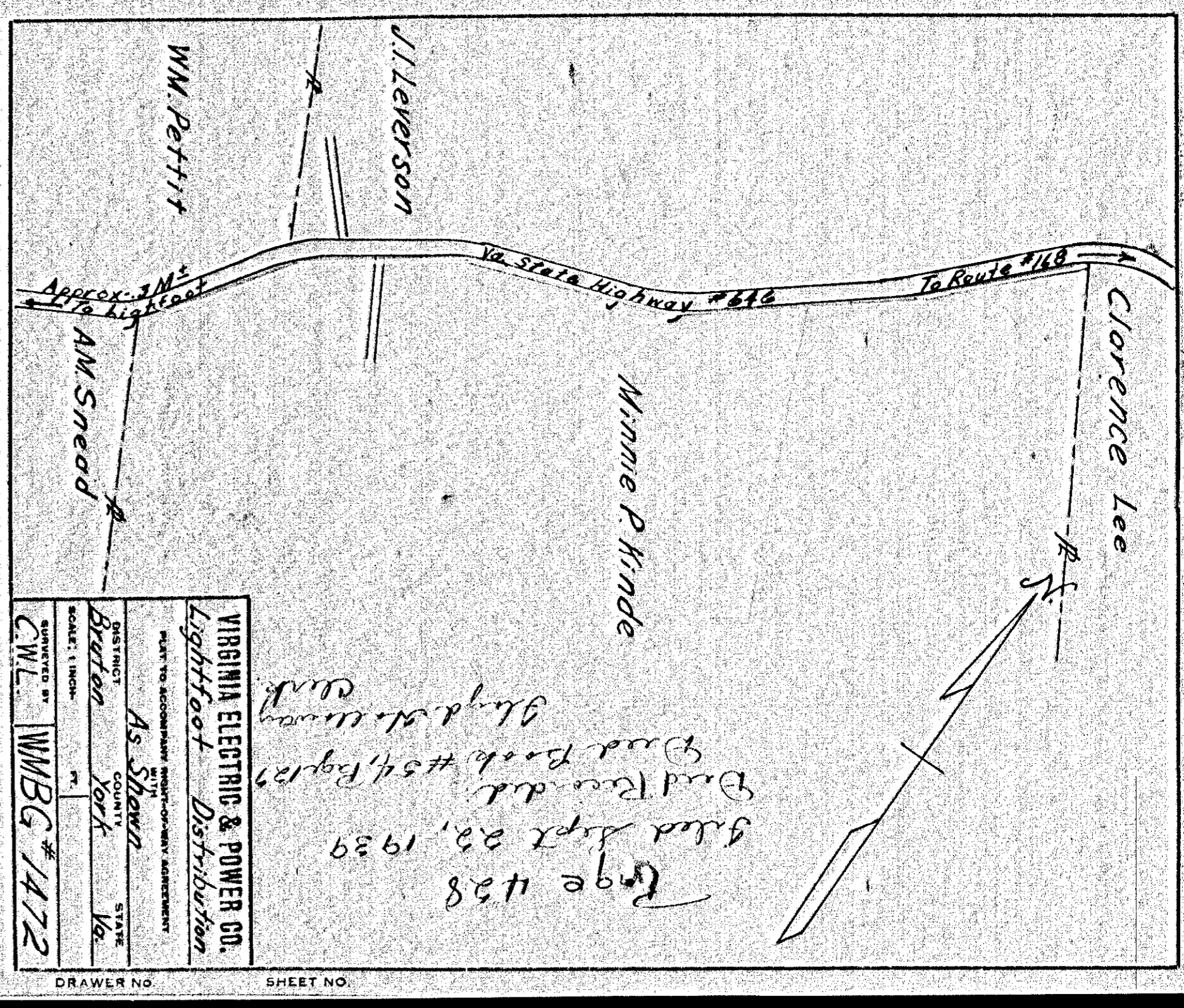

**VIRGINIA ELECTRIC & POWER CO.**  
**Lightfoot Distribution**  
 PLAN TO ACCOMPANY RIGHT-OF-WAY AGREEMENT  
 As Shown  
 DISTRICT BRITAIN COUNTY VIRGINIA  
 SCALE: 1 INCH = 40 FT  
 SUBMITTED BY C.W.L. WMBG # 1472

Page 428  
 Filed Sept 22, 1939  
 Bond Record  
 Bond Book #54, Page 137  
 Gloyd & Manning, Clerk

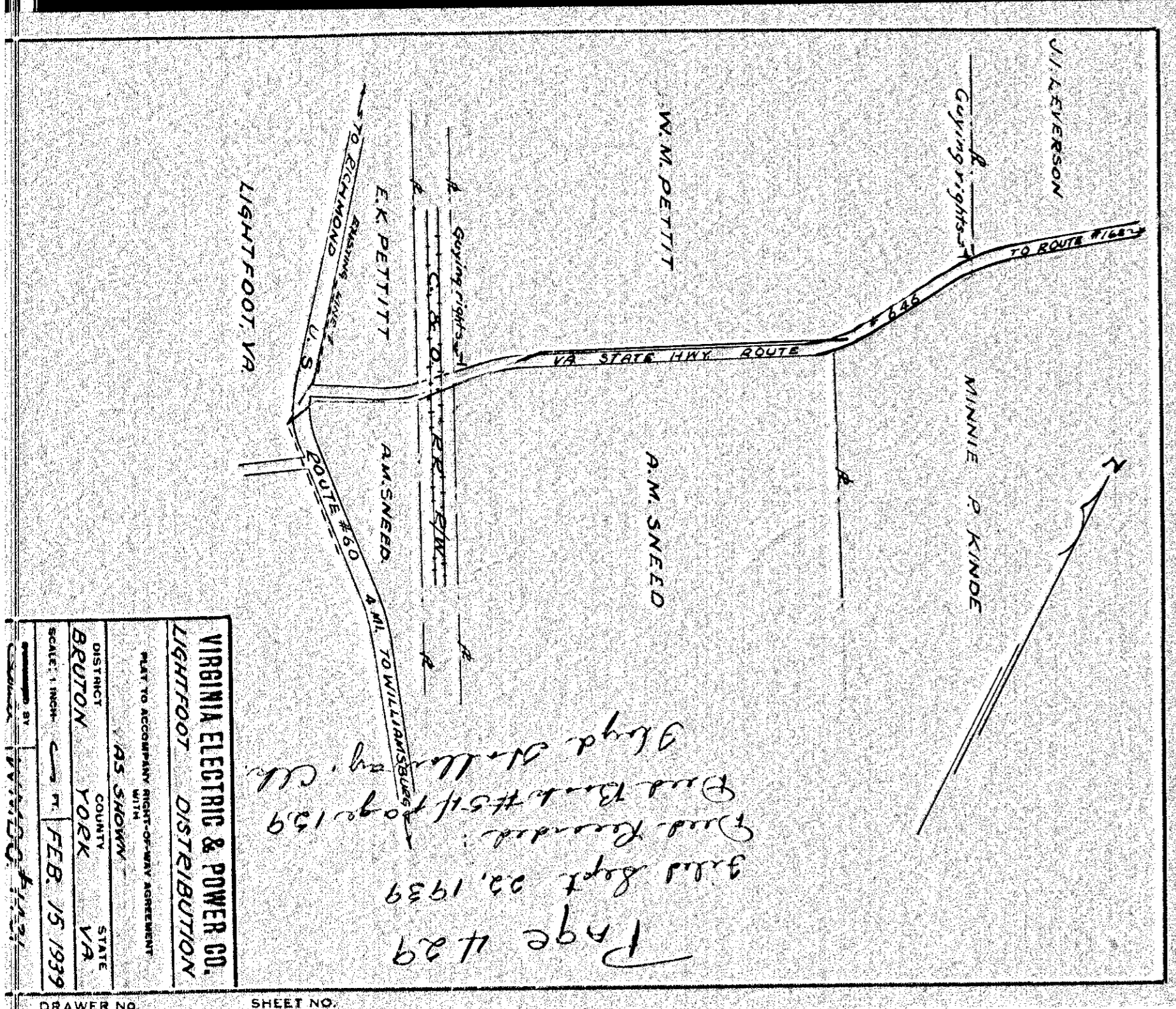

**VIRGINIA ELECTRIC & POWER CO.**  
**LIGHTFOOT DISTRIBUTION**  
 PLAN TO ACCOMPANY RIGHT-OF-WAY AGREEMENT  
 As Shown  
 DISTRICT BRITAIN COUNTY VIRGINIA  
 SCALE: 1 INCH = 40 FT  
 SUBMITTED BY C.W.L. WMBG # 1429

Page 429  
 Filed Sept 22, 1939  
 Bond Record  
 Bond Book #54, Page 139  
 Gloyd & Manning, Clerk

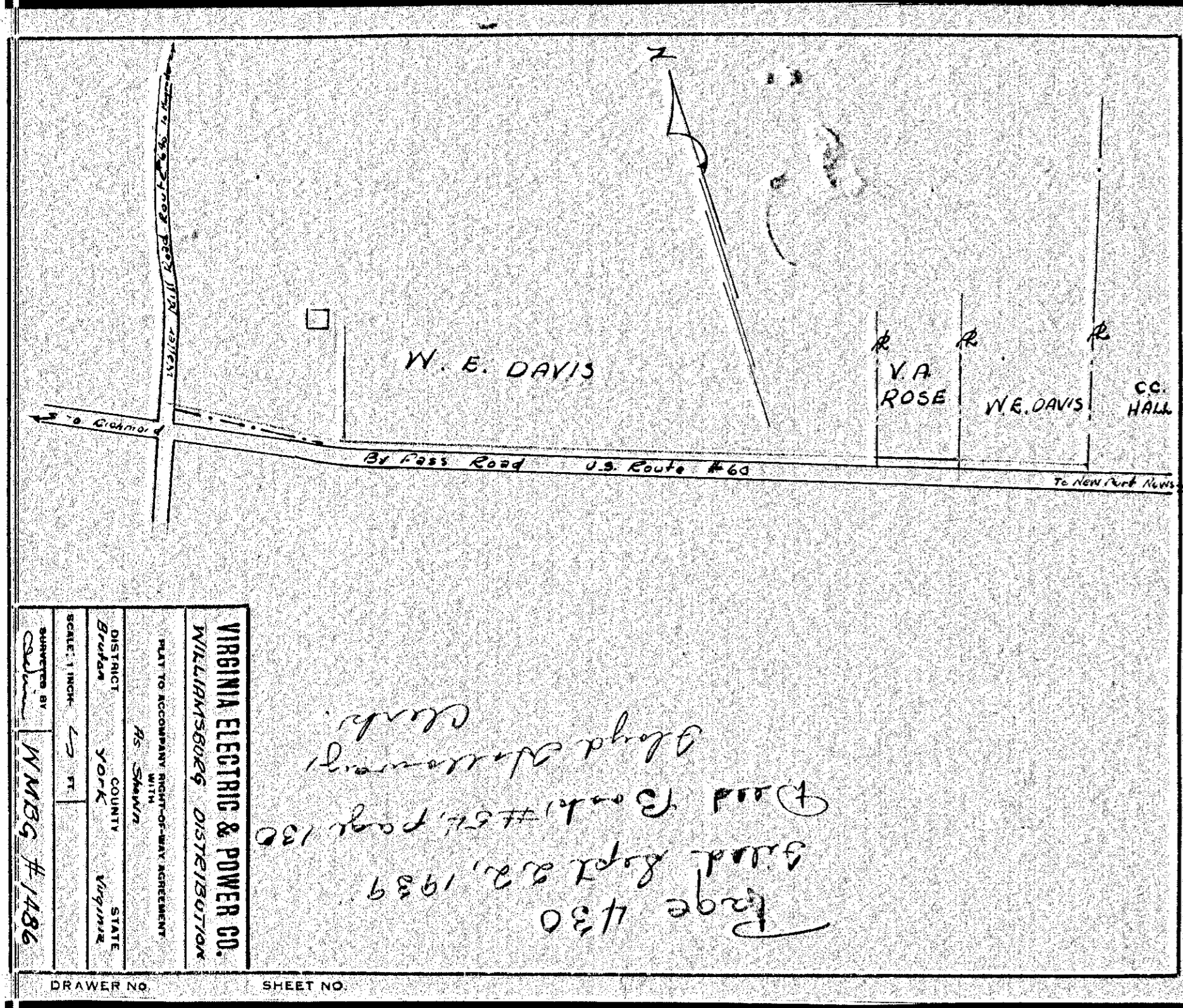

**VIRGINIA ELECTRIC & POWER CO.**  
**WILLIAMSBURG DISTRIBUTION**  
 PLAN TO ACCOMPANY RIGHT-OF-WAY AGREEMENT  
 As Shown  
 DISTRICT BRITAIN COUNTY VIRGINIA  
 SCALE: 1 INCH = 40 FT  
 SUBMITTED BY C.W.L. WMBG # 1486

Page 430  
 Filed Sept 22, 1939  
 Bond Record  
 Bond Book #54, Page 138  
 Gloyd & Manning, Clerk

427  
 429

428  
 430