

VIRGINIA ELECTRIC & POWER CO.
 YORKTOWN DISTRIBUTION
 PLAT TO ACCOMPANY RIGHT-OF-WAY AGREEMENT
 AS SHOWN
 DISTRICT NELSON YORK VA
 SCALE: 1 INCH = 40 FT. OCT. 10, 1938.
 SURVEYED BY WMBG #1394
 C.L.S.

DRAWER NO. SHEET NO.

3rd January, 1940
 Right of way recorded
 Deed Book No 54, page 378
 Lloyd Stillman,
 Clerk

Page 488

488

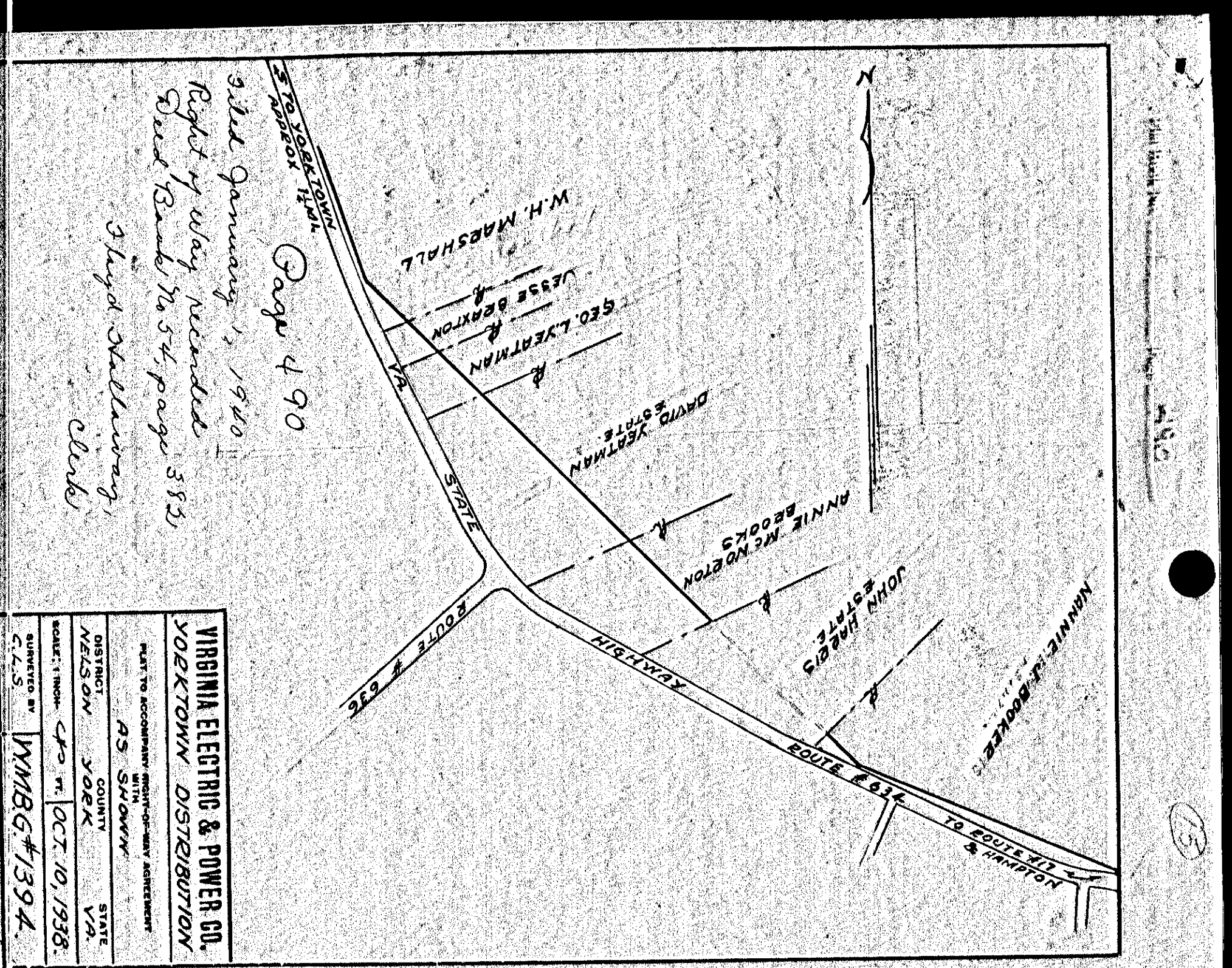

VIRGINIA ELECTRIC & POWER CO.
 YORKTOWN DISTRIBUTION
 PLAT TO ACCOMPANY RIGHT-OF-WAY AGREEMENT
 AS SHOWN
 DISTRICT NELSON YORK VA
 SCALE: 1 INCH = 40 FT. OCT. 10, 1938.
 SURVEYED BY WMBG #1394
 C.L.S.

DRAWER NO. SHEET NO.

3rd January, 1940
 Right of way recorded
 Deed Book No 54, page 383
 Lloyd Stillman,
 Clerk

Page 490

490

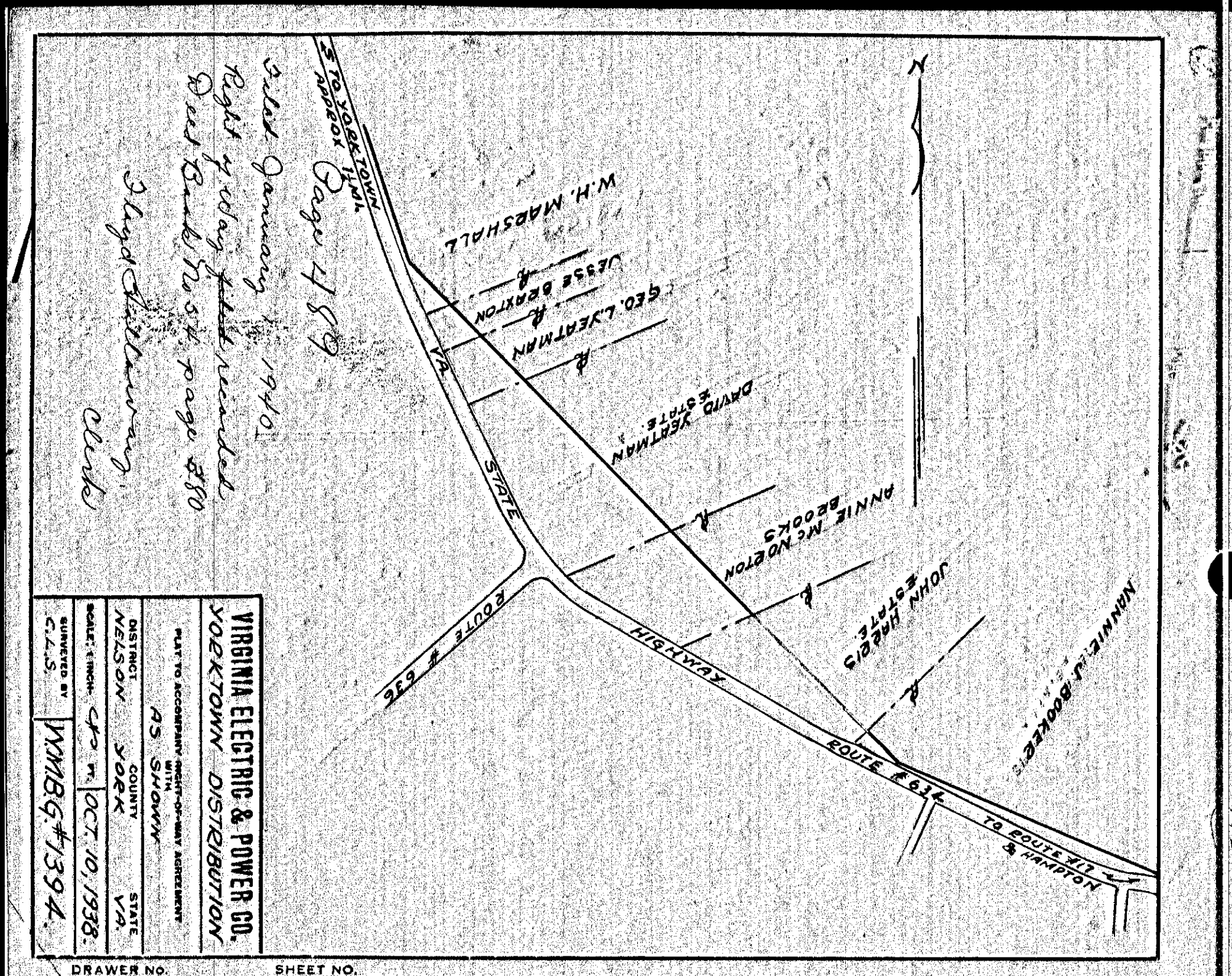

VIRGINIA ELECTRIC & POWER CO.
 YORKTOWN DISTRIBUTION
 PLAT TO ACCOMPANY RIGHT-OF-WAY AGREEMENT
 AS SHOWN
 DISTRICT NELSON YORK VA
 SCALE: 1 INCH = 40 FT. OCT. 10, 1938.
 SURVEYED BY WMBG #1394
 C.L.S.

DRAWER NO. SHEET NO.

3rd January, 1940
 Right of way recorded
 Deed Book No 54, page 380
 Lloyd Stillman,
 Clerk

Page 489

489

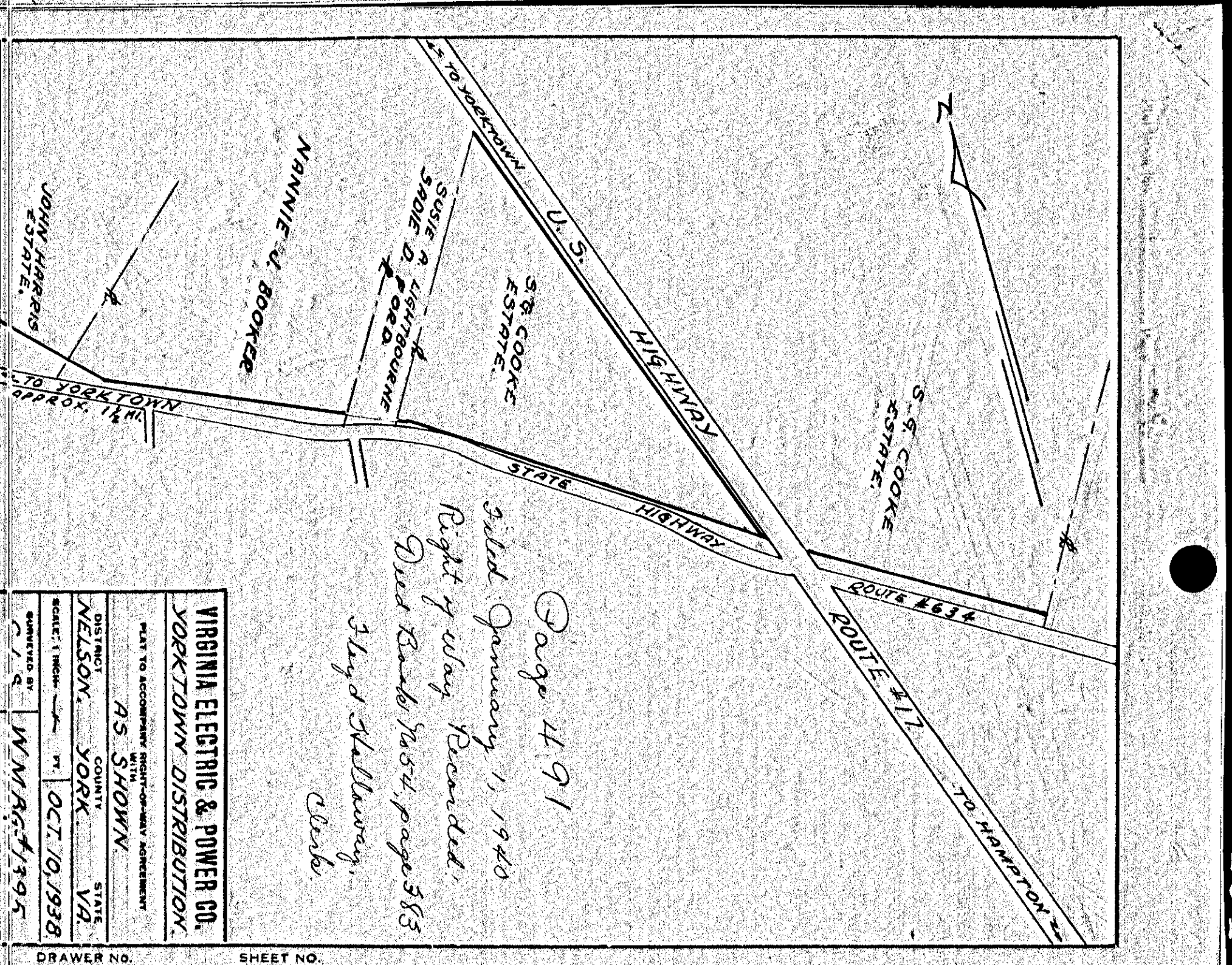

VIRGINIA ELECTRIC & POWER CO.
 YORKTOWN DISTRIBUTION
 PLAT TO ACCOMPANY RIGHT-OF-WAY AGREEMENT
 AS SHOWN
 DISTRICT NELSON YORK VA
 SCALE: 1 INCH = 40 FT. OCT. 10, 1938.
 SURVEYED BY WMBG #1395
 C.L.S.

DRAWER NO. SHEET NO.

3rd January, 1940
 Right of way recorded
 Deed Book No 54, page 383
 Lloyd Stillman,
 Clerk

Page 491

491