

PLAT TO ACCOMPANY RIGHT-OF-WAY AGREEMENT	
VIRGINIA ELECTRIC & POWER CO.	
Johnson Extension	
DISTRICT	As Shown
COUNTY	York
STATE	Va.
DRAWER NO.	CWL WMBG # 1511
SHEET NO.	23 of 24

DRAWER NO. SHEET NO.

572

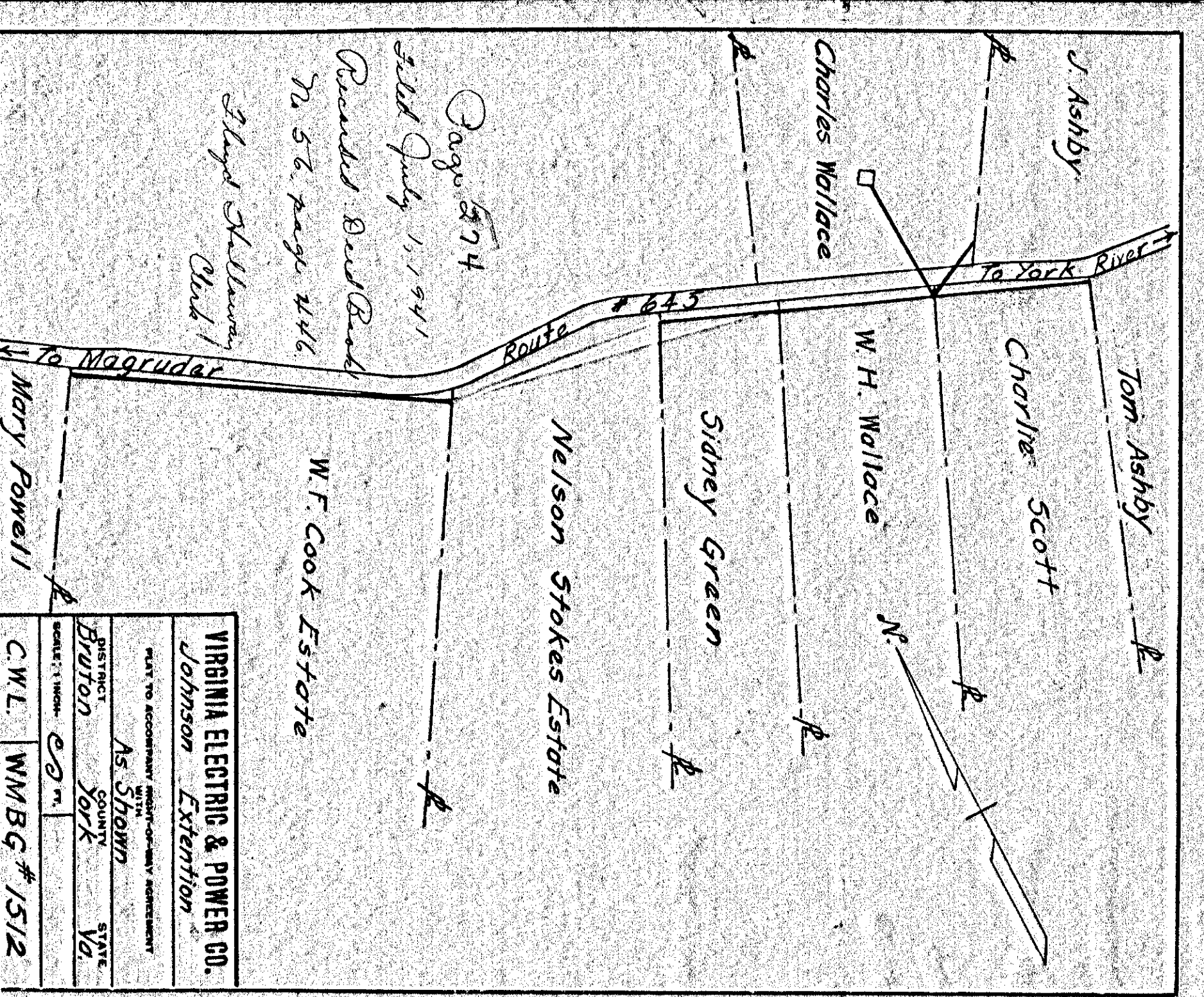

PLAT TO ACCOMPANY RIGHT-OF-WAY AGREEMENT	
VIRGINIA ELECTRIC & POWER CO.	
Johnson Extension	
DISTRICT	As Shown
COUNTY	York
STATE	Va.
DRAWER NO.	CWL WMBG # 1512
SHEET NO.	23 of 24

DRAWER NO. SHEET NO.

574

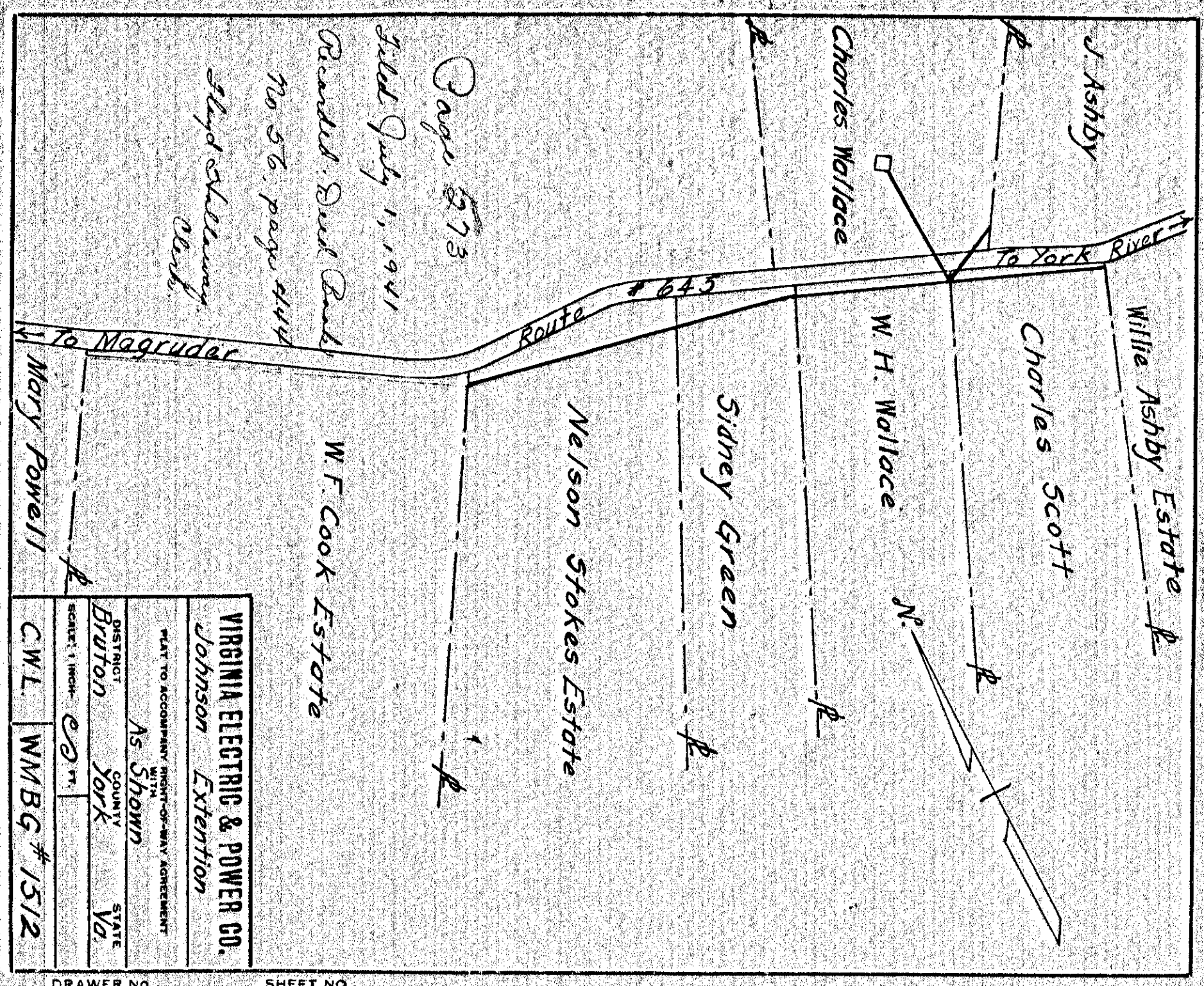

PLAT TO ACCOMPANY RIGHT-OF-WAY AGREEMENT	
VIRGINIA ELECTRIC & POWER CO.	
Johnson Extension	
DISTRICT	As Shown
COUNTY	York
STATE	Va.
DRAWER NO.	CWL WMBG # 1512
SHEET NO.	23 of 24

DRAWER NO. SHEET NO.

573

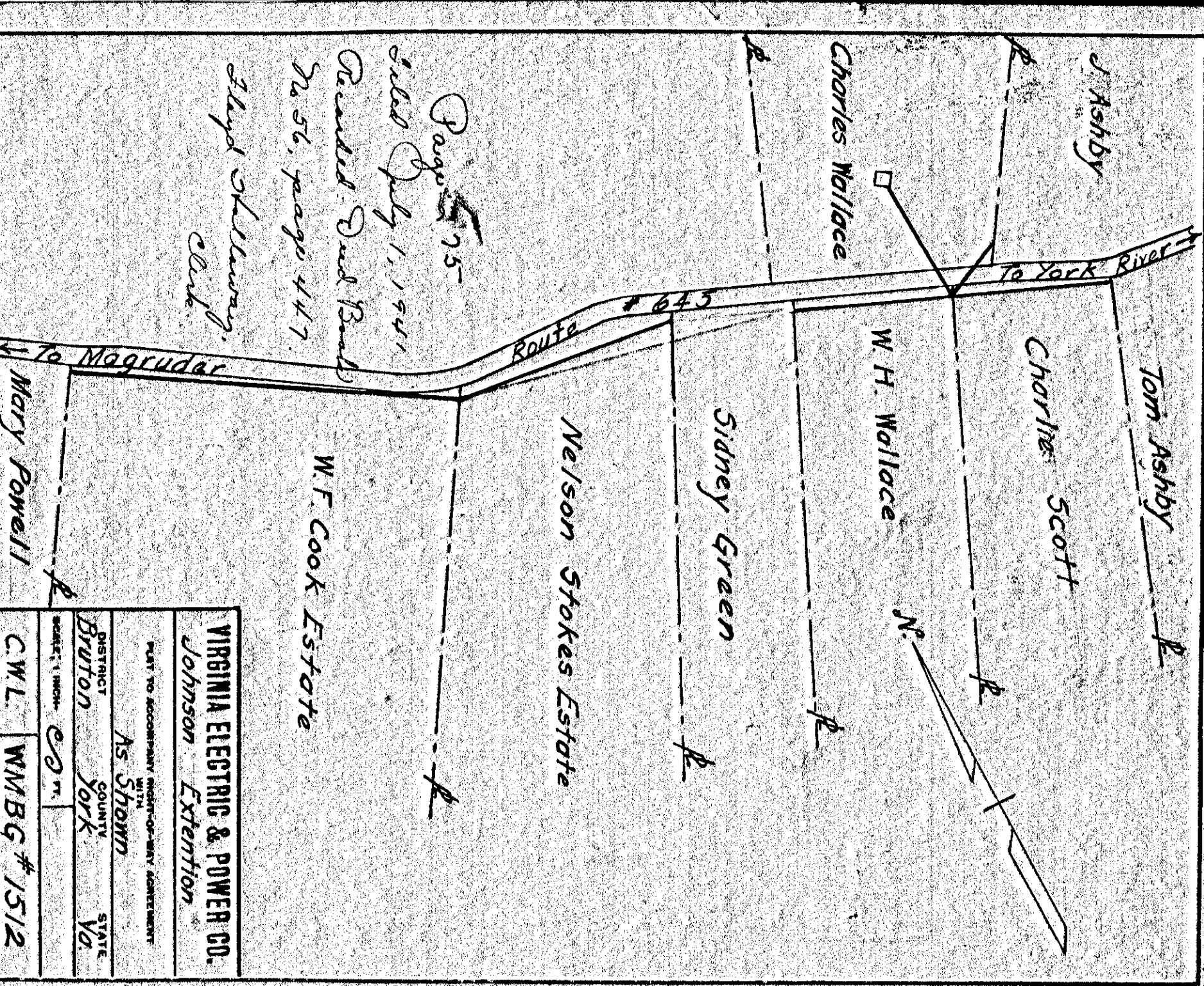

PLAT TO ACCOMPANY RIGHT-OF-WAY AGREEMENT	
VIRGINIA ELECTRIC & POWER CO.	
Johnson Extension	
DISTRICT	As Shown
COUNTY	York
STATE	Va.
DRAWER NO.	CWL WMBG # 1512
SHEET NO.	23 of 24

DRAWER NO. SHEET NO.

575