

PLAT TO ACCOMPANY RIGHT-OF-WAY AGREEMENT  
 WITH  
**VIRGINIA ELECTRIC & POWER CO.**  
 Johnson Extension  
 DISTRICT **As Shown**  
 COUNTY **York**  
 STATE **Va.**  
 SCALE: 1" = 100' **20'**  
 DRAWER NO. **CWL** SHEET NO. **WMBG # 1511**

572

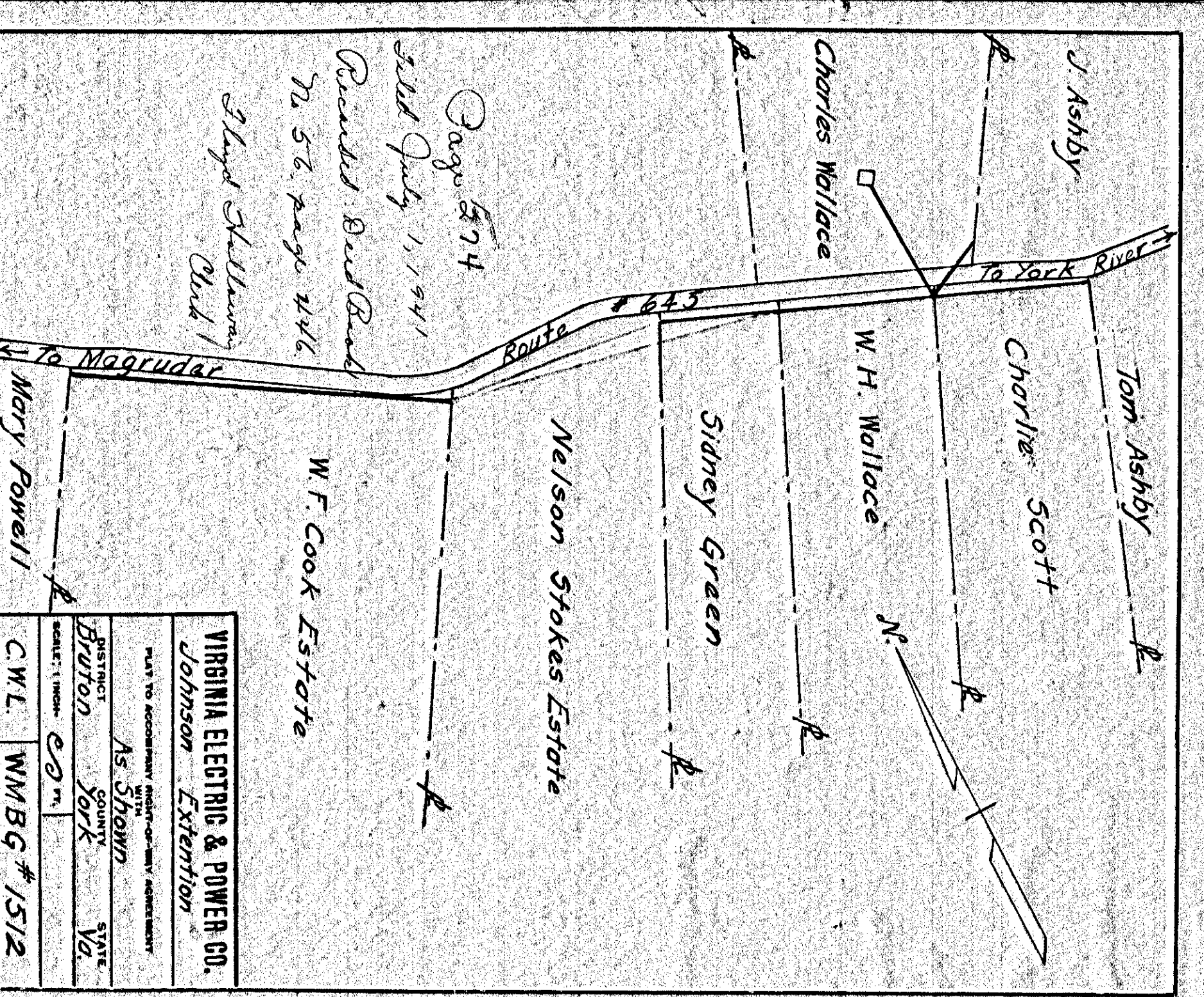

PLAT TO ACCOMPANY RIGHT-OF-WAY AGREEMENT  
 WITH  
**VIRGINIA ELECTRIC & POWER CO.**  
 Johnson Extension  
 DISTRICT **As Shown**  
 COUNTY **York**  
 STATE **Va.**  
 SCALE: 1" = 100' **20'**  
 DRAWER NO. **CWL** SHEET NO. **WMBG # 1512**

574

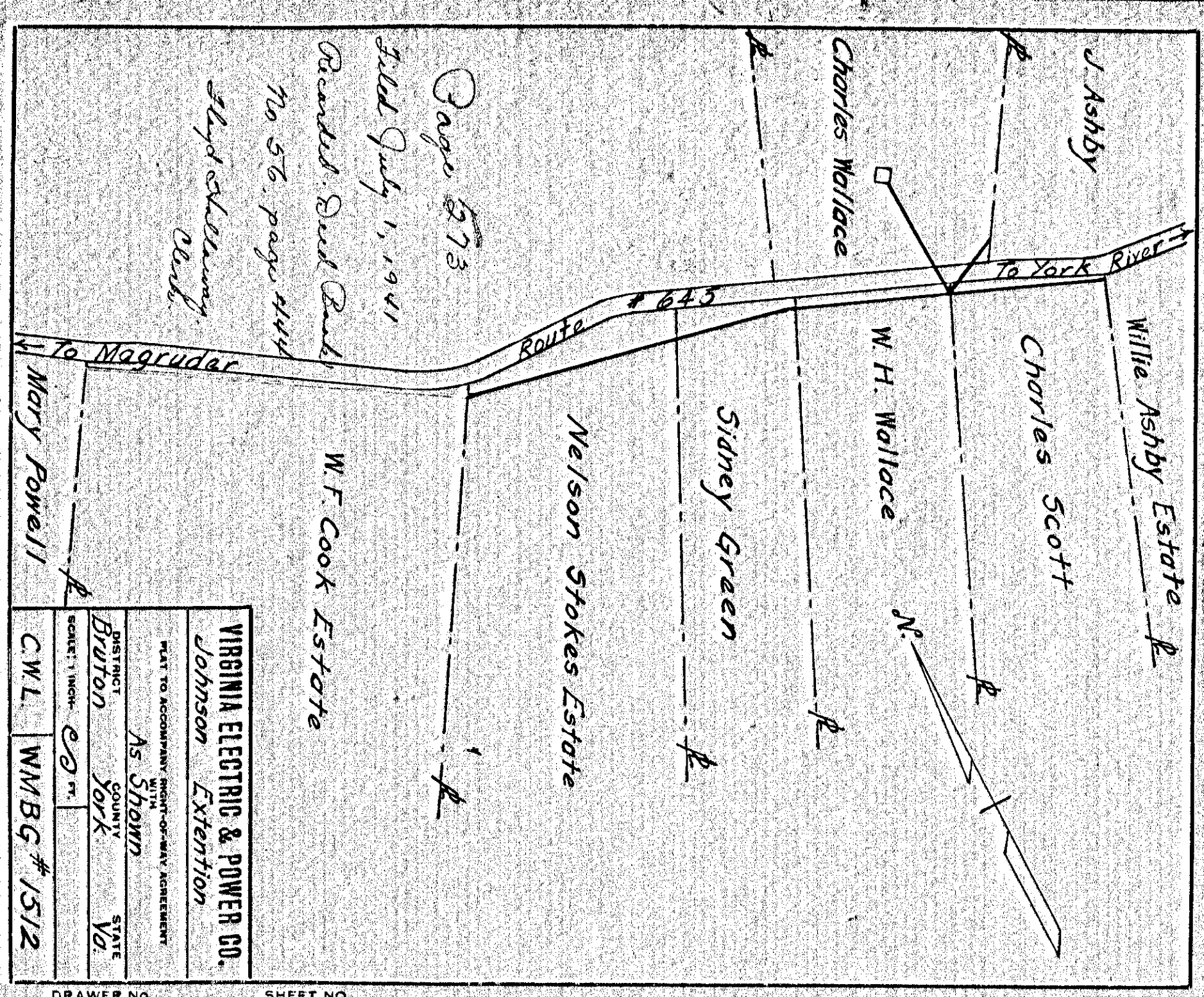

PLAT TO ACCOMPANY RIGHT-OF-WAY AGREEMENT  
 WITH  
**VIRGINIA ELECTRIC & POWER CO.**  
 Johnson Extension  
 DISTRICT **As Shown**  
 COUNTY **York**  
 STATE **Va.**  
 SCALE: 1" = 100' **20'**  
 DRAWER NO. **CWL** SHEET NO. **WMBG # 1512**

573

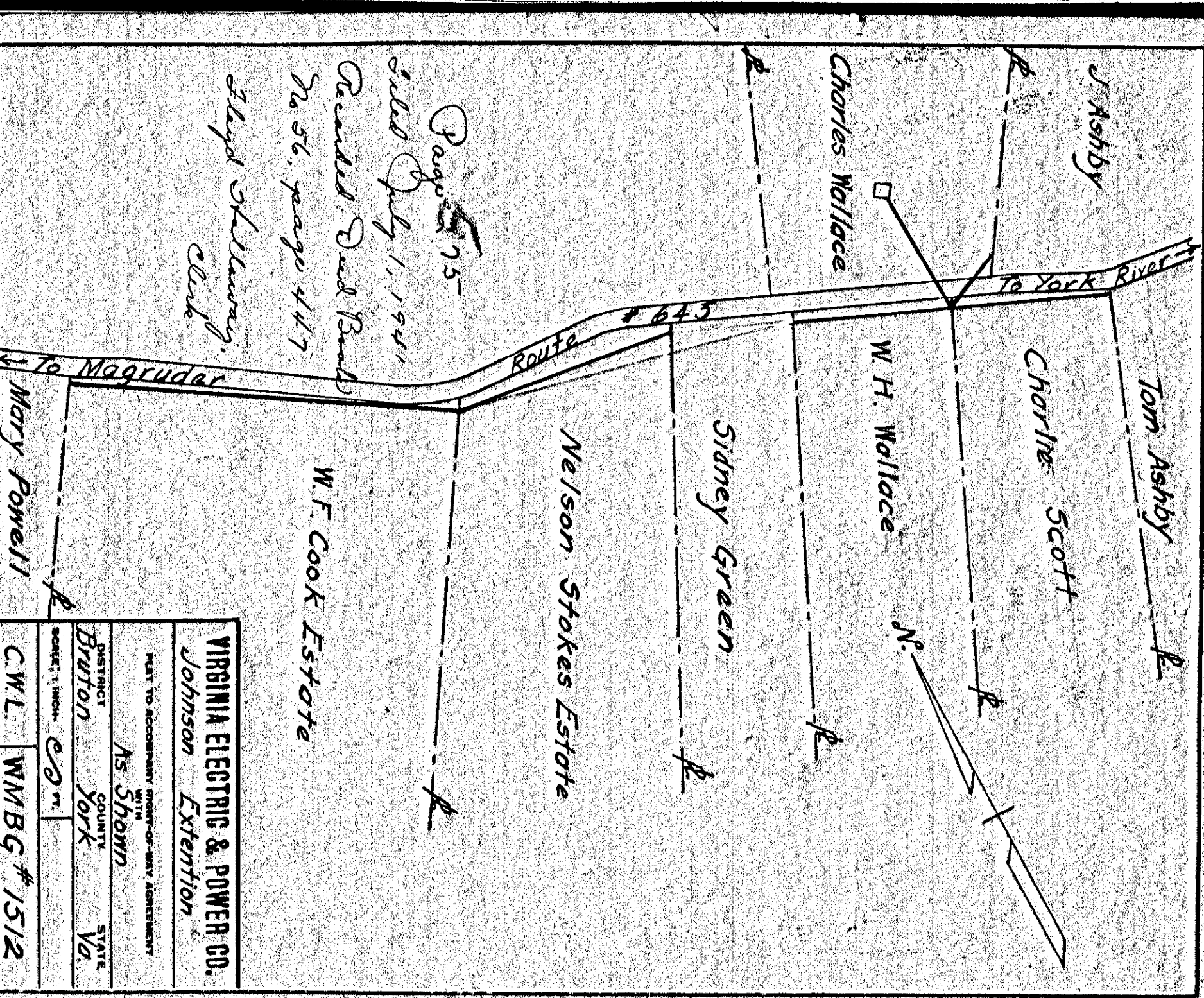

PLAT TO ACCOMPANY RIGHT-OF-WAY AGREEMENT  
 WITH  
**VIRGINIA ELECTRIC & POWER CO.**  
 Johnson Extension  
 DISTRICT **As Shown**  
 COUNTY **York**  
 STATE **Va.**  
 SCALE: 1" = 100' **20'**  
 DRAWER NO. **CWL** SHEET NO. **WMBG # 1512**

575