

STA TO STA	COURSE	DISTANCE
WE WU	8 1/2 00 W	798.4
WU WA	5 3/4 00 W	411.3
WA WT	N 42 3/4 W	668.1
WT WZ	N 22 04 W	601.5
WZ WA	N 60 33 W	719.3
WA WB	S 28 18 W	835.6
WB WC	S 29 33 W	757.8
WC WD	S 51 00 W	618.0
WD WE	S 43 21 W	774.7
WE WF	S 63 32 W	437.6
WF WG	N 11 31 E	523.3
WG WH	S 52 17 W	337.8
WH WI	N 67 13 W	954.1
WI WJ	N 10 03 W	663.4
WJ WK	N 20 41 W	396.4
WK WL	N 49 31 W	218.0
WL WM	S 56 30 W	622.8
WM WN	S 73 51 W	719.1
WN WO	S 78 33 W	1122.6
WO WP	N 73 03 W	1372.9
WP WQ	S 86 14 N	439.7
WQ WR	N 62 36 W	729.4
WR WS	N 31 53 W	446.0
WS WT	S 08 10 W	241.3
WT WX	N 78 30 W	1128.0
WX WY	S 29 53 W	816.1
WY WZ	S 07 41 W	866.8
WZ WA	N 23 12 W	407.0
WA WB	S 03 12 W	561.1
WB WC	N 79 31 W	1084.0
WC WD	S 41 20 W	532.2
WD WE	S 78 33 W	721.7
WE WF	N 62 30 W	572.9
WF WG	S 78 40 W	544.6
WG WH	S 78 11 W	501.7
WH WI	N 7 32 E	643.2
WI WJ	S 28 43 W	493.6
WJ WK	S 08 12 W	314.5
WK WL	N 46 25 W	535.0
WL WM	N 7 12 E	312.2
WM WN	N 57 53 W	1025.0
WN WO	N 3 36 E	816.8
WO WP	N 41 30 W	861.8
WP WQ	N 63 44 W	751.6
WQ WR	S 74 47 W	716.4
WR WS	S 60 44 W	548.6
WS WT	S 41 10 W	488.9
WT WU	S 18 30 W	731.7

STA TO STA	COURSE	DISTANCE
WA WU	S 78 40 E	1072.8
WU WA	S 56 12 E	636.8
WA WB	N 78 32 E	625.7
WB WA	S 33 19 E	425.7
WA WC	S 10 27 E	542.4
WC WA	S 22 27 W	783.4
WA WD	S 41 13 W	1102.9
WD WA	N 33 11 E	379.5
WA WE	S 56 32 E	561.6
WE WA	S 48 42 E	642.8
WA WF	S 10 01 E	410.3
WF WA	N 72 45 E	810.9
WA WG	S 39 50 W	933.0
WG WA	S 3 46 E	607.6
WA WH	S 4 26 W	637.5
WH WA	S 22 12 W	751.1
WA WI	N 42 11 W	751.0
WI WA	S 6 24 E	121.6
WA WJ	N 08 31 W	337.6
WJ WA	N 16 44 W	242.4
WA WK	N 5 12 E	875.4
WK WA	N 18 30 W	410.6
WA WL	N 01 35 W	410.6
WL WA	N 11 12 E	430.6
WA WM	N 46 15 W	430.6
WM WA	N 44 23 E	440.8
WA WN	S 46 05 W	416.3
WN WA	N 13 05 E	214.8
WA WO	N 08 18 W	731.0
WO WA	S 48 04 W	1044.6
WA WP	S 70 48 W	633.8
WP WA	S 16 00 W	488.4

RE-SURVEY OF OYSTER PLANTING GROUNDS
WORMLEYS CREEK
 YORK COUNTY, VIRGINIA.
 1935
 COMMISSION OF FISHERIES

Thos. C. Ruediger
 ENGINEER

Richard C. ...
 COMMISSIONER

SCALE 1:2500



YORK

RIVER

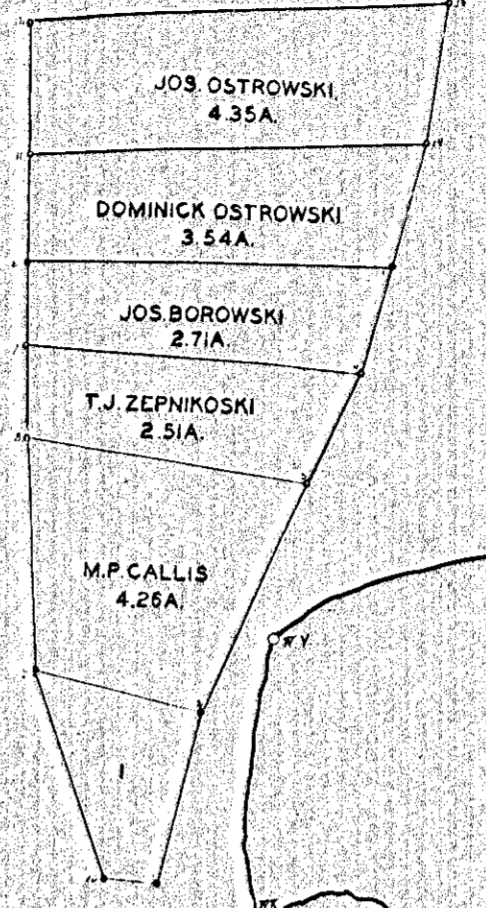

LEWIS, E. HOGGE.
 21.50A.

GEO. E. MORSE.
 8.70A.

F. L. HOGGE & BROS.
 23.70A.

W.T. HUGGINS.
 3.10A.

F.L. HOGGE & BROS.
 2.65A.

J. SAM. HOGGE
 4.47A.

F.L. HOGGE & BROS.
 3.60A.

LUTHER M. CALLIS
 5.65A.

- 1 T. J. ZEPNIKOSKI 1.63 ACRES
- 2 W.H. HOGGE'S EST. 0.50 "
- 3 GEO. E. MORSE. 0.98 "
- 4 JOHN BASTA. 1.40 "
- 5 J. SAM. HOGGE. 3.40 "
- 6 W.H. HOGGE'S EST. 1.75 "
- 7 JOHN BASTA 0.50 "
- 8 M.P. CALLIS 1.32 "
- 9 W.H. HOGGE'S EST. 3.60 "
- 10 T. J. ZEPNIKOSKI 2.95 "
- 11 W.H. HOGGE'S EST. 0.74 "
- 12 M.P. CALLIS 0.62 "
- 13 F.L. HOGGE & BROS. 0.70 "
- 14 W.H. HOGGE'S EST. 4.12 "
- 15 F.L. HOGGE & BROS. 0.50 "

656
 246.

Plan Book No. 1056