

VIRGINIA ELECTRIC & POWER CO.  
 CAMP PEARY EXTENSION  
 PLAT TO ACCOMPANY RIGHT-OF-WAY AGREEMENT  
 DISTRICT  
 BRUTON COUNTY  
 YORK VA STATE  
 SCALE: 1 INCH = 100 FT.  
 SUBMITTED BY  
 WMBG #1655

DRAWER NO. SHEET NO.

664 Note: The Right of Way for the Pond is recorded in

662 Note: The Right of Way for the Pond is recorded in

663 Note: The Right of Way for the Pond is recorded in

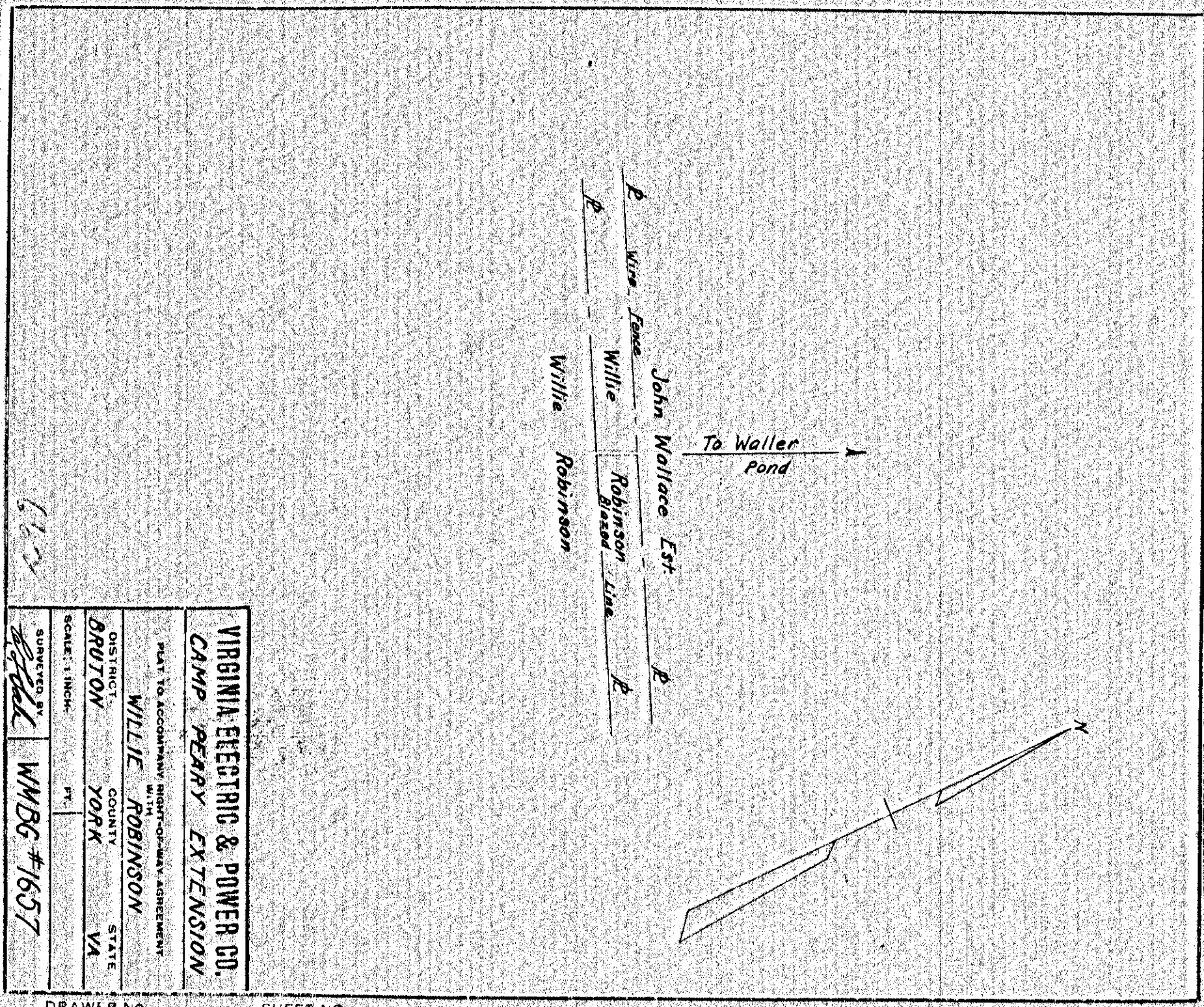

VIRGINIA ELECTRIC & POWER CO.  
 CAMP PEARY EXTENSION  
 PLAT TO ACCOMPANY RIGHT-OF-WAY AGREEMENT  
 DISTRICT  
 BRUTON COUNTY  
 YORK VA STATE  
 SCALE: 1 INCH = 100 FT.  
 SUBMITTED BY  
 WMBG #1657

DRAWER NO. SHEET NO.

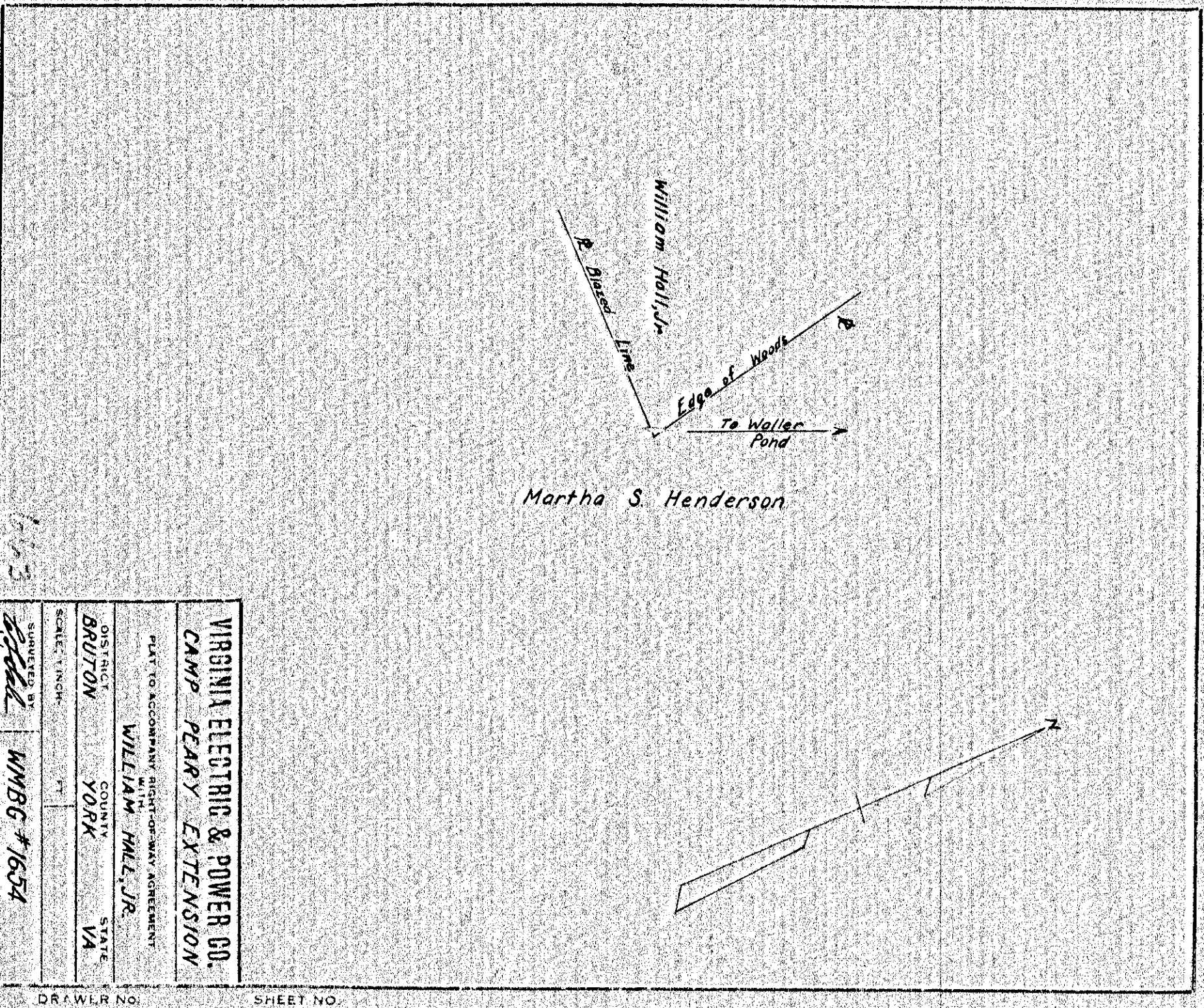

VIRGINIA ELECTRIC & POWER CO.  
 CAMP PEARY EXTENSION  
 PLAT TO ACCOMPANY RIGHT-OF-WAY AGREEMENT  
 DISTRICT  
 BRUTON COUNTY  
 YORK VA STATE  
 SCALE: 1 INCH = 100 FT.  
 SUBMITTED BY  
 WMBG #1654

DRAWER NO. SHEET NO.