

Note:  
Location of York River  
from point "L" to "M"  
from map by Hugh R. Noel.

Map of 2 parcels of land "A" & "B", containing 15.75 acres situated on the southside of the York River, and east of Wormleys Creek, York County, Virginia.  
Said land being a portion of Waterview Farm and standing in the name of Jamestown Corp. July 16, 1941.  
Scale 1" = 100'

J. Temple Waddill  
Certified Civil Engineer  
Richmond, Virginia. N.B. 128 PI F.P. 156

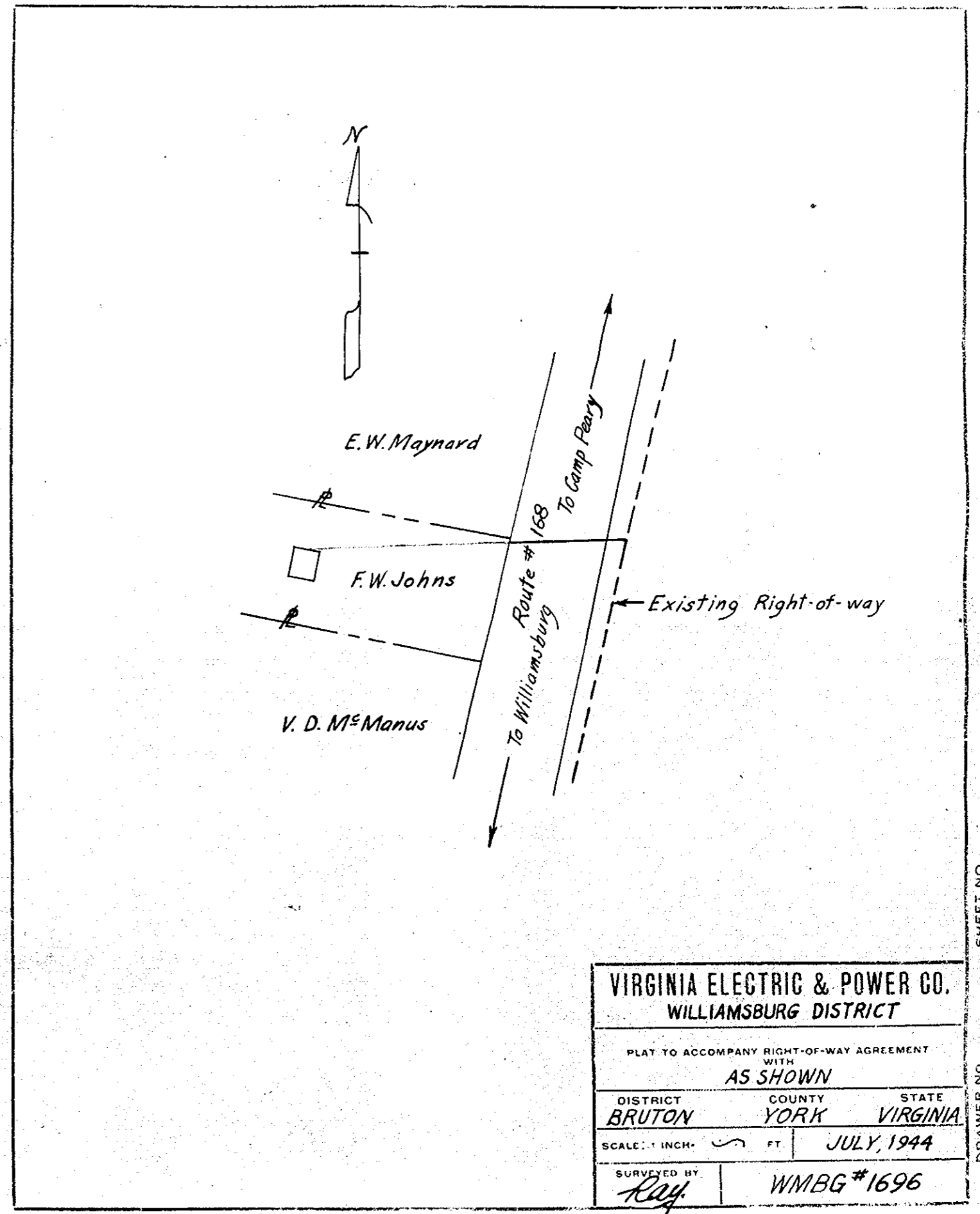

VIRGINIA ELECTRIC & POWER CO. WILLIAMSBURG DISTRICT		
PLAT TO ACCOMPANY RIGHT-OF-WAY AGREEMENT WITH AS SHOWN		
DISTRICT BRUTON	COUNTY YORK	STATE VIRGINIA
SCALE: 1 INCH = 100 FT.		JULY, 1944
SURVEYED BY Ray		WMBG #1696

DRAWER NO. SHEET NO.