

Plat Book No. 4 Page 59

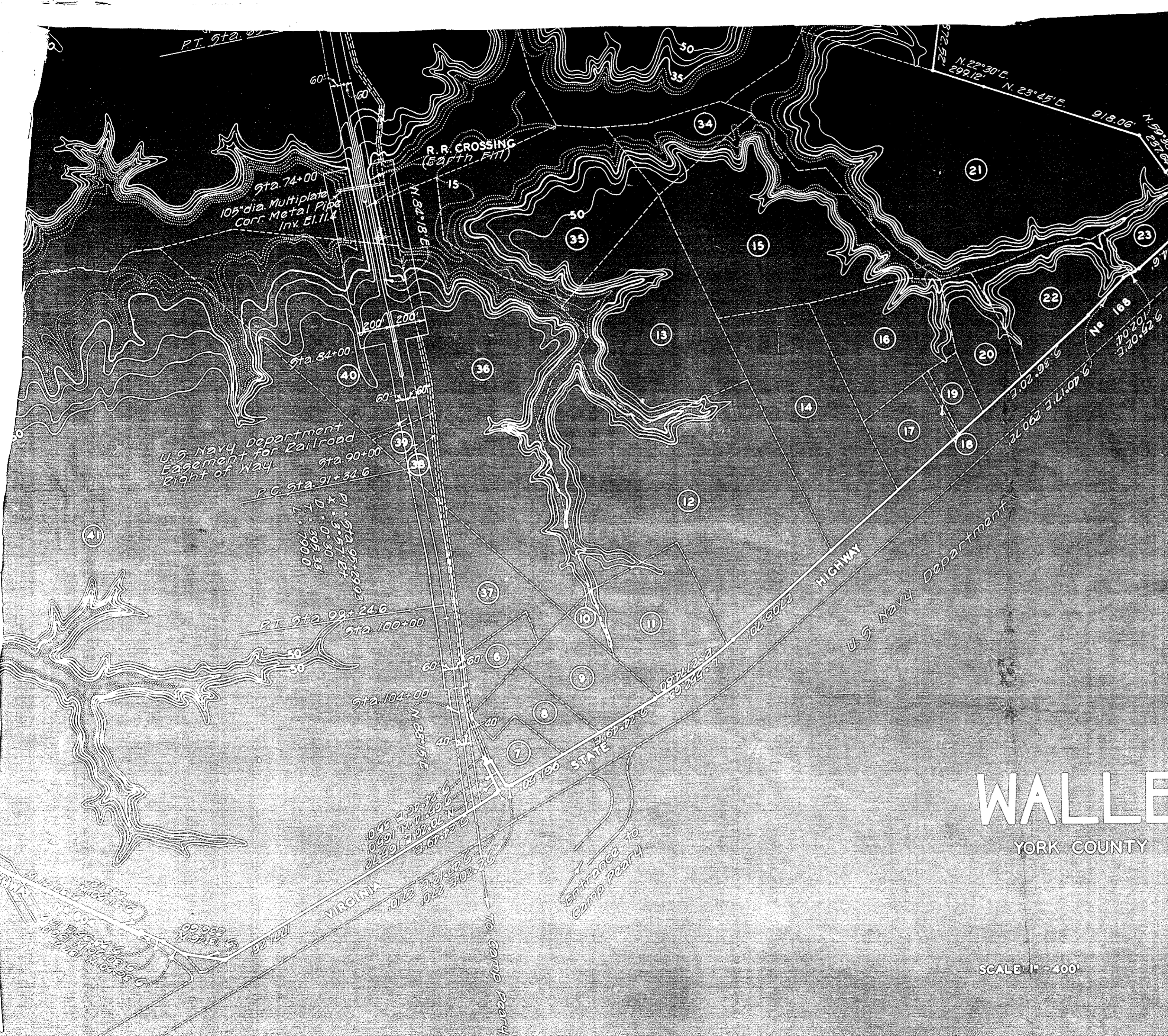

DOCKET NO VA 44-907
 FEDERAL WORKS AGENCY

MAP OF WALLER RESERVOIR

YORK COUNTY VIRGINIA

NEWSOM AND ALDRICH
 ENGINEER - CONSULTANTS
 NEW YORK - WILLIAMSBURG

SCALE: 1" = 400'

JUNE-1943

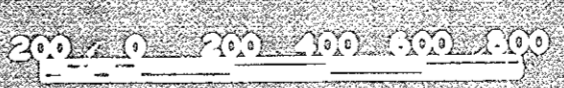

NOTE: The boundary lines of this map have been compiled from the extant property lines of the individual surveys of the parcels as listed in the schedule.
 Elevations are in feet from U.S.A.S. datum.
 Contour interval 5 feet.
 Grillwork El. 35.0 Top of flashboards El. 37.0
 Area of reservoir at El. 35.0: 293 Acres
 300 plates filled with this map for surveys of the individual parcels.

Plat Book No. 4 Page 59

Francis D. McMillan
 SURVEYOR
 Reg. No. 197
 DRAWING NO. UCA-5