

Plat Book No. 3, page 272

DATE OF APPLICATION	COMMONWEALTH OF VIRGINIA COMMISSION OF FISHERIES	FOR OFFICE USE
DATE OF ASSIGNMENT		PLAT NO.
COUNTY RECORDED IN		MAP NO.
BOOK PAGE		FILE NO.
No. No.		

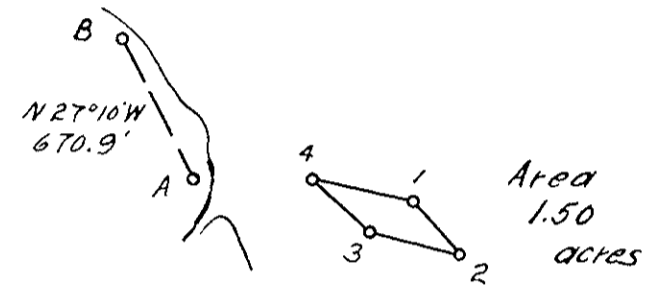

A	B	C	D
122°39'	1	326°55'	
132°39'	2	329°50'	
133°00'	3	334°38'	
118°30'	4	333°21'	
	A	360°00'	
360°00'	B		
142°27'		325°31'	Red Beacon (Candy Pt)
138°32'		321°28'	Black " (Green Pt)
342°33'			Lone Chy. Beni. Riggins' lse.
305°48'			S. gable Riggins' Bungalow
275°34'			N. " barn nearby
		99°33'	Peak of tip roof G. Claverous Dml.
		148°19'	E. gable Shields' lse.
		129°25'	S. " Wilkx Bungalow

OYSTER PLANTING GROUND
 OF
L. T. Dawson
 IN
Sand Box
 District No. 15 York COUNTY
 Scale $\frac{1}{10000}$ June 18 1937
 Surveyed by L. T. Dawson
 Per [Signature]
 Com 7, C. 35

