

D.B. # 68 p 343

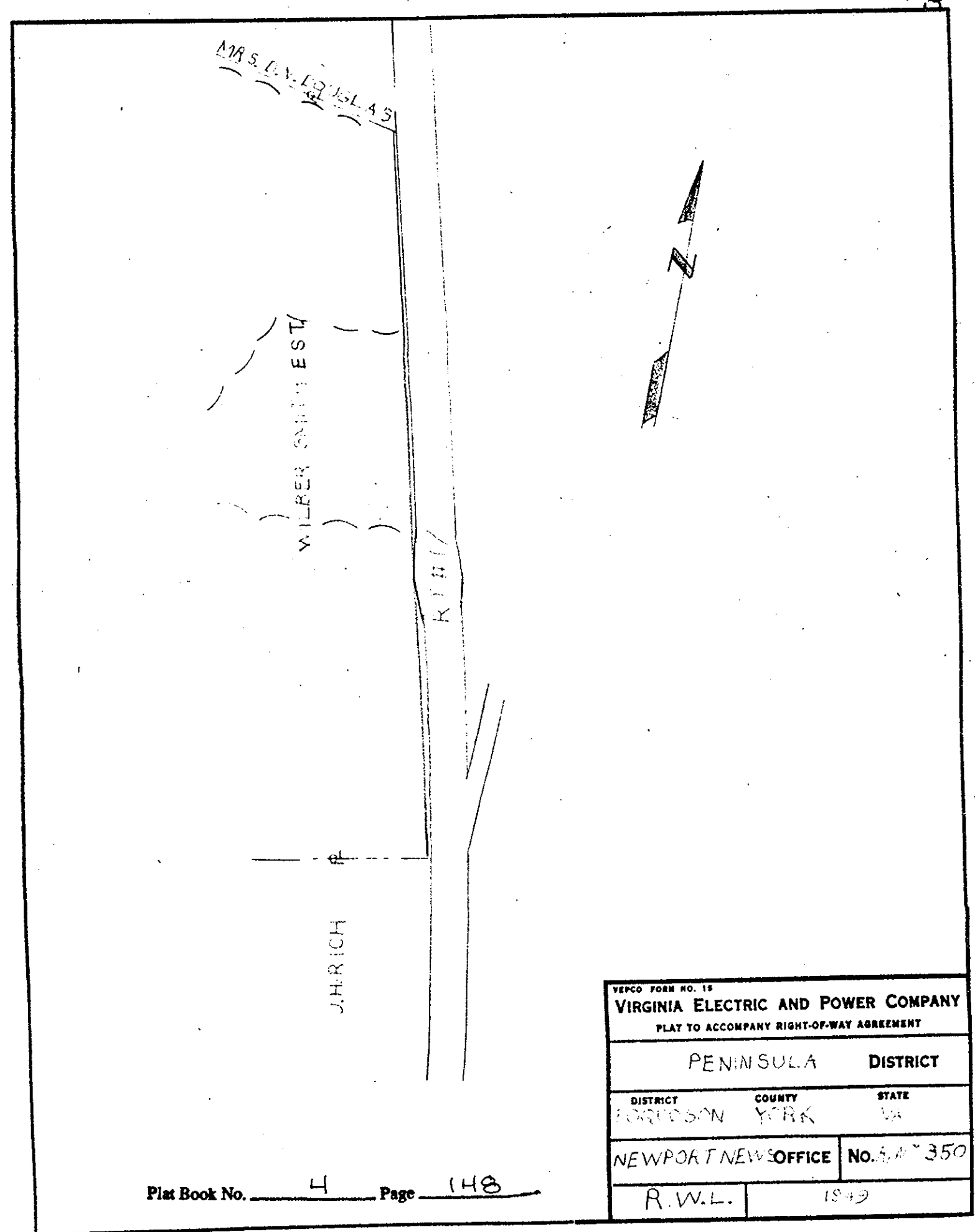

VEPCO FORM NO. 13  
**VIRGINIA ELECTRIC AND POWER COMPANY**  
 PLAT TO ACCOMPANY RIGHT-OF-WAY AGREEMENT

PENINSULA DISTRICT

DISTRICT COUNTY STATE  
 PENINSULA YORK VA.

NEWPORT NEWS OFFICE NO. 350

R.W.L. 1949

Plat Book No. 4 Page 148

ALBANY, N.Y. 1949

D.B. # 68-344

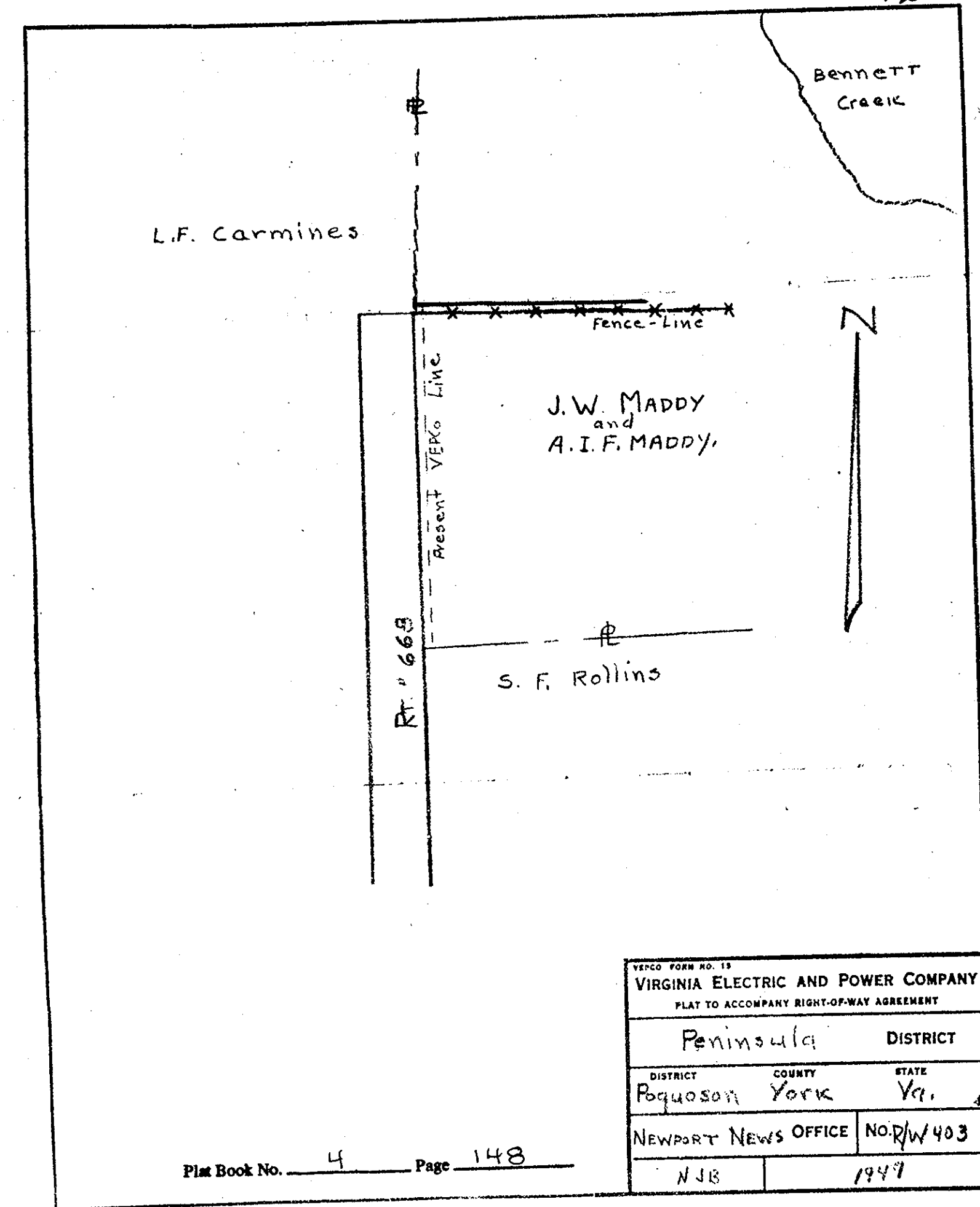

VEPCO FORM NO. 13  
**VIRGINIA ELECTRIC AND POWER COMPANY**  
 PLAT TO ACCOMPANY RIGHT-OF-WAY AGREEMENT

Peninsula DISTRICT

DISTRICT COUNTY STATE  
 Poquoson York Va.

NEWPORT NEWS OFFICE NO. RW 403

NJB 1949

Plat Book No. 4 Page 148

ALBANY, N.Y. 1949

D.B. # 68 p 340

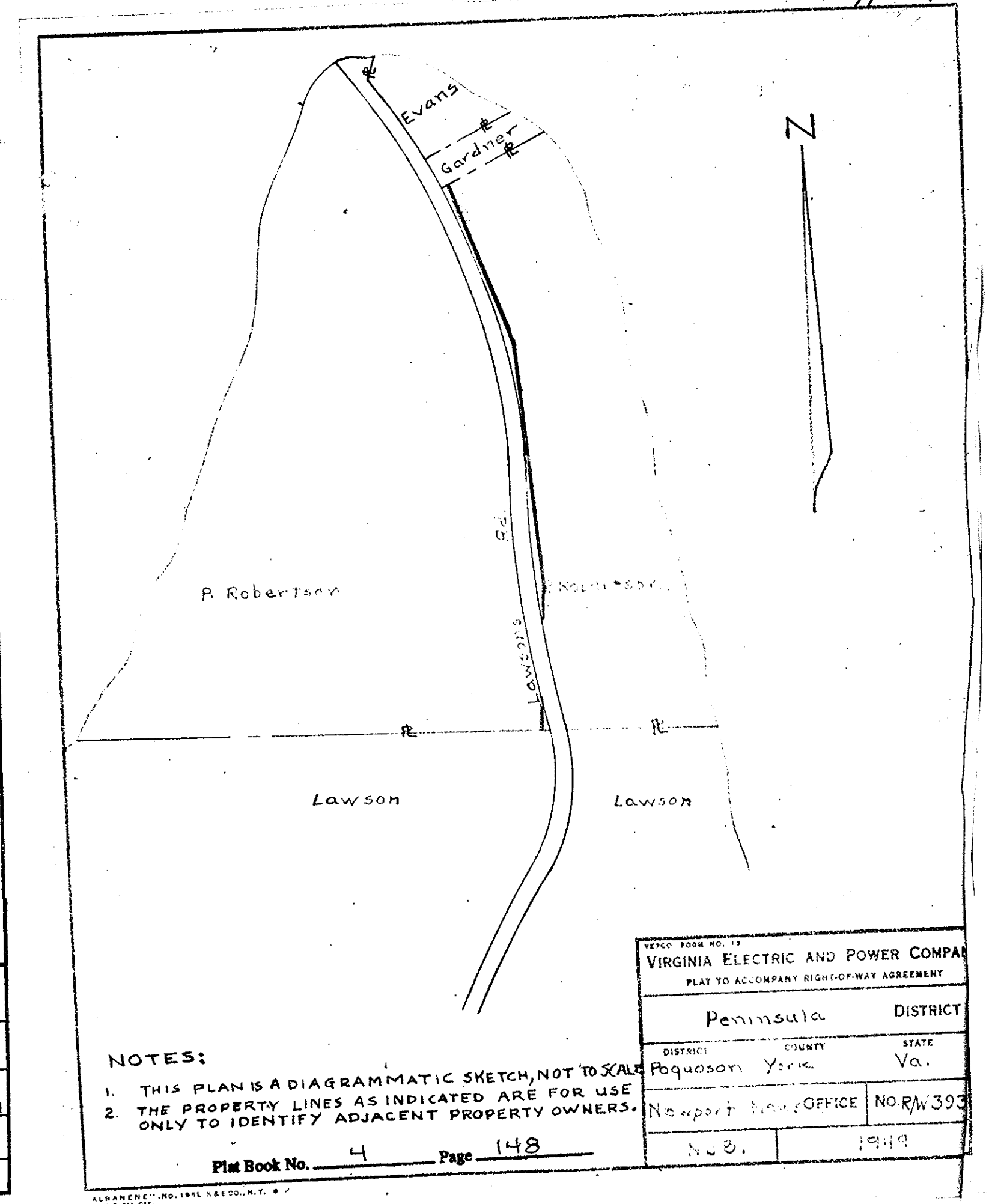

VEPCO FORM NO. 13  
**VIRGINIA ELECTRIC AND POWER COMPANY**  
 PLAT TO ACCOMPANY RIGHT-OF-WAY AGREEMENT

Peninsula DISTRICT

DISTRICT COUNTY STATE  
 Poquoson York Va.

NEWPORT NEWS OFFICE NO. RW 393

NJB 1949

NOTES:

1. THIS PLAN IS A DIAGRAMMATIC SKETCH, NOT TO SCALE.
2. THE PROPERTY LINES AS INDICATED ARE FOR USE ONLY TO IDENTIFY ADJACENT PROPERTY OWNERS.

Plat Book No. 4 Page 148

ALBANY, N.Y. 1949