

Plat Book No. 4 Page 191

Deed Bk. 3, p. 337

DATE OF APPLICATION		COMMONWEALTH OF VIRGINIA COMMISSION OF FISHERIES	FOR OFFICE USE	
DATE OF ASSIGNMENT			PLAT NO.	
COUNTY RECORDED IN			MAP NO.	241
BOOK	PAGE		FILE NO.	

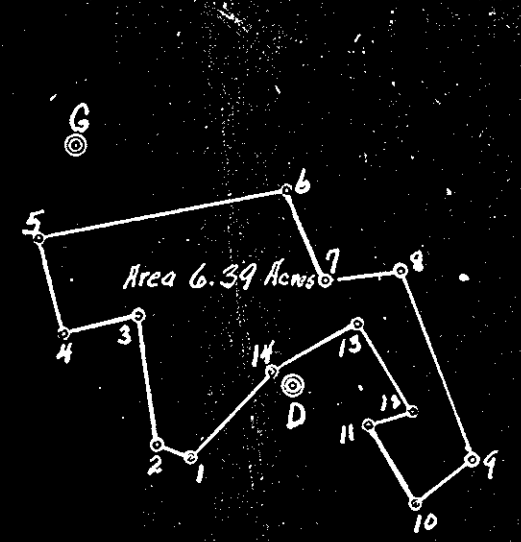

D	C	C
360°00' K	360°00'	
164°23' C	75°51'	
341°30' 1	80°25'	
352°41' 2	74°51'	
41°40' 3	99°10'	
30°19' 4	117°05'	
47°04' 5	18°22'	
105°24' 6	35°50'	
123°08' 7	27°51'	
144°34' 8	44°38'	
218°45' 9	53°09'	318°12'
241°33' 10	50°33'	327°08'
225°33' 11	45°08'	325°10'
209°14' 12	36°07'	336°22'
154°24' 13	55°38'	
45°10' 14	61°14'	
301°47'	345°24'	
135°47'	21°04'	
194°55'		360°00'

N.W. cor Hicks hse North
 N.W. cor Smith hse South side of creek
 W gable Smith hse South

OYSTER PLANTING GROUND

OF
J.E. Hall
 IN
Cheesemans Creek
 District No. 15 York COUNTY
 Scale $\frac{1}{5000}$ Oct 19 1950
 Surveyed by J.K. Simelka A.S. 485 -
 CERTIFIED SURVEYOR

Station D is a 3/4 pipe
 C is a concrete block
 K is an old piece of 2x4
 with a nail for center.

Book 1A page 25

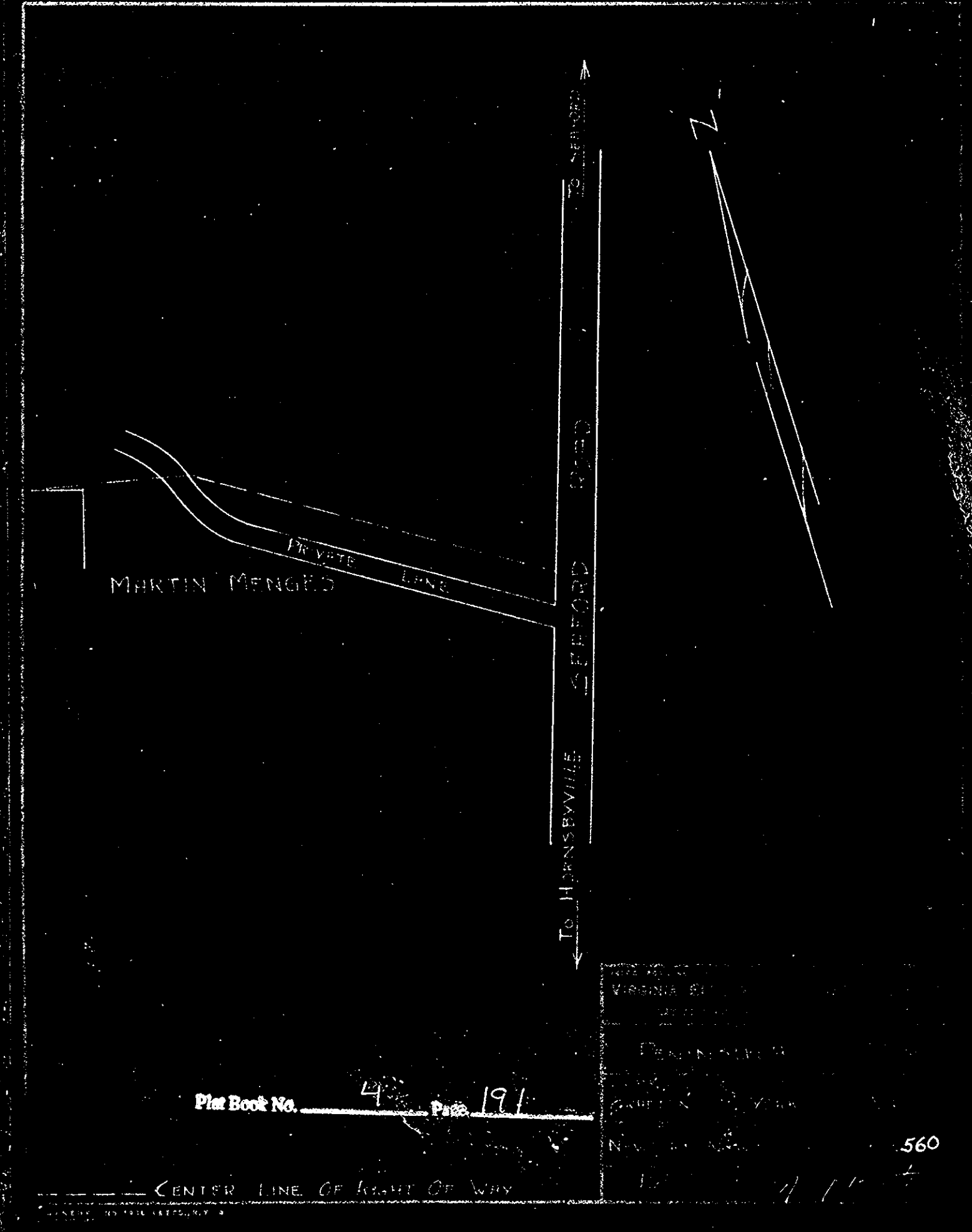
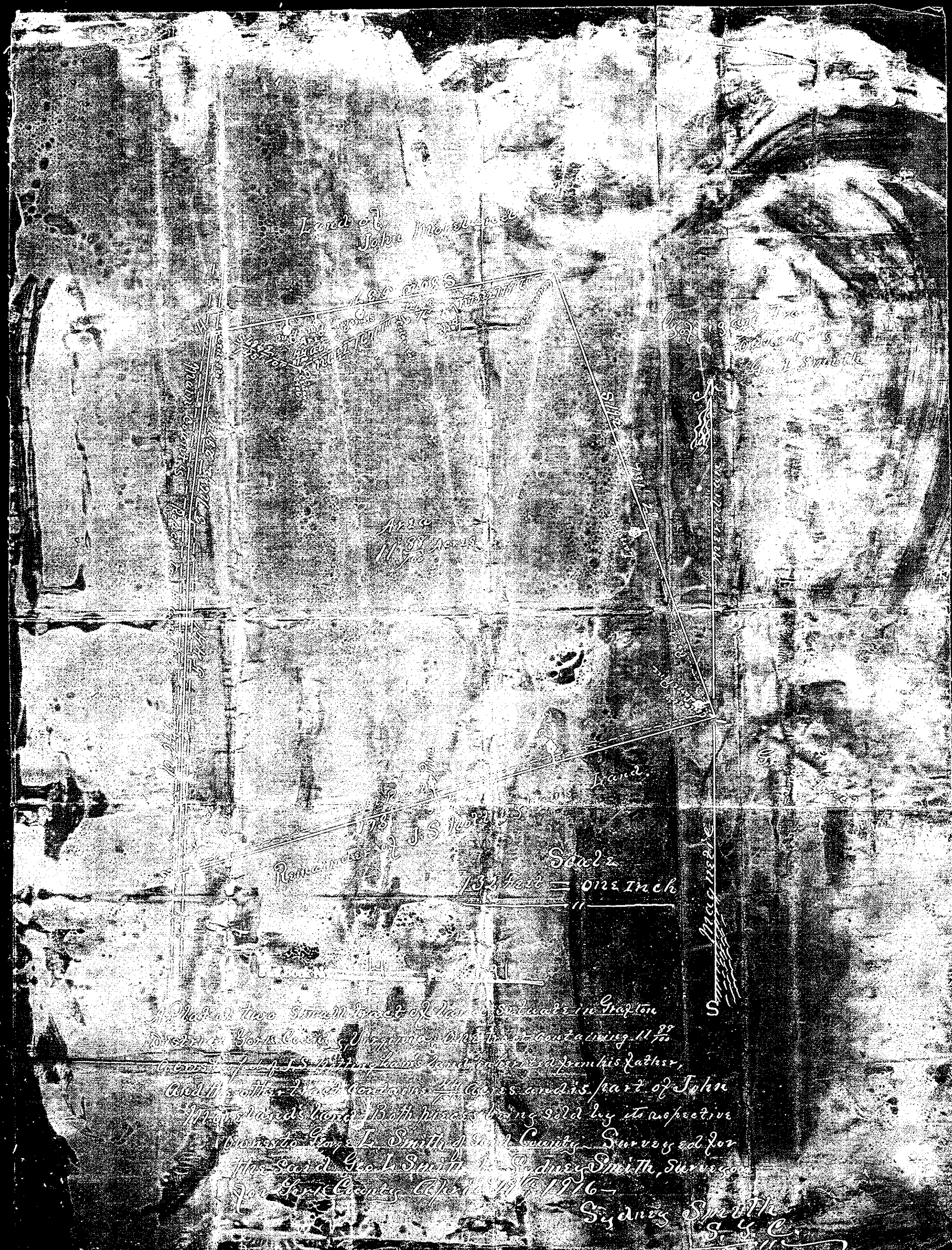

Plat Book No. 4 Page 191