

Oyster Bank 3, page 359

DATE OF APPLICATION		<b>COMMONWEALTH OF VIRGINIA COMMISSION OF FISHERIES</b>	FOR OFFICE USE	
DATE OF ASSIGNMENT			PLAT NO.	
COUNTY RECORDED IN			MAP NO. 248	
BOOK No.	PAGE No.		FILE NO.	

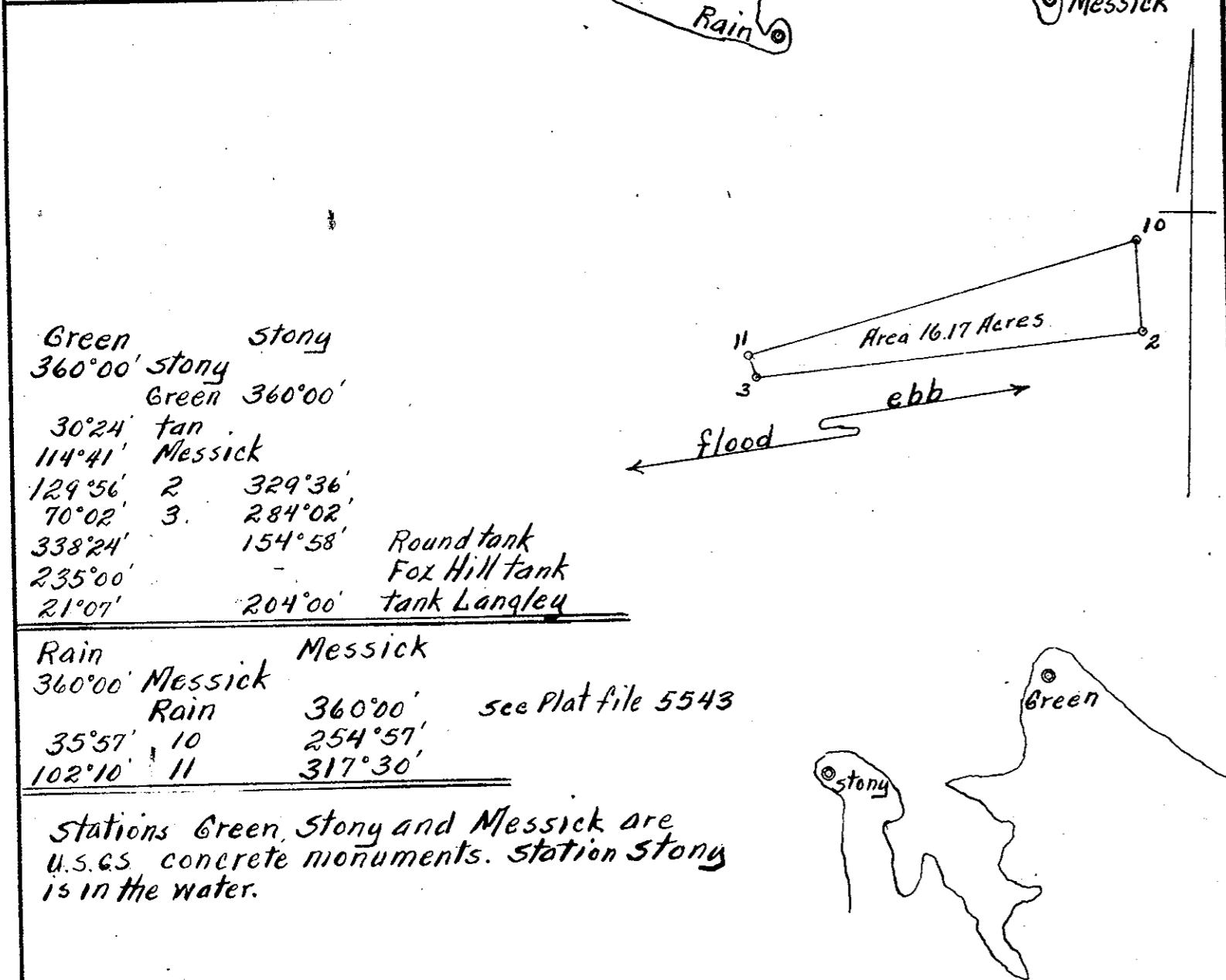

**OYSTER PLANTING GROUND**  
OF  
W. G. Evans  
Back River (off Messick Point)  
District No. 17 York COUNTY  
Scale 10000  
Surveyed by J. K. S. Aug. 9 1951  
4A-10

Oyster Bank 3, page 361

DATE OF APPLICATION		<b>COMMONWEALTH OF VIRGINIA COMMISSION OF FISHERIES</b>	FOR OFFICE USE	
DATE OF ASSIGNMENT			PLAT NO.	
COUNTY RECORDED IN			MAP NO.	
BOOK No.	PAGE No.		FILE NO.	67

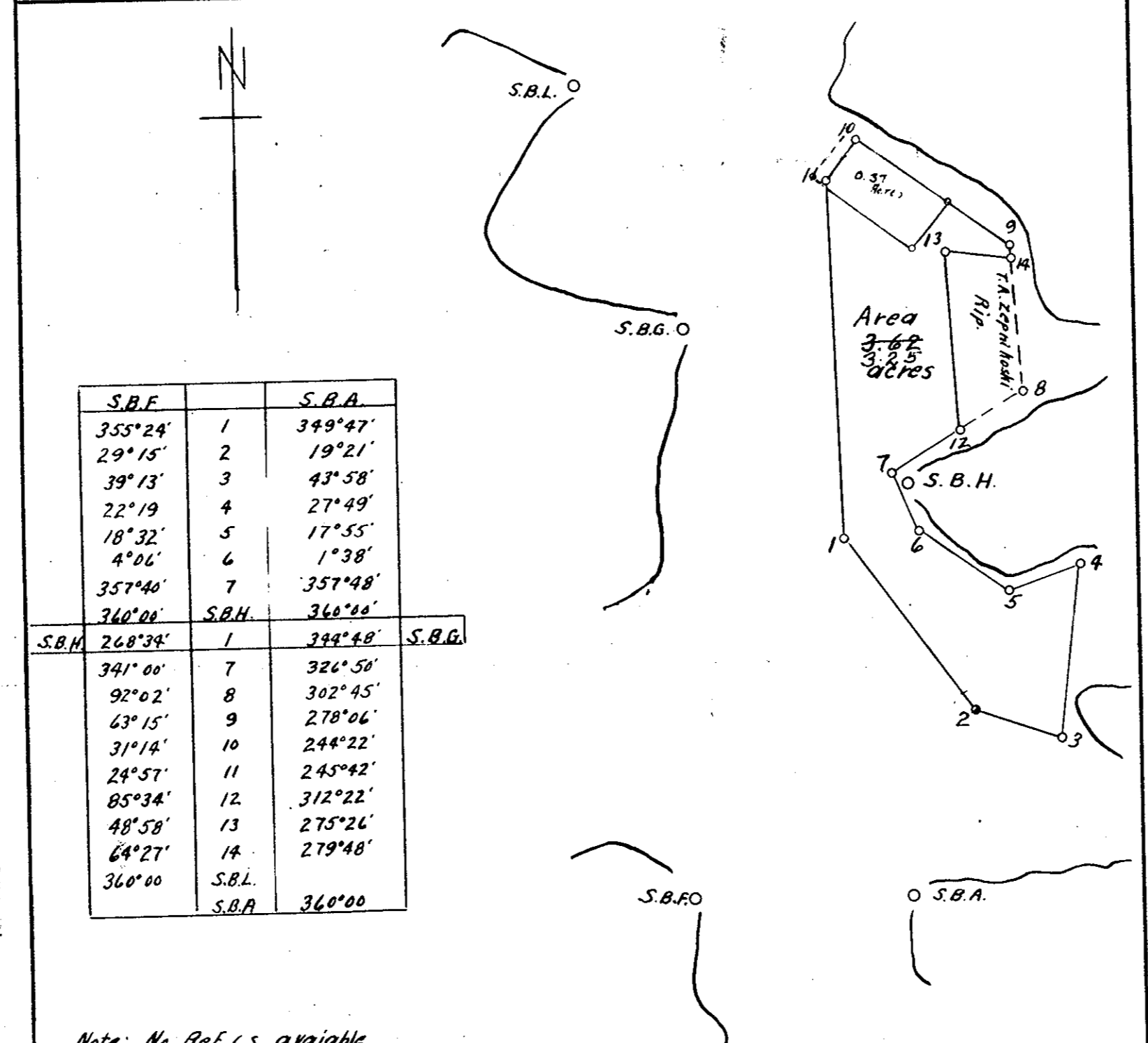

**OYSTER PLANTING GROUND**  
OF  
Geo. E. Morse  
Wormleys Creek  
District No. 15 York COUNTY  
Scale 2500  
Surveyed by J.H. Barber July 8 1946

Oyster Bank 2, page 360

DATE OF APPLICATION		<b>COMMONWEALTH OF VIRGINIA COMMISSION OF FISHERIES</b>	FOR OFFICE USE	
DATE OF ASSIGNMENT			PLAT NO.	
COUNTY RECORDED IN			MAP NO. 246	
BOOK No.	PAGE No.		FILE NO.	

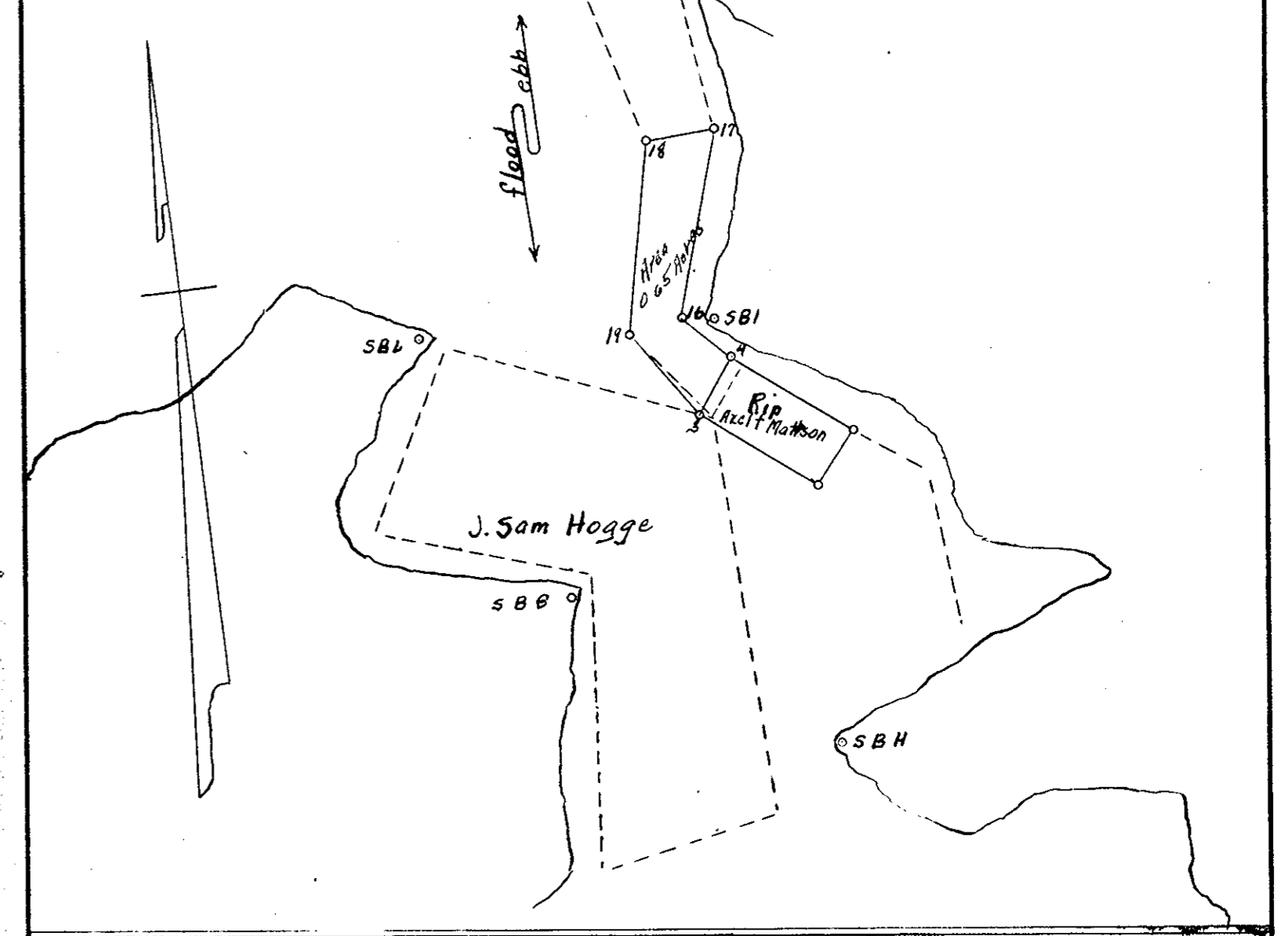

**OYSTER PLANTING GROUND**  
OF  
F.L. Hogge & Bros  
Wormleys Creek  
District No. 15 York COUNTY  
Scale 2500  
Surveyed by J.K. Simelain May 23 1951

This plat takes the place of plat No. 13, Map 246, 0.70 Acres, 0.05 Acres taken out as a part of a Riparian for Axel T. Mattson