

COMMONWEALTH OF VIRGINIA  
COMMISSION OF FISHERIES

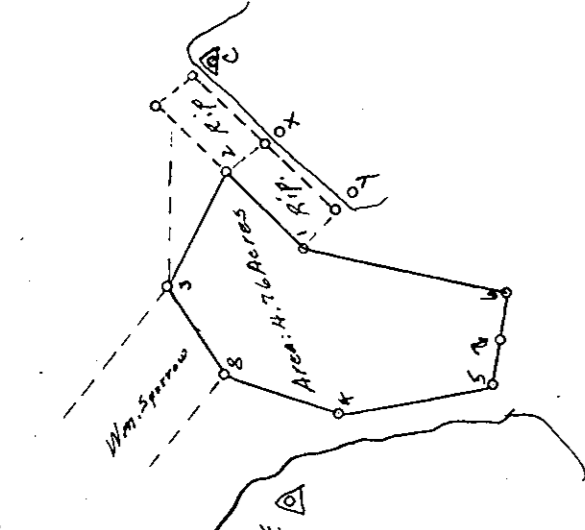

Y	E	Y3
	360'00'	360'00'
E	367'28'	28'31'
1	337'16'	87'07'
4	17°33'	351'05'8"
5	48°22'	313'00'
6	34°11'	291'32'
7	46°26'	303'48'
F	E	F
	360'00'	179'40'
ONE		360'00'
C		57°35'
3	40°17'	28°07'
8	42'06'	44'03'

Plat Book No. 5 Page 199

OYSTER PLANTING GROUND

Area: 4.26 Acres  
OF  
Wm. T. Sparrow  
IN  
Cheese-man York COUNTY

District No. 15 Scale 5,000  
Surveyed by Charles J. Lewis  
N.B. K-3, 12257  
CERTIFIED SURVEYOR

Recorded June 26, 1955  
W.D. Beyer, Clerk

COMMONWEALTH OF VIRGINIA  
COMMISSION OF FISHERIES

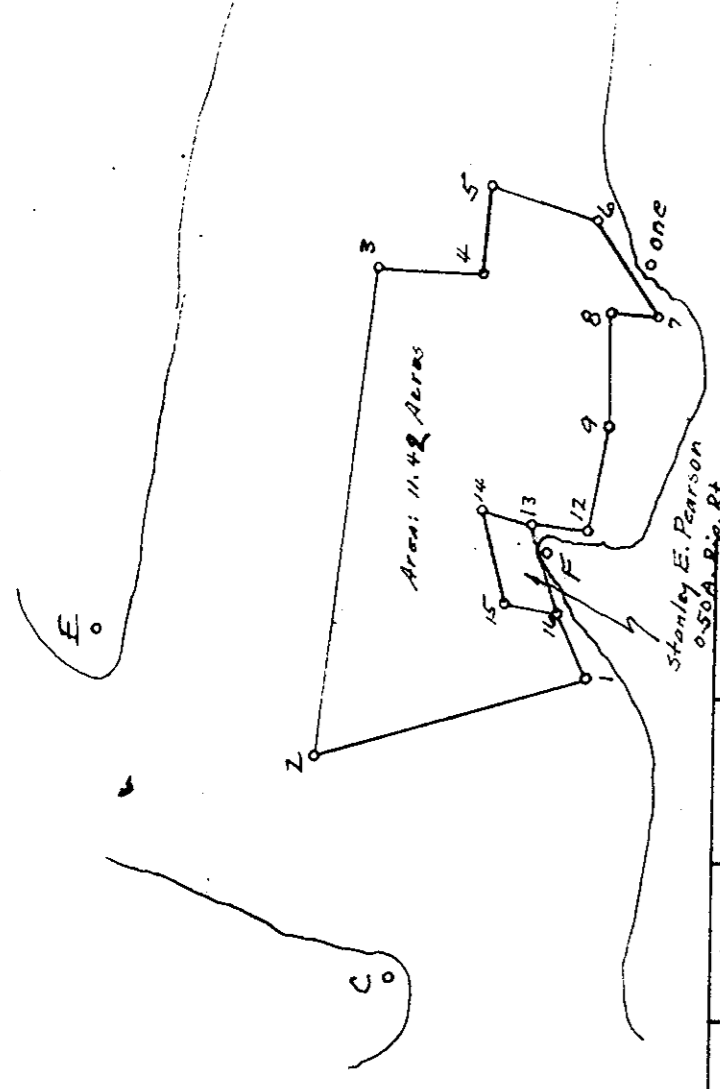

C	F	F
	360'00'	60'24'
1	322'02'	15'28'
2	28'03'	40'10'
3	129'39'	317'49'
4	147'45'	327'43'
5	151'24'	527'58'
6	128'37'	330'55'
7	185'22'	348'33'
8	174'58'	348'17'
9	145'22'	348'17'
10	221'08'	372'09'
H		360'00'
		324'03'
		360'00'
NOTE		30'57'
5. E. H. H.		147'49'
5. E. H. H.		147'49'
S. E. H. H.		69'23'
W. E. H. H.		241'55'
W. E. H. H.		210'42'

Note: This survey includes and takes place of 11.92 Acres.

Plat Book No. 5 Page 199

OYSTER PLANTING GROUND

Area: 11.42 Acres  
OF  
J. E. Hall  
IN  
Cheese-man York COUNTY

District No. 15 Scale 5,000  
Surveyed by Charles J. Lewis  
N.B. K-3, 12257  
CERTIFIED SURVEYOR

Recorded June 26, 1955  
W.D. Beyer, Clerk

COMMONWEALTH OF VIRGINIA  
COMMISSION OF FISHERIES

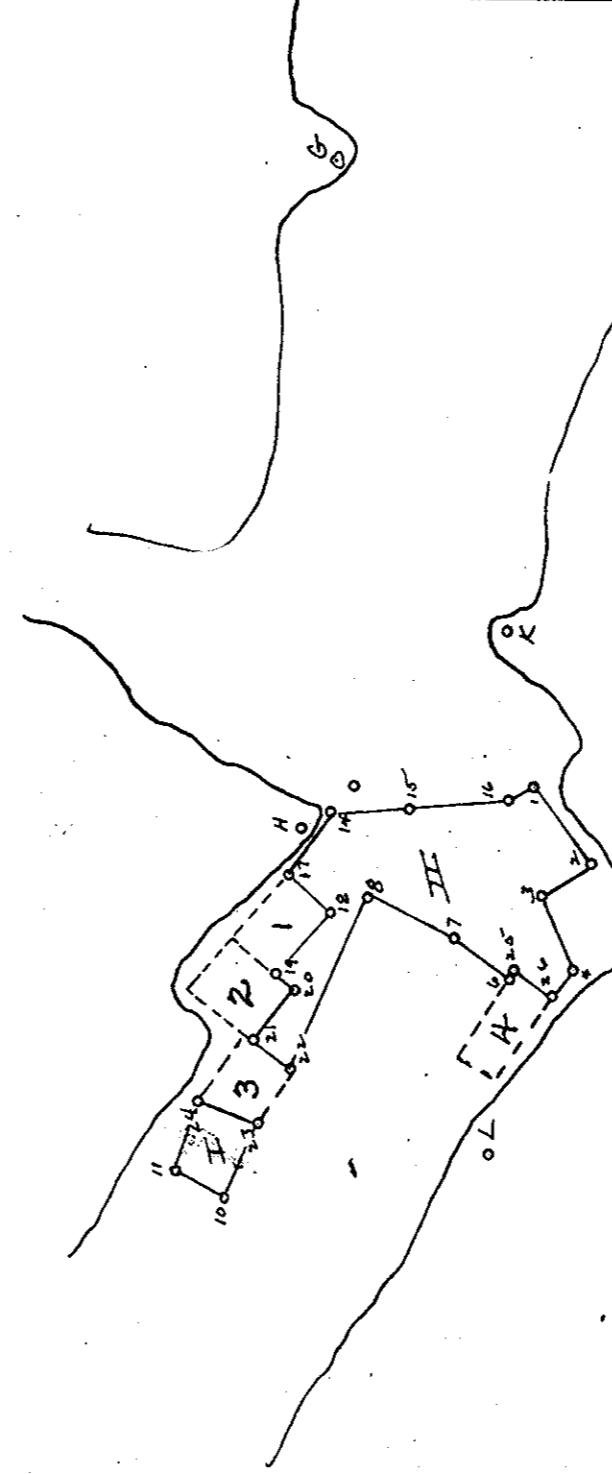

G	H	L	K
	360'00'	146'26'	113'22'
K	43'35'	146'26'	360'00'
1	27°52'	154'14'	360'00'
2	95'08'	43'36'	243'27'
3	103'08'	155'16'	326'40'
4	114'45'	187'05'	302'43'
6	221'34'	136'13'	144'26'
7	121'31'	136'13'	144'26'
8	129'45'	120'02'	144'26'
10	187'46'	43'27'	144'26'
11	176'46'	47'34'	144'26'
14	67'43'	122'24'	144'26'
15	77'20'	132'26'	144'26'
16	80'35'	147'03'	144'26'
M		360'00'	144'26'
H		144'26'	144'26'
P		24'08'	0'20'
G	H	L	K
	360'00'	21'43'	320'17'
K	146'07'	357°01'	320'17'
17	193°12'	357°01'	320'17'
18	157'12'	357°01'	320'17'
19	187°53'	339'47'	320'17'
20	180°09'	339'52'	320'17'
21	189°54'	325'35'	320'17'
22	178°54'	322'43'	320'17'
23	185°26'	307°19'	320'17'
24	197'25'	378'17'	320'17'
3. E. H. H.		268'57'	357'45'
H		360'00'	360'00'

Note: This map includes and takes place of 5.75 Acres.

OYSTER PLANTING GROUND

Area: 5.75 Acres  
OF  
J. E. Hall  
IN  
Cheese-man York COUNTY

District No. 15 Scale 5,000  
Surveyed by Charles J. Lewis  
N.B. K-3, 11  
CERTIFIED SURVEYOR

Recorded June 26, 1955  
W.D. Beyer, Clerk

COMMONWEALTH OF VIRGINIA  
COMMISSION OF FISHERIES

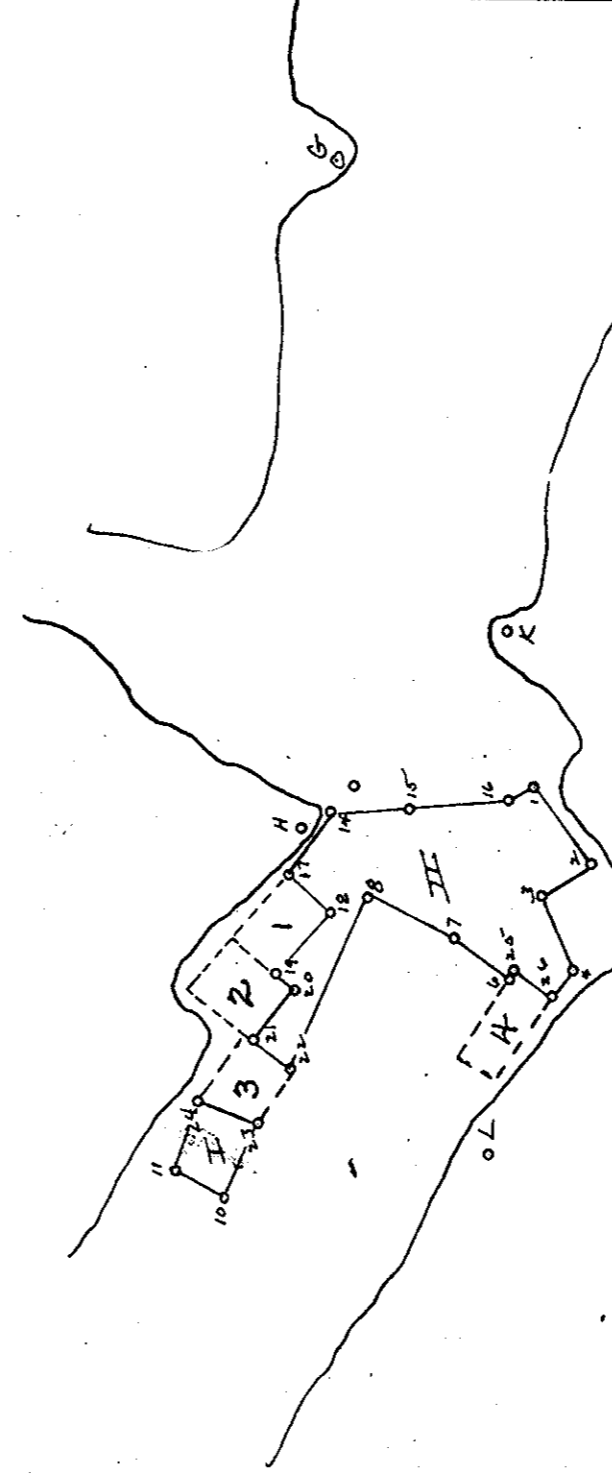

F	E	F
	360'00'	59'45'40"
E		10'22'52"
C		360'00'
1		35'6'03"
2		35'2'42"
3		120'54"
4		7'39'
		16'58"
		329'34"

Note: This map of 0.50 acres comes out of J.E. Hall's 11.92 A. tract.

Plat Book No. 5 Page 199

OYSTER PLANTING GROUND

Area: 0.50 Acres  
OF  
J. E. Hall  
IN  
Cheese-man York COUNTY

District No. 15 Scale 5,000  
Surveyed by Charles J. Lewis  
N.B. K-3, 13  
CERTIFIED SURVEYOR

Recorded June 26, 1955  
W.D. Beyer, Clerk