

SUBDIVISION PLAT

OLD QUAKER ESTATES

SECTION FOUR

HENRY R. NICE, TRUSTEE, OWNER & DEVELOPER
LOCATED IN BRUTON MAGISTERIAL DIST.
YORK COUNTY, VA.

SCALE: 1" = 100' DATE: 7-29-65

E. E. PAINE, CONSULTING ENGINEER
NEWPORT NEWS, VA.

NOTE: MERIDIAN ESTABLISHED FROM SECTION 3, OLD QUAKER ESTATES

AREA OF LOTS = 97.2693 Ac.
AREA OF STREETS = 5.3560 Ac.
TOTAL AREA = 102.6253 Ac. (SURVEYED)
AREA OF MARSH = 4.6 Ac. (APPROXIMATE)
TOTAL AREA SECTION 4 = 107.2 Ac. ±

CURVE DATA						
CURVE	RADIUS	DELTA	ARC	TANGENT	CHORD	CHORD BEARING
1A	436.80	5° 15' 20"	40.07	20.05	40.05	S 43° 12' 30" W
1B	436.80	26° 29' 50"	202.00	102.84	200.20	S 27° 20' 10" W
1C	436.80	5° 54' 10"	45.00	22.52	44.98	S 11° 07' 40" W
2A	486.80	17° 47' 30"	151.16	76.19	150.55	N 36° 56' 30" E
2B	486.80	19° 51' 40"	168.77	85.23	167.89	N 18° 07' 05" E
3	268.48	27° 56' 00"	130.89	66.77	129.60	S 22° 06' 20" W
4	218.48	27° 56' 00"	106.52	54.34	105.46	N 22° 06' 20" E
5	73.25	73° 26' 00"	93.88	54.63	87.60	S 0° 38' 35" E
6	123.25	73° 26' 00"	157.96	91.92	147.37	N 0° 38' 35" W
7	354.80	29° 00' 20"	179.61	91.78	177.70	S 22° 51' 35" E
8	304.80	29° 00' 20"	154.30	78.84	152.66	N 22° 51' 35" W
9A	244.89	16° 19' 40"	69.79	35.13	69.55	S 0° 11' 20" E
9B	244.89	34° 23' 20"	146.98	75.78	144.79	S 25° 09' 55" W
10	194.89	50° 43' 10"	172.52	92.37	166.94	N 17° 00' 15" E
11A	323.40	19° 30' 30"	110.11	55.59	109.58	S 32° 36' 35" W
11B	323.40	15° 00' 10"	84.68	42.68	84.63	S 15° 20' 00" W
12A	373.40	18° 06' 20"	117.99	59.49	117.50	N 33° 18' 40" E
12B	373.40	16° 26' 40"	107.17	53.96	106.80	N 16° 02' 10" E
13	352.58	30° 30' 10"	187.69	96.12	185.48	S 7° 26' 10" E
14A	402.58	12° 50' 00"	90.17	45.27	90.00	N 1° 24' 00" E
14B	402.58	17° 40' 00"	124.13	62.56	123.63	N 13° 51' 10" W
15	25.00	41° 48' 40"	18.24	9.55	17.84	N 1° 46' 40" W
16	50.00	51° 03' 00"	44.55	23.88	43.09	N 2° 46' 50" E
17	50.00	44° 12' 40"	38.58	20.31	37.63	N 44° 50' 20" W
18	50.00	57° 37' 10"	50.28	27.50	48.19	S 84° 15' 35" W
19	50.00	57° 53' 00"	50.51	27.65	48.38	S 26° 30' 20" W
20	50.00	71° 21' 10"	62.27	35.90	58.32	S 38° 14' 45" E
21	25.00	41° 48' 40"	18.24	9.55	17.84	S 43° 35' 20" E
22	25.00	90° 03' 40"	39.30	25.00	35.42	S 22° 15' 50" W
23	25.00	89° 56' 20"	39.24	25.00	35.29	S 67° 43' 00" E
24A	123.62	26° 58' 20"	58.19	26.65	57.66	S 53° 46' 05" W
24B	123.62	63° 35' 40"	137.21	76.64	130.28	S 8° 28' 40" W
25	73.62	90° 34' 00"	116.39	74.36	104.64	N 21° 58' 00" E
26	200.77	67° 02' 50"	239.94	133.01	221.76	S 10° 12' 30" W
27A	250.77	16° 52' 40"	73.87	37.20	73.61	N 14° 52' 40" W
27B	250.77	31° 49' 40"	139.30	71.50	137.52	N 9° 28' 30" E
27C	250.77	18° 20' 20"	80.26	40.48	79.93	N 34° 33' 30" E

STATE OF VIRGINIA
City of Newport News
I, Henry R. Nice, A NOTARY PUBLIC,
DO HEREBY CERTIFY THAT THE PERSONS WHOSE
NAMES ARE SIGNED TO THE FOREGOING WRIT-
ING HAVE ACKNOWLEDGED THE SAME BEFORE
ME IN MY City AND STATE AFORESAID.
GIVEN UNDER MY HAND THIS 29th DAY OF July,
1965.
[Signature]
My Commission Expires 7/1/67

STATE OF VIRGINIA:
COUNTY OF YORK, TO WIT:
IN THE CLERKS OFFICE OF THE CIRCUIT COURT
FOR THE COUNTY OF YORK THE 2nd DAY OF
November, 1965 THIS MAP WAS PRESENTED
AND ADMITTED TO THE RECORD AS THE LAW
DIRECTS.
TESTE: Marionne J. Bryant, CLERK.
PLAT BOOK _____ PAGE _____

THIS SUBDIVISION PLAT IS WITH THE FREE CONSENT AND IN
ACCORDANCE WITH THE DESIRES AND WISHES OF THE UNDER-
SIGNED OWNERS AND PROPRIETORS
TITLE TO THE PROPERTY SHOWN HEREON IS VESTED IN
HENRY R. NICE, TRUSTEE, BY DEED FROM CLARENCE LEE AND IS
RECORDED IN DEED BOOK 162, PAGE 312, IN THE CLERKS OFFICE
OF THE CIRCUIT COURT OF YORK COUNTY, VIRGINIA.

Henry R. Nice Trustee

THIS IS TO CERTIFY THAT TO THE BEST OF MY KNOWLEDGE AND BELIEF,
THE SURVEY AND PLATS SHOWN HEREIN ARE CORRECT.
R. M. Blackstock 7/29/65
CERTIFIED LAND SURVEYOR DATE

VICINITY MAP

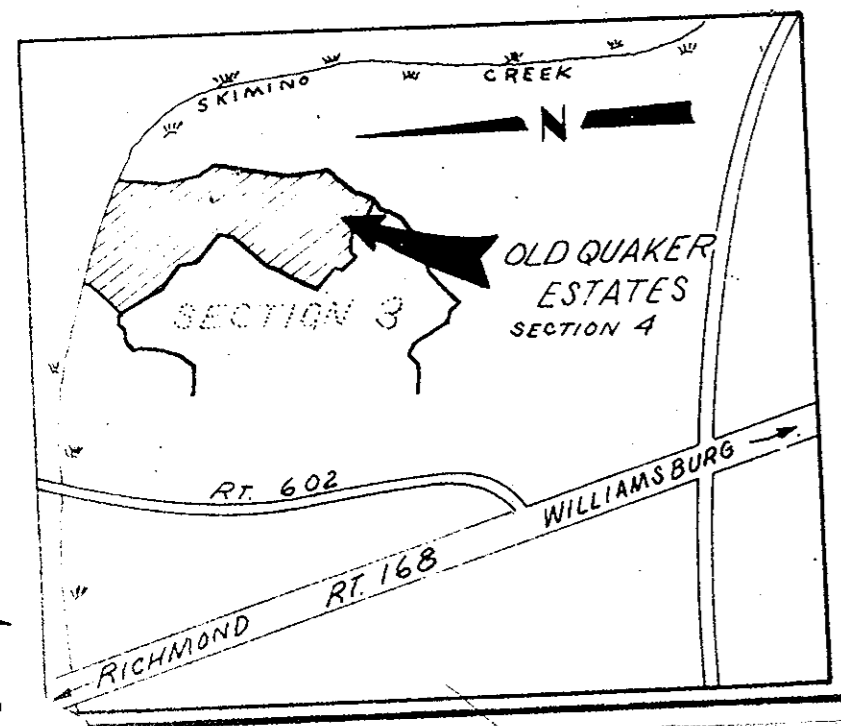

APPROVED

YORK COUNTY BOARD OF SUPERVISORS

BY William J. Barrett

PLAT APPROVING AGENT.

DATE 11-1-65

VARIATIONS APPROVED

DATE _____