

Filed in the Clerk's Office, Circuit Court, York Co., Va.  
the 3<sup>rd</sup> day of March 1986  
Teste: 9:54

Edith M. Edgett, Clerk  
*Lynn Seal* D.C.  
Page 215

THE WILLIAMSBURG COMMUNITY  
HOSPITAL, INC. DB 435P. 314  
**LOT C-2**

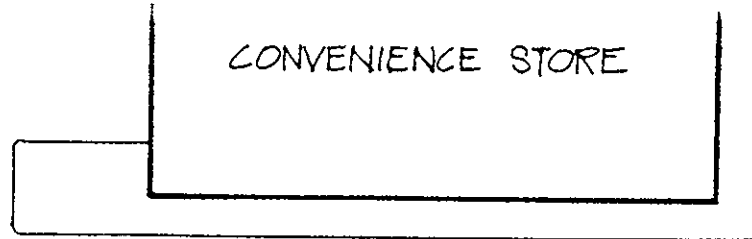

**EAST COAST OIL CORP**  
**LOT C-1**  
395 2nd ST.

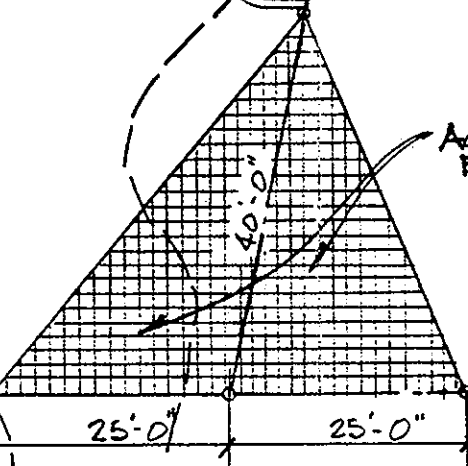
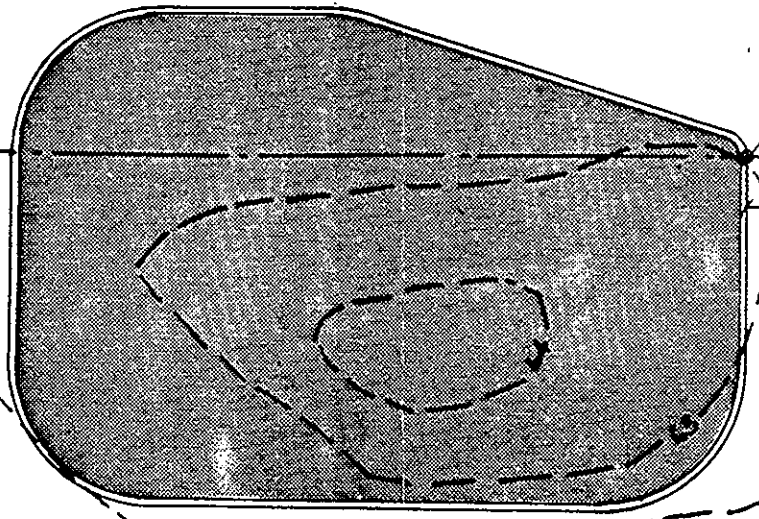
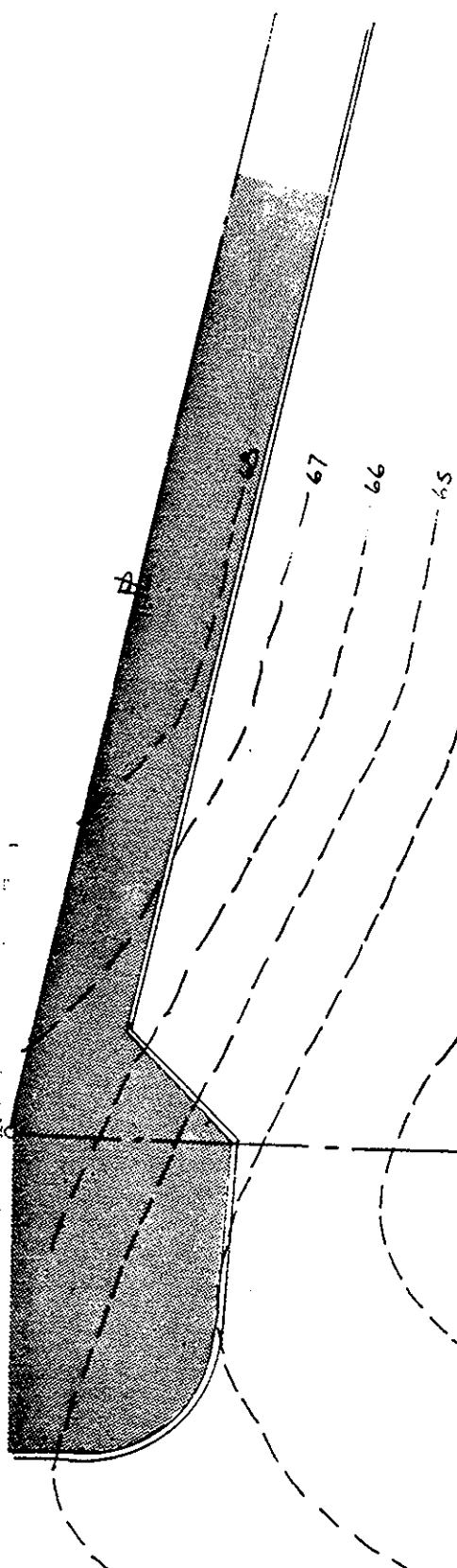
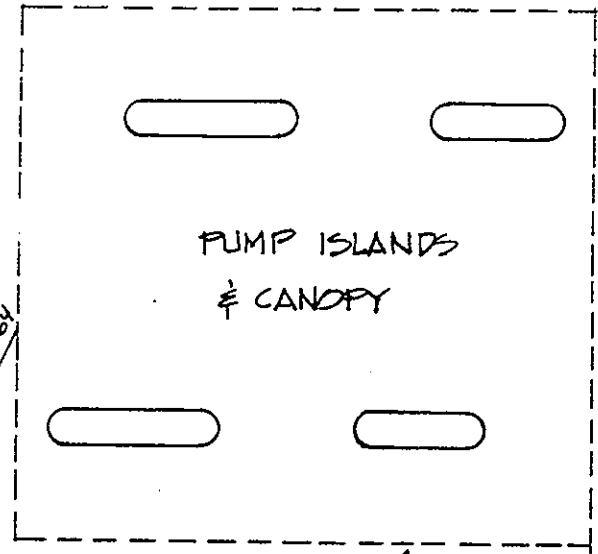

ACCESS EASEMENT

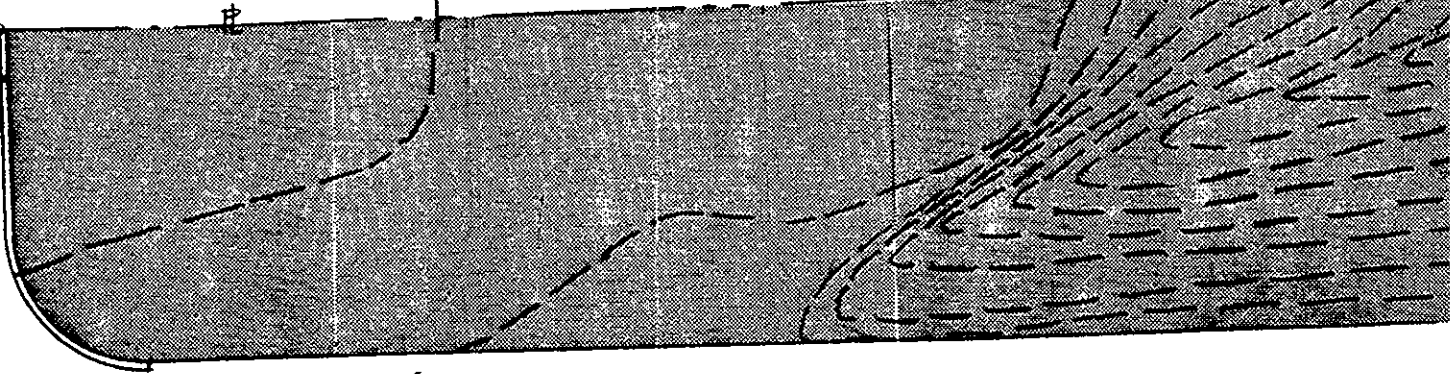

SECOND STREET — STATE ROUTE 162  
YORK COUNTY, VA. JAN. 8, 1986

LAYOUT OF SHARED  
ENTRANCE BETWEEN  
LOTS C-1 & C-2

**EXHIBIT A**