

SUBDIVISION
OF
RUNNING MAN
SECTION THREE-B
BETHEL MAGISTERIAL DISTRICT
YORK COUNTY, VIRGINIA

MAY 15, 1986

BALDWIN AND GREGG, LTD.
ENGINEERS • SURVEYORS • PLANNERS
NORFOLK, VIRGINIA

THIS SUBDIVISION IS WITH FREE CONSENT AND IN ACCORDANCE WITH THE DESIRES OF THE UNDERSIGNED OWNERS, PROPRIETORS, AND TRUSTEES, IF ANY.

RUNNING MAN DEVELOPMENT COMPANY, A VIRGINIA LIMITED PARTNERSHIP BY HARRISON AND LEAR, INCORPORATED, SOLE GENERAL PARTNER

BY: T.T. Thompson
T.T. THOMPSON, PRESIDENT

STATE OF VIRGINIA
COUNTY/CITY OF Hampton, TO WIT:
I, Peggy G. Lilley, A NOTARY PUBLIC IN AND FOR THE COUNTY OR CITY AFORESAID, DO HEREBY CERTIFY THAT T.T. THOMPSON, PRESIDENT OF HARRISON AND LEAR, INCORPORATED, WHOSE NAME IS SIGNED TO THE FOREGOING WRITING HAS ACKNOWLEDGED THE SAME BEFORE ME IN MY COUNTY/CITY AND STATE AFORESAID. GIVEN UNDER MY HAND THIS 22 DAY OF OCTOBER, 1986.

Peggy G. Lilley
NOTARY PUBLIC

MY COMMISSION EXPIRES June 23, 1989

TO THE BEST OF MY KNOWLEDGE AND BELIEF, ALL THE REQUIREMENTS AS SET FORTH IN ORDINANCE FOR APPROVING PLATS OF SUBDIVISIONS IN THE COUNTY OF YORK, VIRGINIA, HAVE BEEN COMPLIED WITH, INCLUDING A CLOSURE OF NOT LESS THAN 1'/10,000'.

THIS IS TO CERTIFY THAT THE LAND EMBRACED IN THIS SUBDIVISION IS IN THE NAME OF RUNNING MAN DEVELOPMENT COMPANY AND WAS ACQUIRED FROM RUNNING MAN LIMITED PARTNERSHIP BY DEED DATED JULY 22, 1983 AND DULY RECORDED IN THE CLERK'S OFFICE OF CIRCUIT COURT OF THE COUNTY OF YORK, VIRGINIA, IN DEED BOOK 381, PAGE 763.

I CERTIFY THAT MONUMENTS AS SHOWN ON THIS PLAT WILL BE SET ON OR BEFORE APRIL 1, 1987.

BALDWIN AND GREGG, LTD.

BY: Leroy P. Collins III

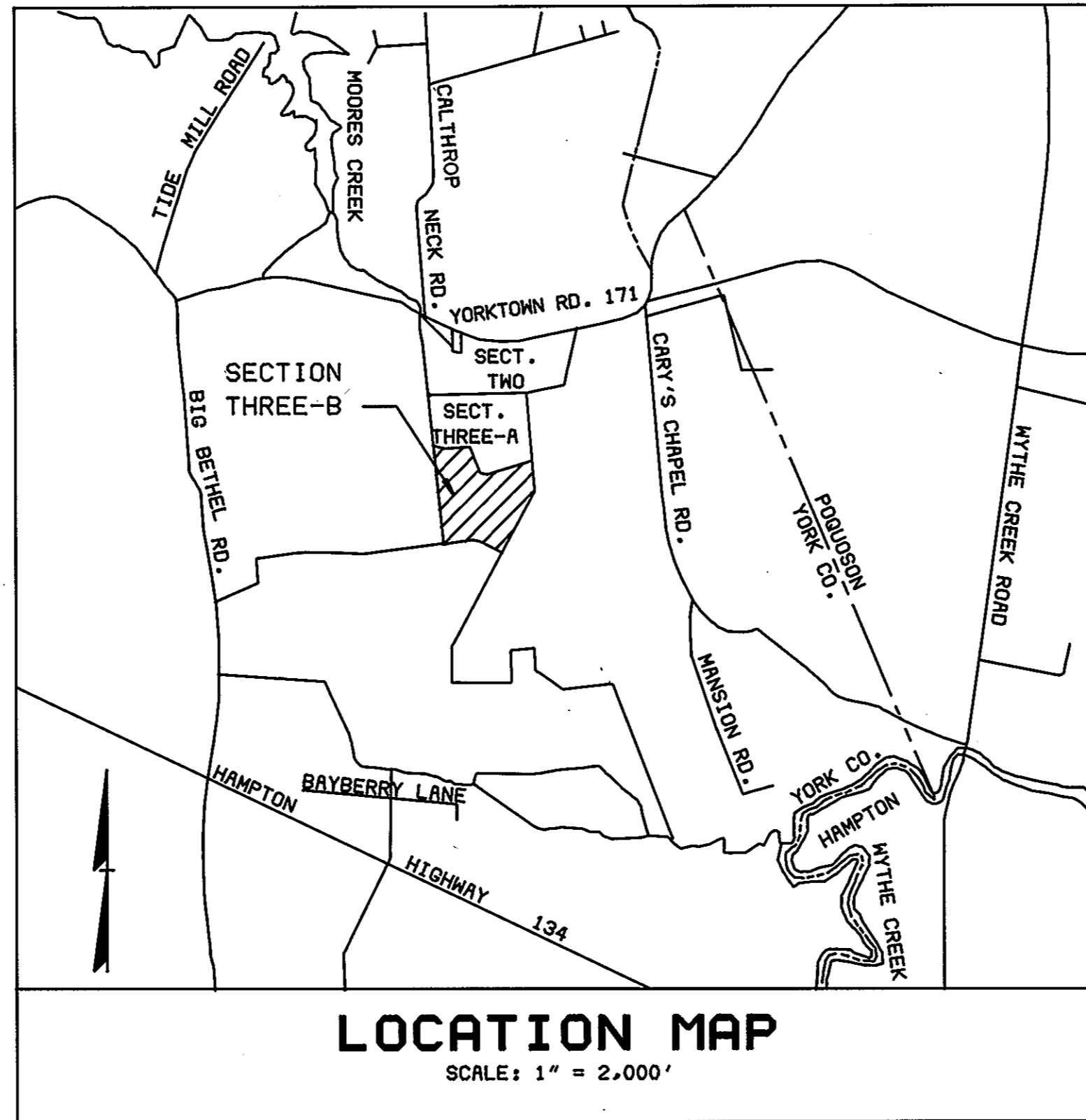
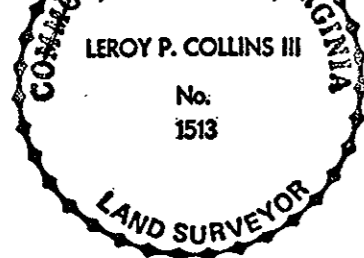

LOCATION MAP

SCALE: 1" = 2,000'

DEDICATION OF COMMON AREAS

RUNNING MAN DEVELOPMENT COMPANY IN RECORDING THE PLAT OF "SUBDIVISION OF RUNNING MAN, SECTION TWO" IN PLAT BOOK 10, PAGES 1 AND 2, DESIGNATED CERTAIN AREAS OF LAND AS COMMON AREAS INTENDED FOR USE BY THE HOMEOWNERS IN THE SUBDIVISION OF RUNNING MAN (PRESENT AND FUTURE SECTIONS) FOR RECREATION AND OTHER RELATED ACTIVITIES.

THE DESIGNATED AREAS WERE NOT DEDICATED FOR USE BY THE GENERAL PUBLIC BUT WERE DEDICATED TO THE COMMON USE AND ENJOYMENT OF THE HOMEOWNERS IN RUNNING MAN SUBDIVISION AS MORE FULLY PROVIDED IN THE SUPPLEMENTARY DECLARATION OF COVENANTS, CONDITIONS AND RESTRICTIONS APPLICABLE TO SUBDIVISION OF RUNNING MAN, SECTION THREE-B DATED THE 1ST DAY OF OCTOBER, 1986. SAID SUPPLEMENTARY DECLARATION OF COVENANTS, CONDITIONS AND RESTRICTIONS IS HEREBY INCORPORATED AND MADE A PART OF THIS PLAT.

COMMON AREA PARCELS "A" AND "B" AND 7.5' EASEMENTS ALONG LOT 1, BLOCK T, AND LOTS 1 AND 38, BLOCK X, SHOWN ON THE PLAT OF SECTION TWO WERE CONVEYED TO RUNNING MAN COMMUNITY ASSOCIATION, INC.

AREA WITHIN LOTS	22.531 ACRES
AREA WITHIN RIGHT OF WAY	5.810 ACRES
TOTAL SUBDIVIDED AREA	28.341 ACRES

LEGEND:

- CONCRETE MONUMENTS SHOWN THUS R/W
- EASEMENTS SHOWN THUS ARE HEREBY CONVEYED TO THE COUNTY OF YORK FOR DRAINAGE AND UTILITIES. 10' EASEMENT
- MINIMUM BUILDING SETBACK LINE SHOWN THUS. 30' R/W

UTILITY NOTES:

- WATER: EACH LOT WITHIN THE SUBDIVISION IS SERVED BY PUBLIC WATER PROVIDED BY CITY OF NEWPORT NEWS, VA.
- SEWER: EACH LOT WITHIN THIS SUBDIVISION IS SERVED BY PUBLIC SEWER PROVIDED BY YORK COUNTY, VA.

APPROVED:
YORK COUNTY BOARD OF SUPERVISORS

BY: [Signature]
PLAT APPROVING AGENT

DATE: 11/2/86

STATE OF VIRGINIA
COUNTY OF YORK
IN THE CLERK'S OFFICE OF THE CIRCUIT COURT FOR THE COUNTY OF YORK THE 22 DAY OF Nov., 1986, THIS MAP WAS PRESENTED, AND ADMITTED TO RECORD AS THE LAW DIRECTS IN PLAT BOOK 10, PAGE 302.

TESTE: Elizabeth M. Elliott
CLERK

BY: Nancy Stoney OC.

DB 459 page 826